



# Sound Transit East Link light rail

Mercer Island  
Preliminary Engineering  
Workshop

March 9, 2010

# Agenda

- Opening Presentation - 6:00 p.m.
  - I. Meeting Purpose (Katie Kuciemba)
  - II. Project Status Update (Paul Cornish)
  - III. East Link Preferred Alternative (Paul Cornish)
  - IV. Key Features for Mercer Island (Paul Cornish)
  - V. Workshop Format Overview (Katie Kuciemba)
- Workshop continues - 6:30 p.m.
- Adjourn - 7:30 p.m.

# Arriving at the Preferred Alternative

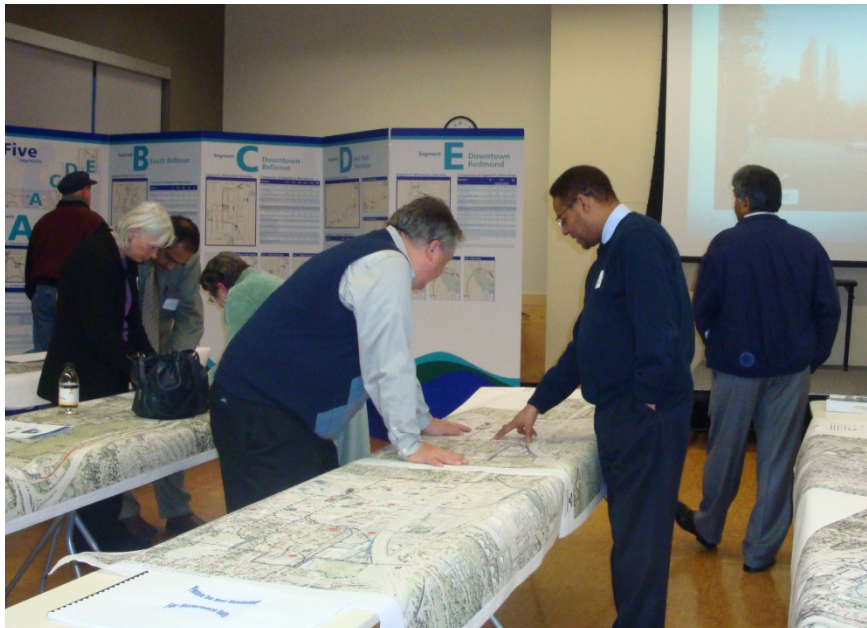

*Mercer Island Open House*

- Sound Transit published the Draft Environmental Impact Statement (EIS) on December 12, 2008
- Hosted five public hearings in Seattle, Mercer Island, Bellevue and Redmond
- Draft EIS public comment period
  - Mercer Island Light Rail Station Design Principles
- Preferred alternative identified by Sound Transit Board of Directors in May 2009

# What's happening with East Link?



- Designing the East Link preferred alternative, including modifications recommended by the Sound Transit Board.
  - Preliminary engineering phase
- Collecting survey/geotechnical information
- Ongoing coordination with Mercer Island's Police, Planning, Transportation Department and City Council
- Preparing information for the Final Environmental Impact Statement

# East Link Timeline

EIS Scoping	Fall 2006
Prepare Draft EIS	2007-2008
ST2 Approved by Voters	November 2008
Identify Preferred Route Alternatives	May 2009
Preliminary Engineering/FEIS	2009-2010
Identify Single Downtown Bellevue Preferred Alternative	April 2010
ST Board Selects Final Project	Early 2011
Final Design	2011-2013
Construction Starts	2013/2014
Service Starts	2020/2021
Public Meetings and Outreach is Continuous	

# East Link Preferred Alternative



# Seattle & Mercer Island



- Light rail will run on the existing I-90 center roadway
- Stations: Rainier Avenue in Seattle and Mercer Island
- New HOV lanes will be constructed on the I-90 outer roadways

## At completion of East Link

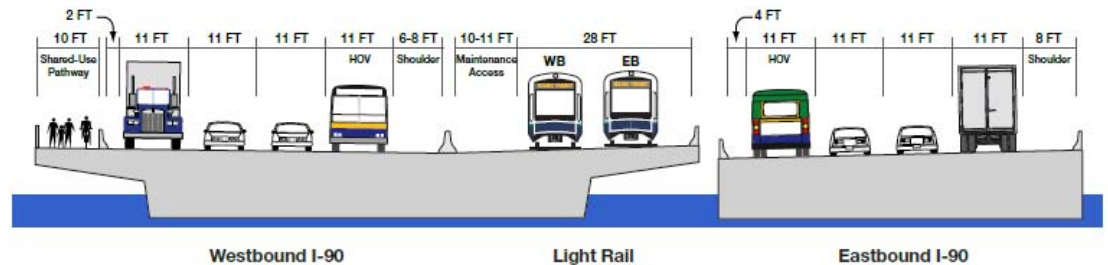

# South Bellevue

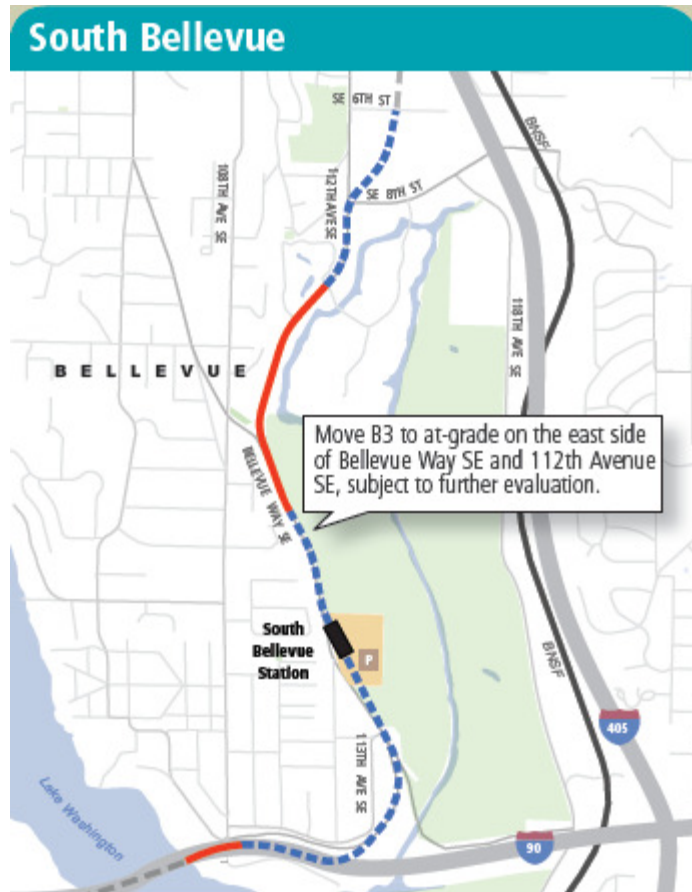

- Trains will run from I-90 north along Bellevue Way SE and 112th Ave. SE
  - Subject to further evaluation, the route will be on the east side of Bellevue Way and 112<sup>th</sup> Ave. SE
- South Bellevue Station with 1400 spaces and Park-and-Ride

# Downtown Bellevue

## Preferred Alternative (5/09) and Tunnel (Future Consideration)

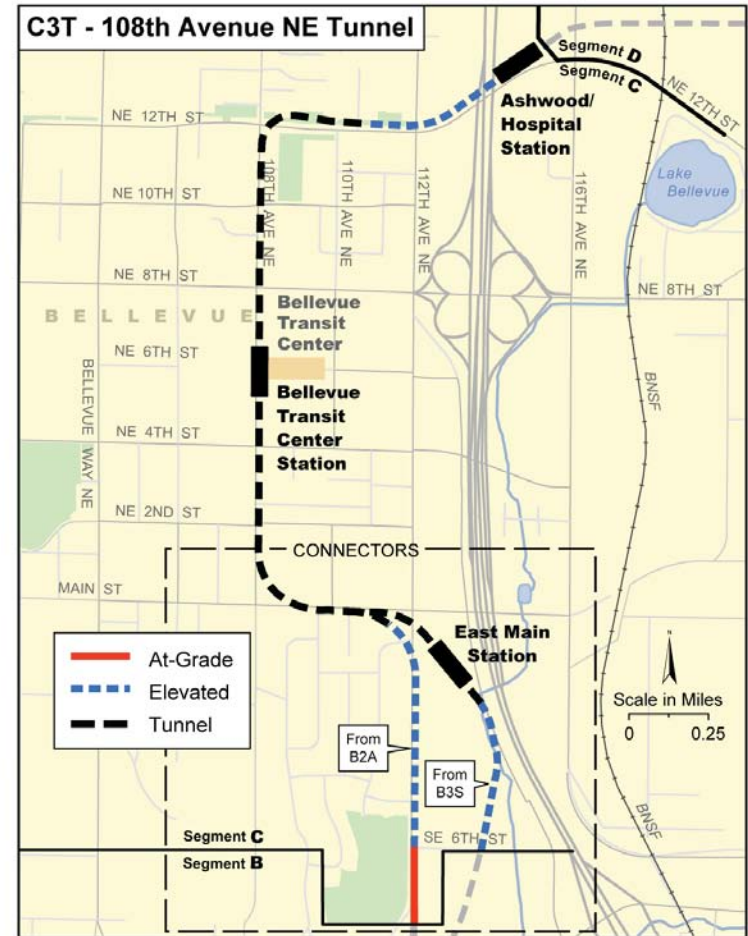
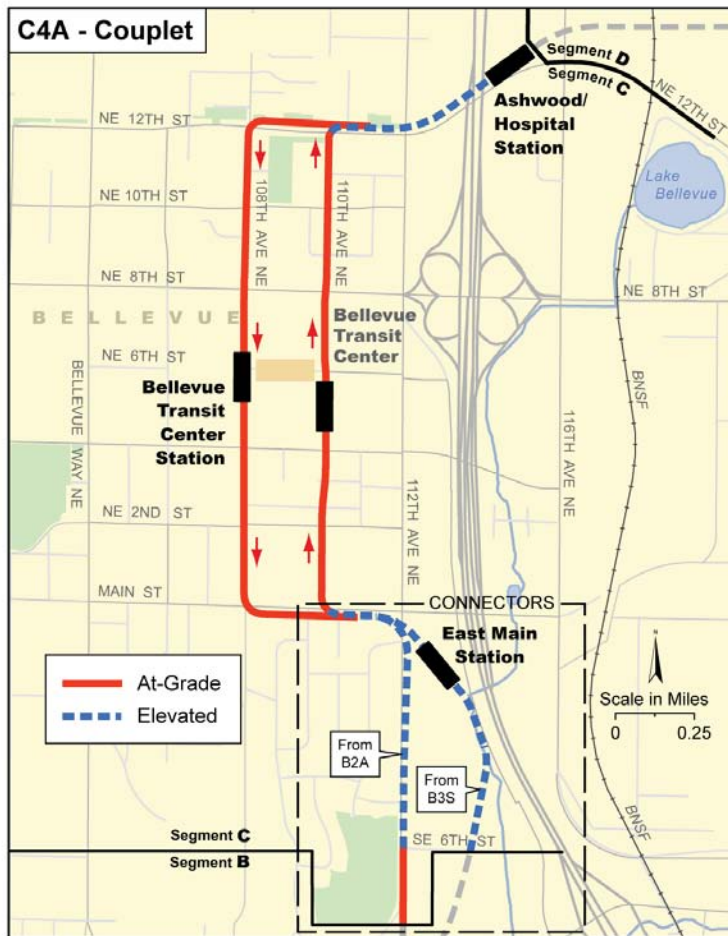

# Bel-Red/Overlake Corridor



- Trains will serve the Bel-Red corridor, Overlake Village and Microsoft's campus
- 3 – 4 stations
- Alignment shifts to north side of NE 24<sup>th</sup> Street

# Redmond



- Funding has not been approved for construction, however preliminary design and environmental study is funded
- Future route along State Route 520 and northern edge of Marymoor Park
- Stations: SE Redmond and terminal station near Redmond Town Center is under evaluation
- 1400 space Park-and-Ride

# Key Features for Mercer Island

- **Station Access**

- 77<sup>th</sup> Ave. SE
- 80<sup>th</sup> Ave. SE

- **Station Features**

- Pedestrian & Bike Facilities
- Passenger Amenities



# Mercer Island Station

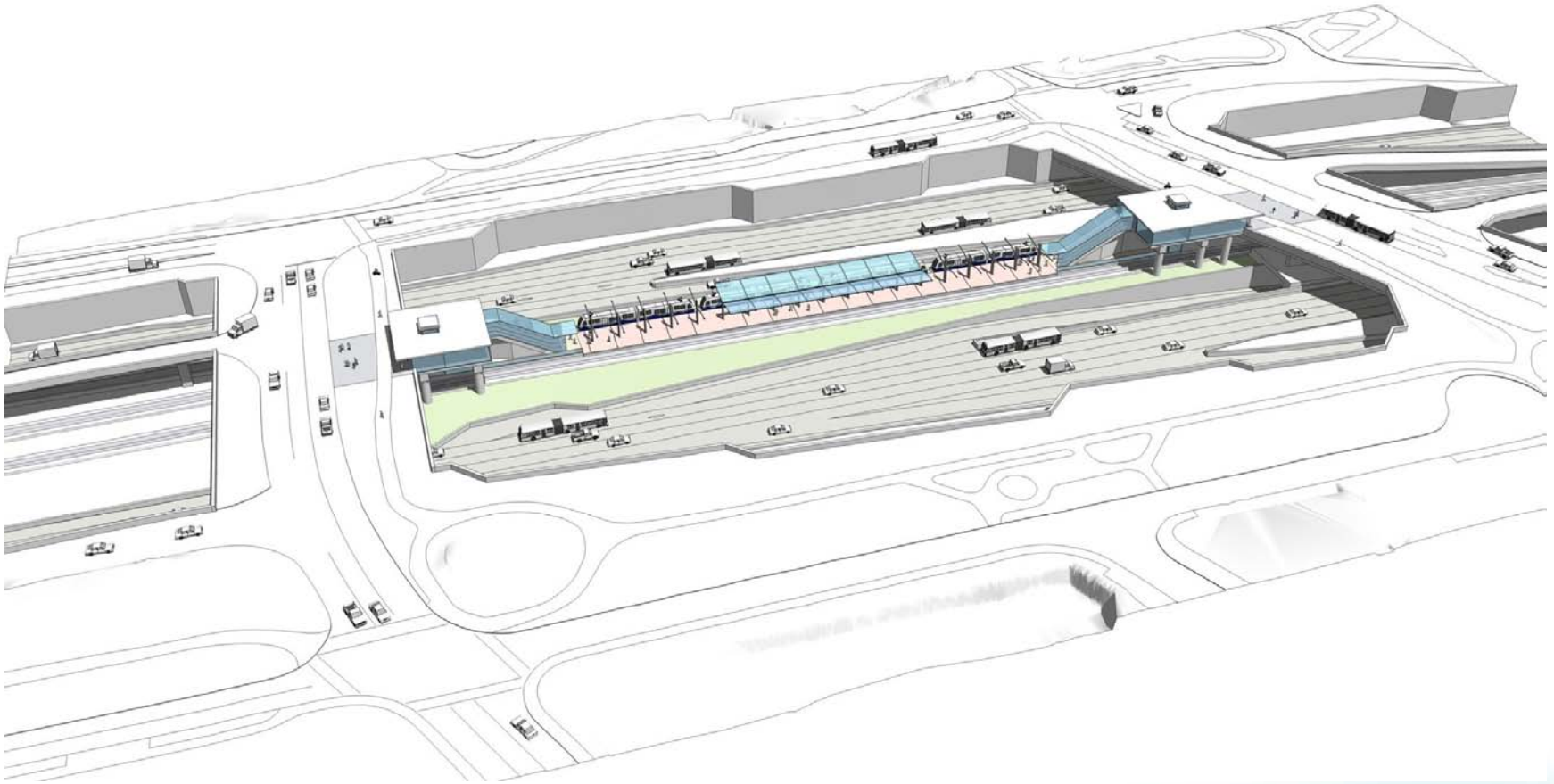

# We Want to Hear from You!

- Preliminary Engineering Public Meetings (March – May 2010)
- Community and stakeholder briefings (ongoing)
- Project update mailings (ongoing)
- E-mail and web site updates (ongoing)



# Questions?

Contact Katie Kuciemba,  
Community Outreach Specialist

206-398-5459 or

[eastlink@soundtransit.org](mailto:eastlink@soundtransit.org)