



# East Link Extension Seattle Final Design Open House

September 12, 2013

# Tonight's agenda

- 6-8 p.m. – Open house
  - Meet the team
  - View design plans
  - Tell us what you think!
- 6:30 – Presentation
  - Welcome and introductions (Luke Lamon)
  - East Link overview (Paul Cornish)
  - Station design update (David Hewitt)
  - STart (Mylinda Sneed)
  - Questions and comments
- 7:00 – Return to open house
- 8:00 - Close



# Link light rail system

- 16 miles of light rail with 13 stations currently in service
- University & S. 200<sup>th</sup> Link Extensions under construction; open 2016
- ST2 Plan funded extensions to Overlake, South King County, and Lynnwood
- 50+ mile system

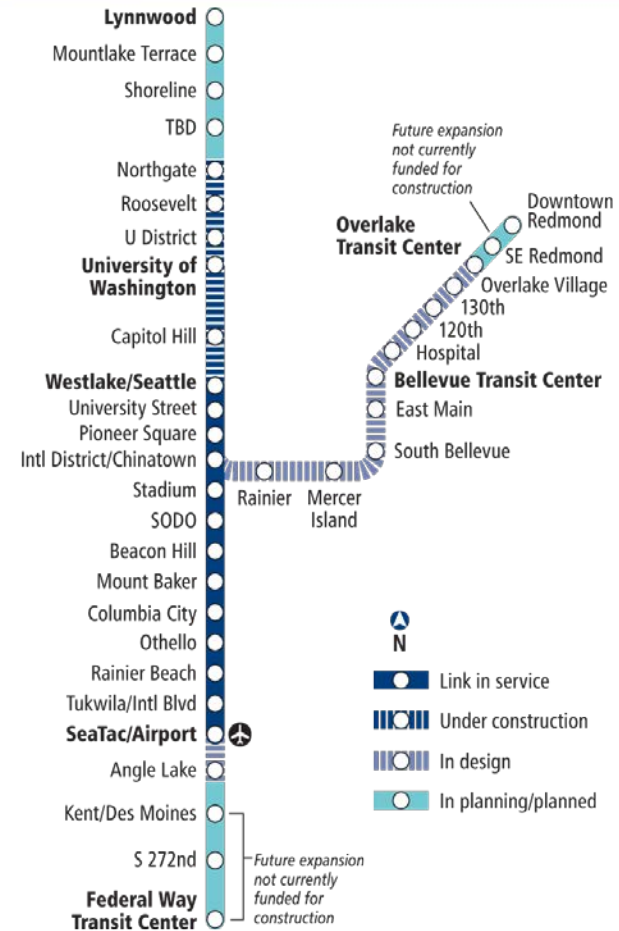

# East Link overview

Length: 14 miles

Rider projection: 50,000 daily by 2030

Start of Service: Targeted 2023

Rainier Station:

Ride Times:

- University of Washington- 15 mins
- Northgate-22 mins
- Overlake Transit Center- 26 mins

Rider Projections: 3,000 daily by 2030

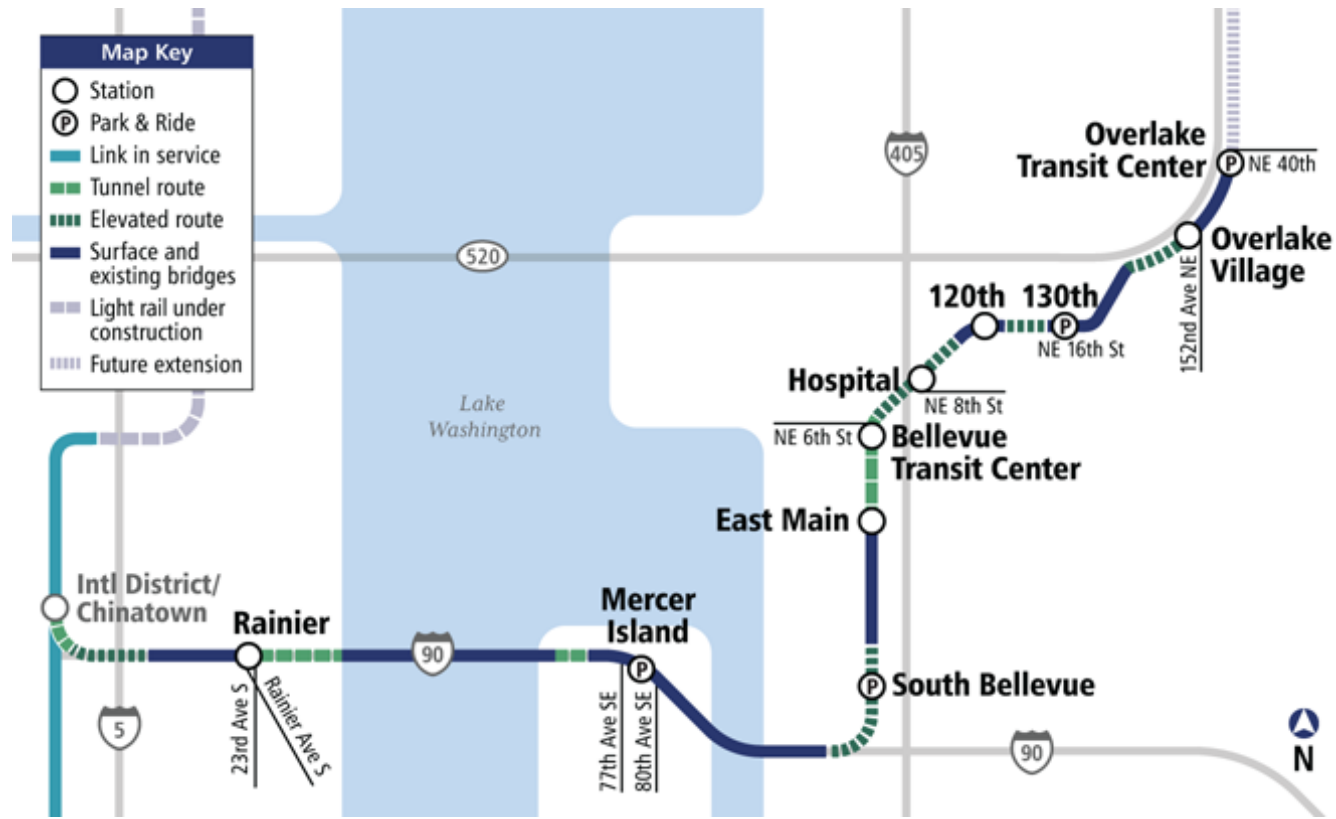

# What you can expect during final design

## Design milestones

Final design kick-off  
(Fall 2013)

60 percent design  
(First half of 2014)

90 percent design  
(Second half of 2014)

Start  
construction  
(targeted  
2015)

- Station design and naming outreach begins
- Lead Artist joins design team from *STart*
- Ancillary structures located

- Updated construction staging and sequencing plans developed
- Interagency coordination on concurrent planning and construction efforts
- Sound Transit Board identifies permanent station name



# Permanent station names

- Reflect the nature of the community and environment
- Succinct and easy to read
- Comply with federal Americans with Disabilities Act guidelines and limited to 30 characters
- Avoid commercial references
- Avoid similar names or words in existing facilities



**Comment on station names tonight!**

# Agency Coordination

Throughout the Final Design process, Sound Transit is working with the following agencies to enhance the safety and overall transit experience of the traveling public:

- FHWA
- WSDOT
- King County
- City of Seattle
- You



# Station Design Overview

Rainier Station





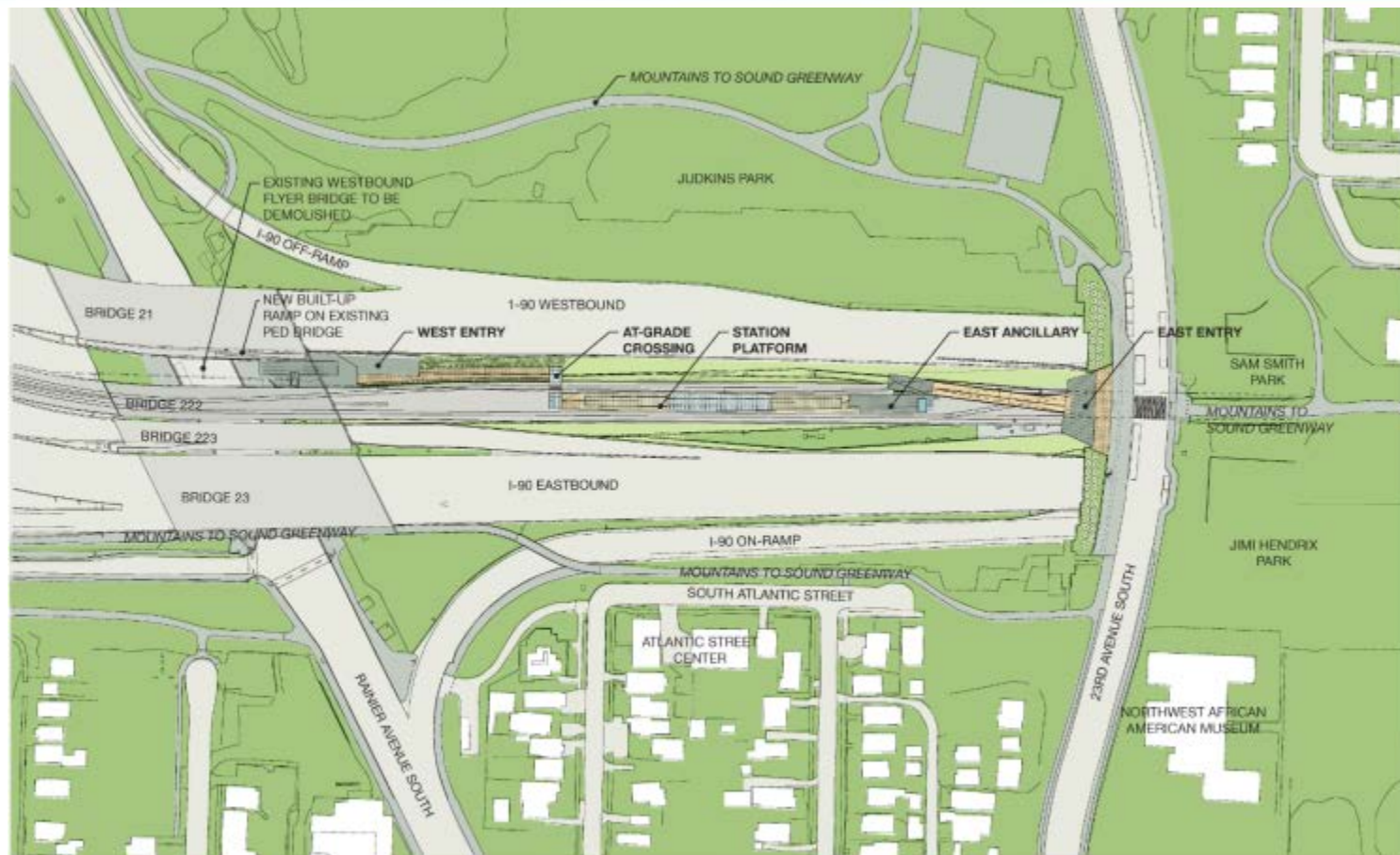

Station Site Plan



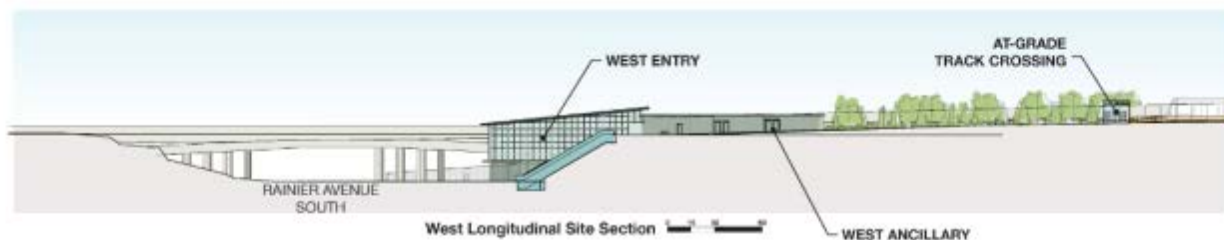
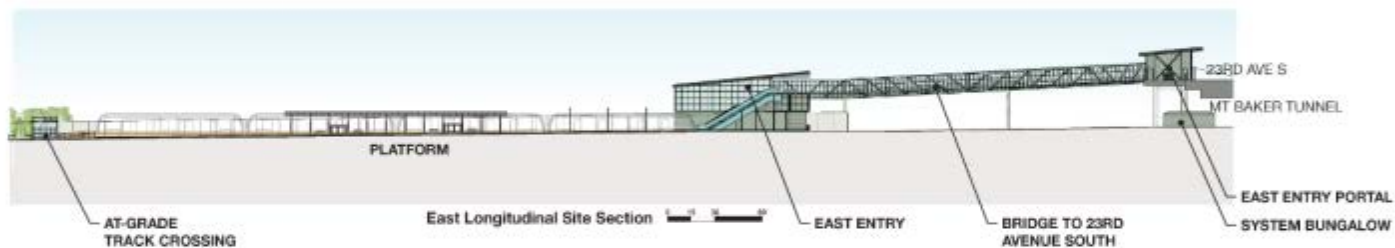
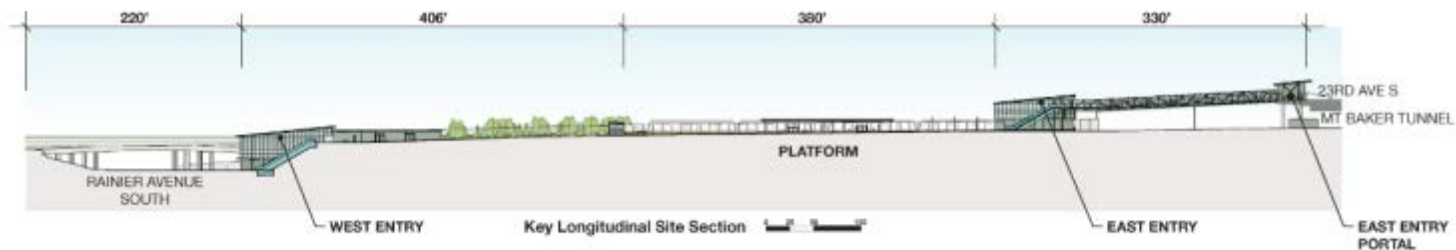

Longitudinal Sections

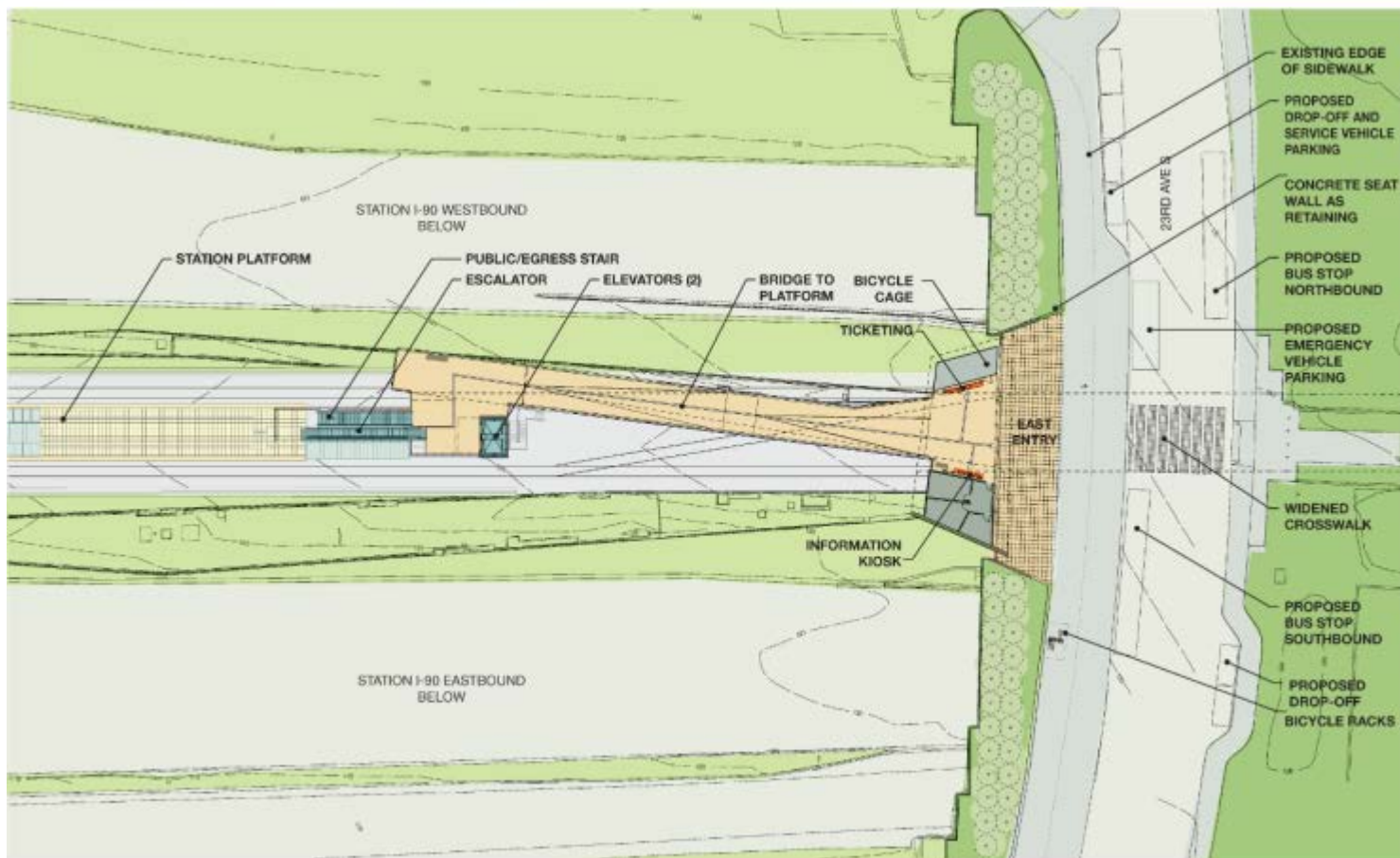

East Entry Overall Plans



East Entry Perspective from Sam Smith Park



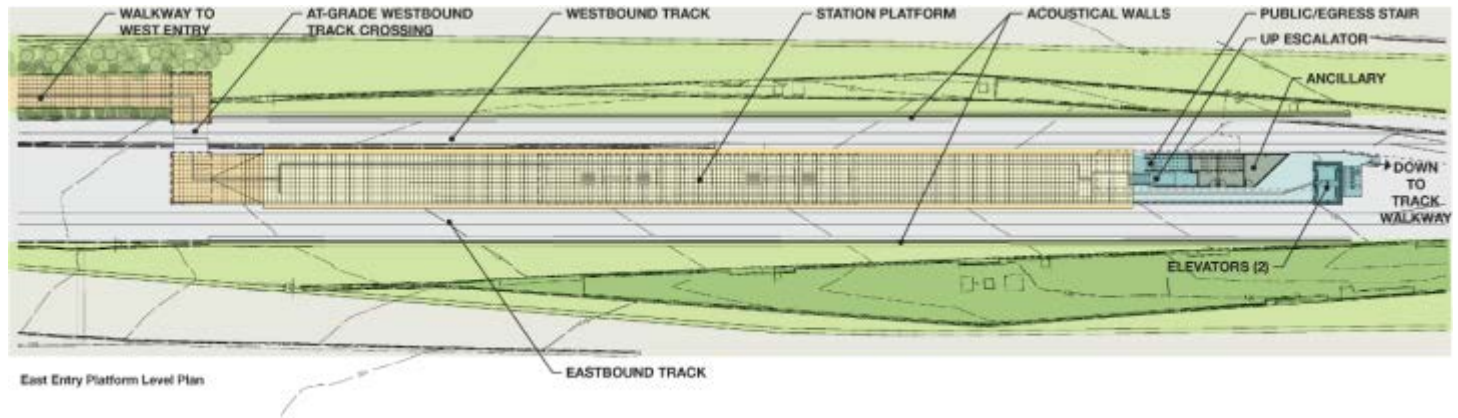

East Entry Platform Level Plan

East Entry







East Entry Perspective from Platform

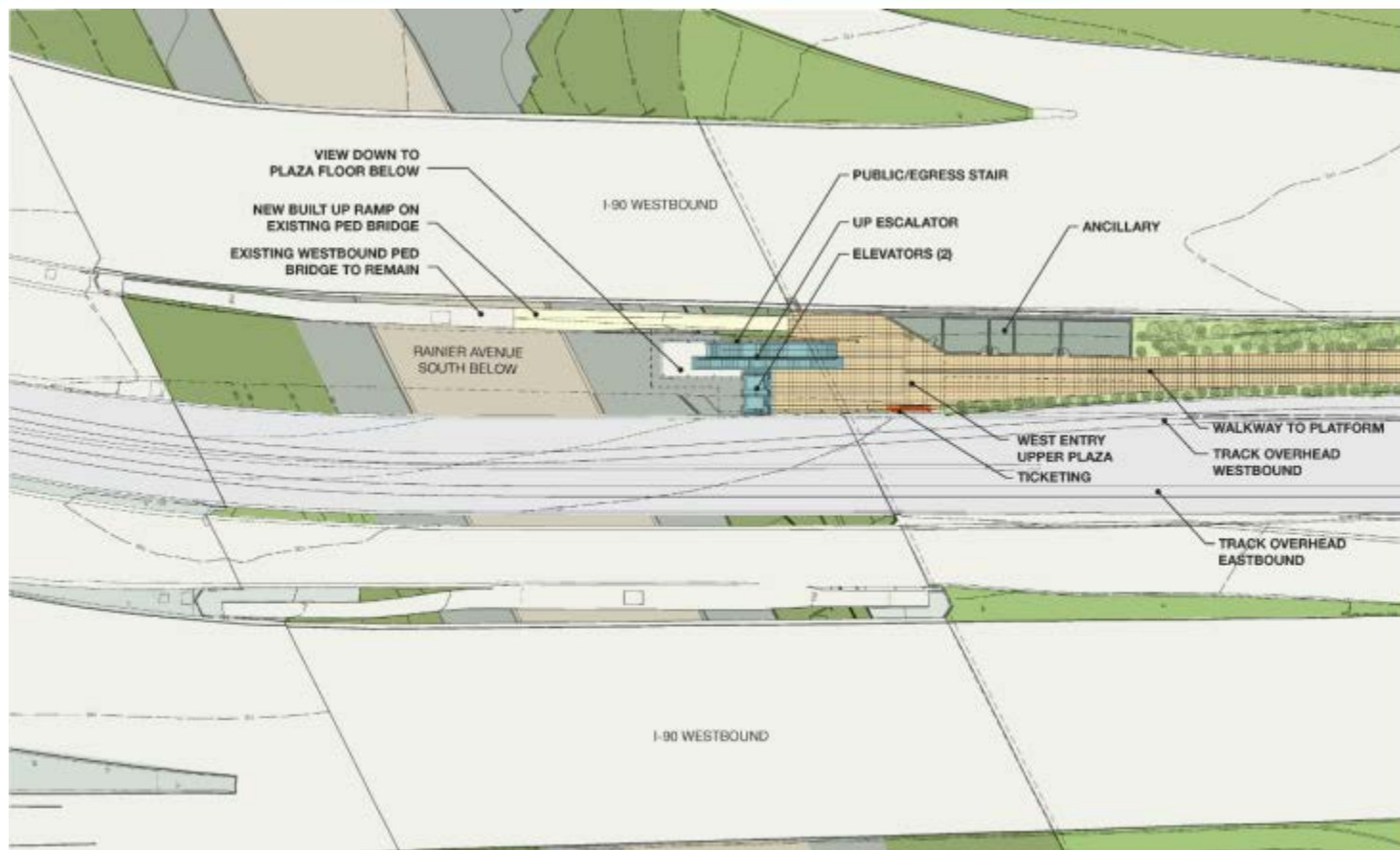

West Entry Upper Plaza Plan





West Entry Perspective from Track Crossing





West Entry Perspective from Upper Platform

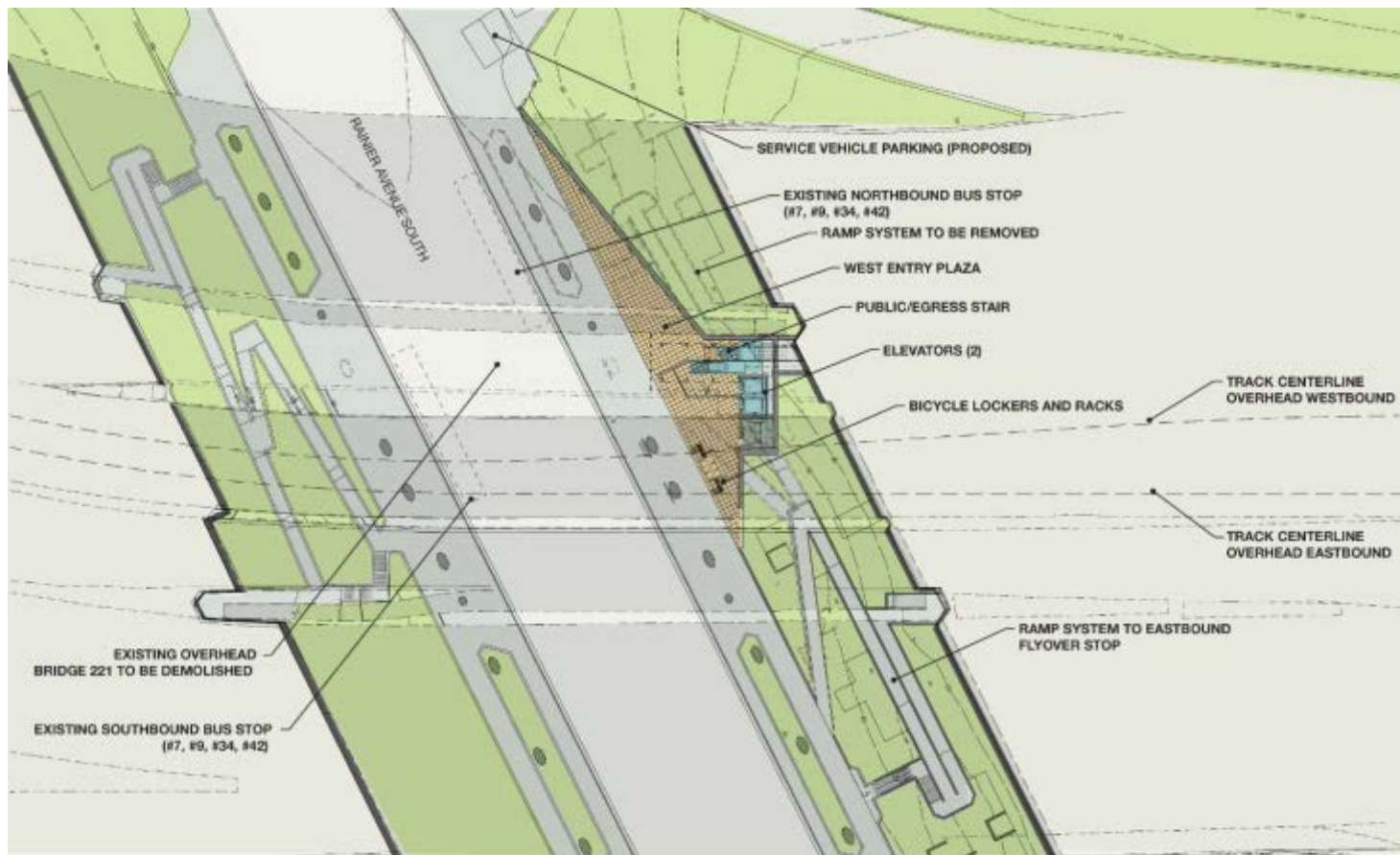

West Entry Lower Plaza Plan







West Entry Perspective from Rainier Avenue South

# *STart*

Sound Transit's Integrated Art Program



# STart on LINK

Sound Transit Art Program

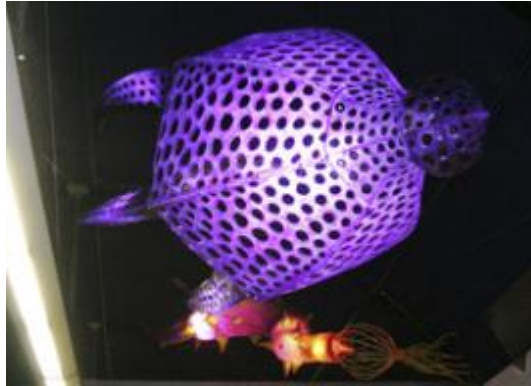

# Next steps

- Continue coordination with local jurisdictions and the public
- Station naming outreach
- Select station artists
- Advance design to 60% milestone

# We want to hear from you!

- Sound Transit Community Outreach staff is accessible by phone, email, and is available to meet in person
- Contact Community Outreach staff: [eastlink@soundtransit.org](mailto:eastlink@soundtransit.org) or 206-398-LINK
- Attend final design community meetings
- Sign-up to receive email updates: [www.soundtransit.org/subscribe](http://www.soundtransit.org/subscribe)
- Visit the project website: [www.soundtransit.org/eastlink](http://www.soundtransit.org/eastlink)



# Questions or Comments?

