



East Link light rail

Segment D: Bel-Red/Overlake Corridor

July 2011

Segment Details

In Segment D, trains will serve the Bel-Red corridor, Overlake Village and Microsoft's Overlake campus in a combination of elevated and at-grade alignments located north of Bel-Red Road. Sound Transit evaluated four alternatives between downtown Bellevue and the Overlake Transit Center in the Final Environmental Impact Statement (FEIS).

Preferred Alternative D2A travels parallel to and north of a new NE 15th Street corridor. From Segment C, it travels under 120th Avenue NE and 124th Avenue NE, continues at-grade on NE 16th Street, turns north at 136th Place NE, and crosses NE 20th Street, transitioning to an elevated structure along the south side of SR 520. It remains adjacent to SR 520 north of NE 24th Street, transitioning to an at-grade profile and continues along SR 520 until terminating at the Overlake Transit Center Station. Any station on the Preferred Alternative D2A route may serve as an interim terminus, which would include tracks beyond the station for storage and turnback operations. In addition, Preferred

Alternative D2A includes storage tracks located in the former BNSF Railway corridor north of the Segment C/D boundary.

Preferred Alternative D2A could include up to four stations. Stations would be located at:

- 120th Station: Located between 120th and 124th Avenues NE north of a new NE 15th roadway planned by the City of Bellevue.
- 130th Station: Located on NE 16th Street between 130th and 132nd Avenues NE and might include a park-and-ride lot with 300 parking spaces.
- Overlake Village Station: Adjacent to SR-520 just north of the Overlake Village Park-and-Ride.
- Overlake Transit Center Station: Located at the existing Overlake Transit Center but reconfigured to accommodate the new station and up to 320 cars.

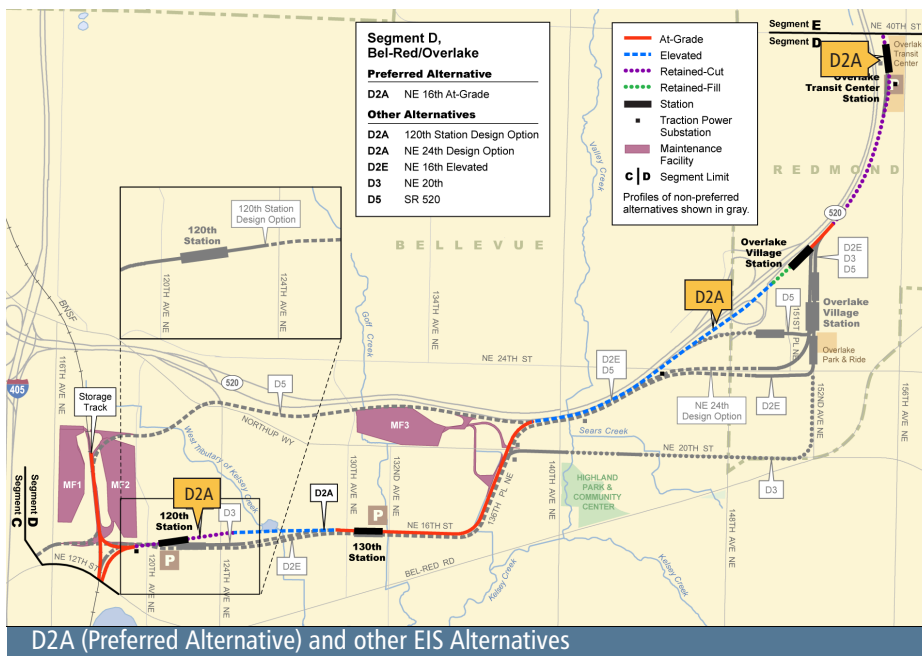

Travel times*

(from 130th Station)

- International District/Chinatown = 26-29 minutes
- University of Washington = 36-39 minutes
- Bellevue Transit Center = 16 minutes
- Overlake Transit Center = 6 minutes

* Reflects preferred alternative travel times

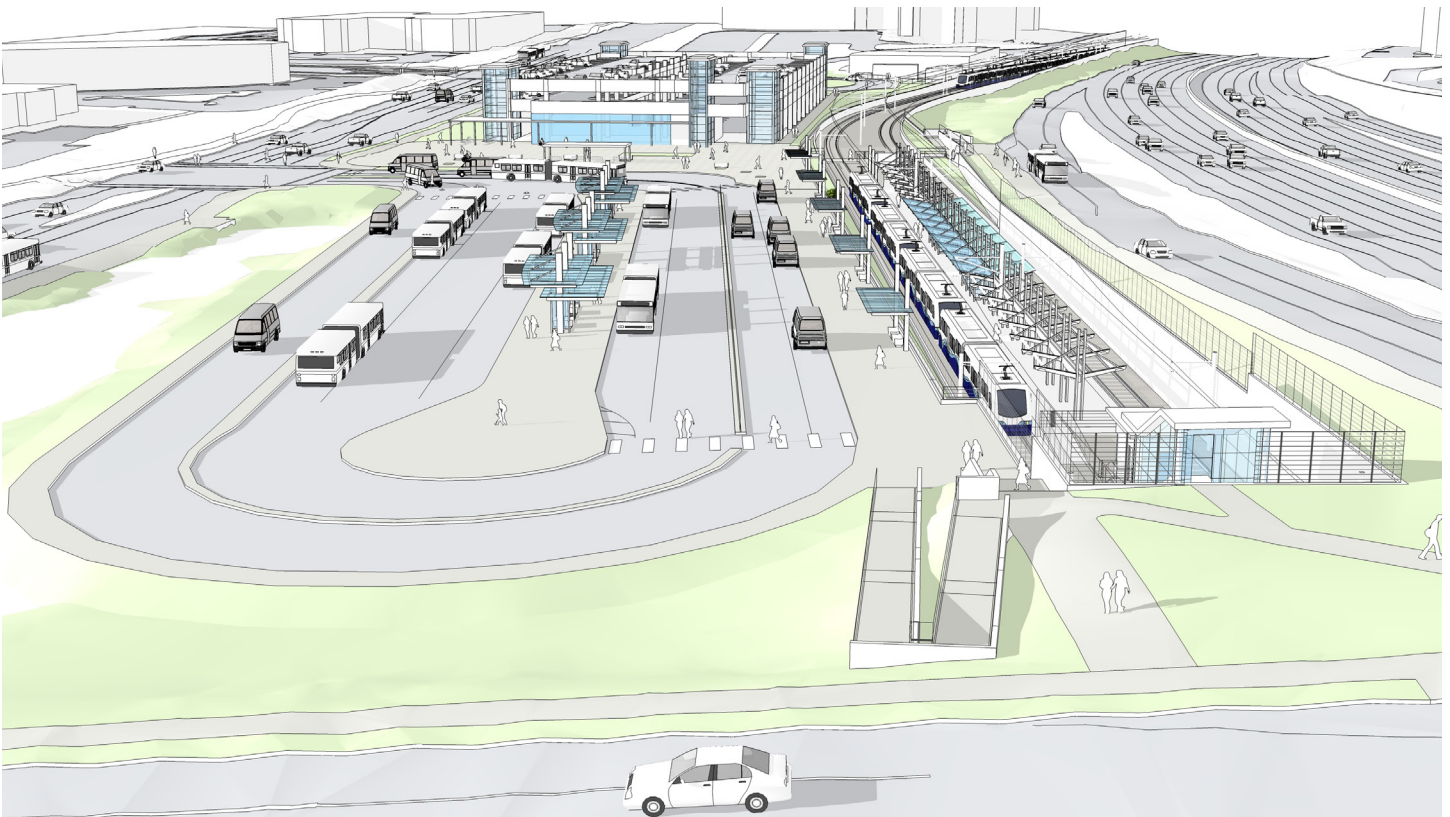

Simulation of the Overlake Transit Center

Benefits:

- Provides access to high quality, frequent transit service that operates 20 hours per day.
- Approximately 7,000 daily boardings would occur in this area.
- Supports the dense, transit-oriented land use redevelopment plans of Bellevue and Redmond.
- Will accommodate future growth and planned transportation improvements in the Bel-Red Corridor and Overlake Neighborhood.
- The light rail preferred alternative in this area could serve up to four stations, provide new park-and-ride access for the Bel-Red corridor and have additional parking spaces near the Overlake Transit Center.
- Light rail in this area would complement existing transit services at Overlake Village Park-and-Ride and the Microsoft Connector service.

For more information:

Project Web page:

www.soundtransit.org/eastlink

Contact:

Emily Mannetti

Sound Transit Community Outreach Coordinator

206-398-5438 • Eastlink@SoundTransit.org