

OVERLAKE DESIGN UPDATE AND CONSTRUCTION KICKOFF OPEN HOUSE

EAST LINK EXTENSION

The purpose of tonight's meeting is to provide:

- Opportunity for members of the public to receive an update on design and learn more about construction before it begins
- An overview of the project schedule, *STart*, and a timeline for the start of construction and closure of the Overlake Transit Center park-and-ride
- Provide an opportunity for members of the public to speak with project staff



Agenda

5-7 p.m. Open House

Meet with project staff and view display boards and graphics featuring information about design of the Overlake Village and Redmond Technology Center stations.

5:30 p.m. Overview presentation

7:00 p.m. Meeting adjourns



LIGHT RAIL ALIGNMENT

EAST LINK EXTENSION



Length: 14 miles

Ride times:

- Mercer Island to University of Washington: 20 minutes
- South Bellevue to Sea-Tac Airport: 50 minutes
- Overlake Transit Center to Bellevue Transit Center: 10 minutes

Rider projection: About 50,000 riders will use East Link every day by 2030

Start of service: Targeted 2023

2006-2011

Planning and environmental review

2011-2015

Pre-final design

2015-2022

Design-build (we are here)

Targeted 2022

Testing & pre-operations

Targeted 2023

East Link in service



OVERLAKE STATIONS IN REDMOND OVERVIEW

EAST LINK EXTENSION

Benefits:

- Provides access to high quality, frequent transit service that operates 20 hours per day.
- Supports the City of Redmond's land use and transportation plan for Overlake
- Accommodates future growth and planned transportation improvements
- Light rail will serve two stations and provide increased park-and-ride capacity at the Redmond Technology Center Station
- A pedestrian and bicycle bridge at the Overlake Village Station, funded by the City of Redmond, will span SR 520 to connect light rail to the surrounding community
- Pending a Microsoft funding agreement, a pedestrian and bicycle bridge across SR 520 will provide an additional connection for the Microsoft campus across the freeway to light rail, Connector and bus service.



Travel times (from Redmond Technology Center Station)

- International District/Chinatown: 30 minutes
- University of Washington: 40 minutes
- Bellevue Transit Center: 10 minutes
- Sea-Tac Airport: 64 minutes (with transfer at International District/Chinatown)

NOV 2016



GOOD NEIGHBOR COMMITMENTS

EAST LINK EXTENSION

Sound Transit is committed to being a good neighbor by minimizing the impacts of our construction.

- Provide advanced notification for work
- Maintain driveway access and keep traffic moving
- Maintain a clean work site
- Minimize noise, dust and debris
- Provide wayfinding and signage
- 24-hour construction hotline



Stay informed during construction:

Subscribe to the Overlake in Redmond email list at soundtransit.org/subscribe



NOV 2016



OVERLAKE VILLAGE STATION

EAST LINK EXTENSION

Platform and grade level plans of westbound track



City of Redmond bicycle/pedestrian bridge concept



NOV 2016

OVERLAKE VILLAGE STATION

EAST LINK EXTENSION

Landscape plan



View from platform looking southwest

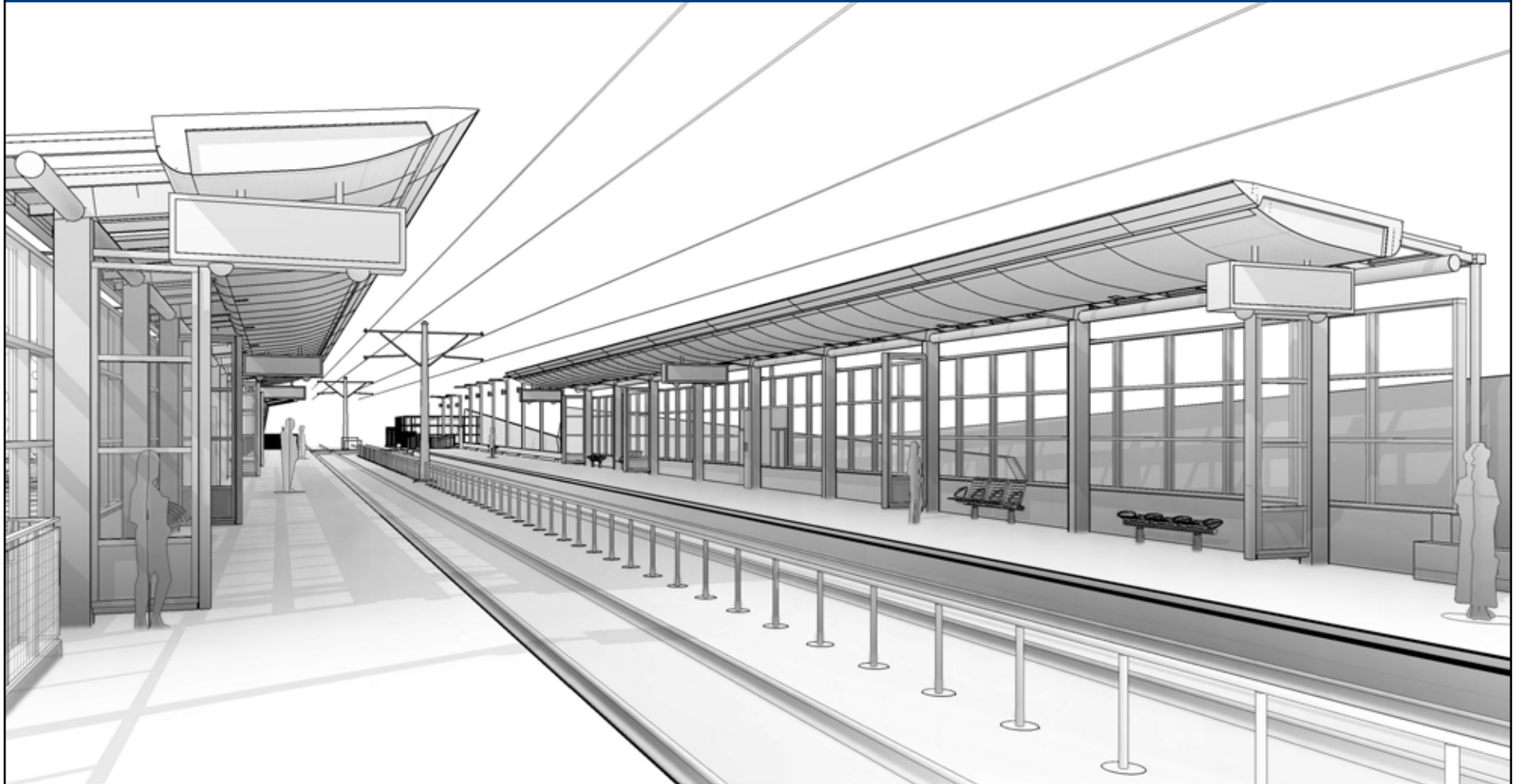

NOV 2016

OVERLAKE VILLAGE STATION

EAST LINK EXTENSION

View of plaza and pedestrian "paperclip"

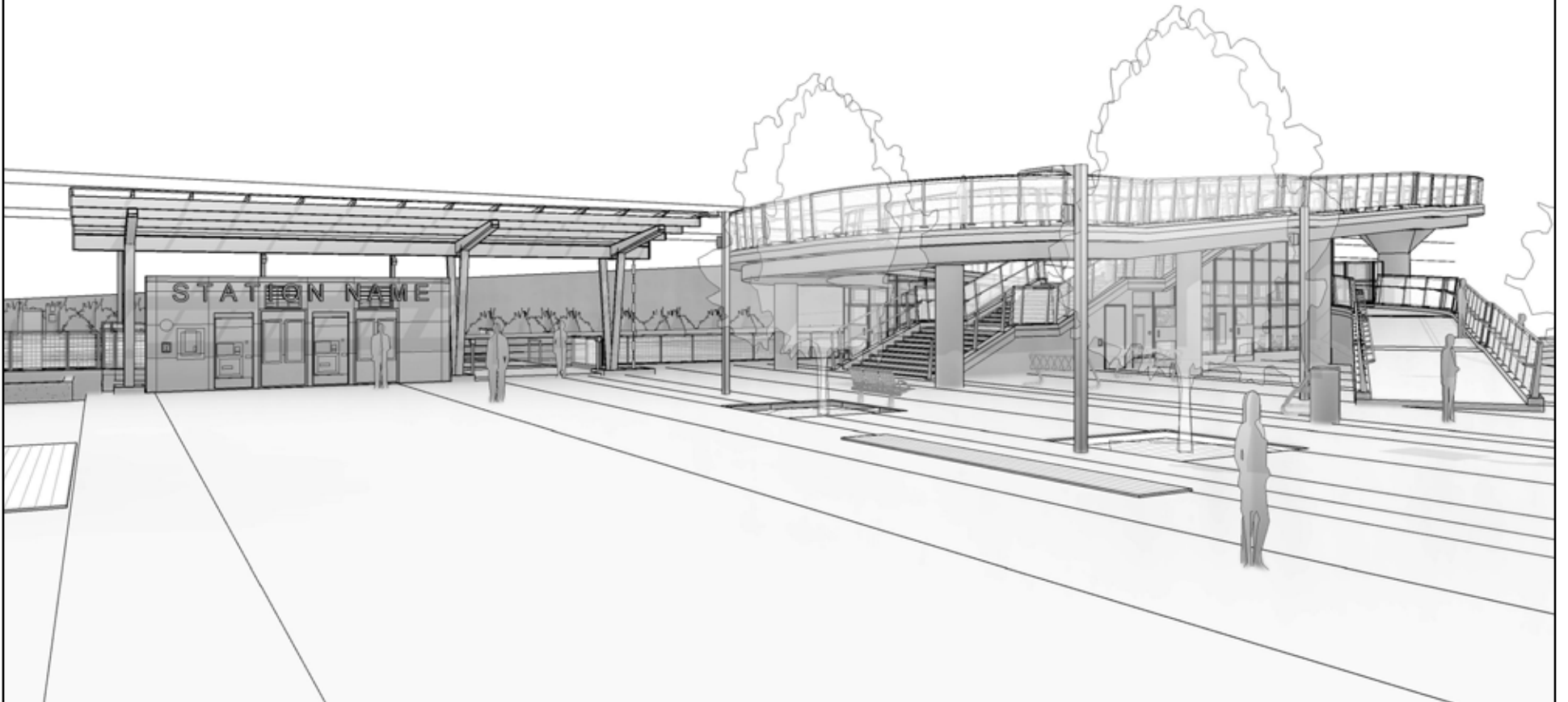

View from plaza to platform



NOV 2016

REDMOND TECHNOLOGY CENTER STATION

EAST LINK EXTENSION

Master development plan



Site plan



NOV 2016

REDMOND TECHNOLOGY CENTER STATION

EAST LINK EXTENSION

Bird's eye view



View from platform looking south

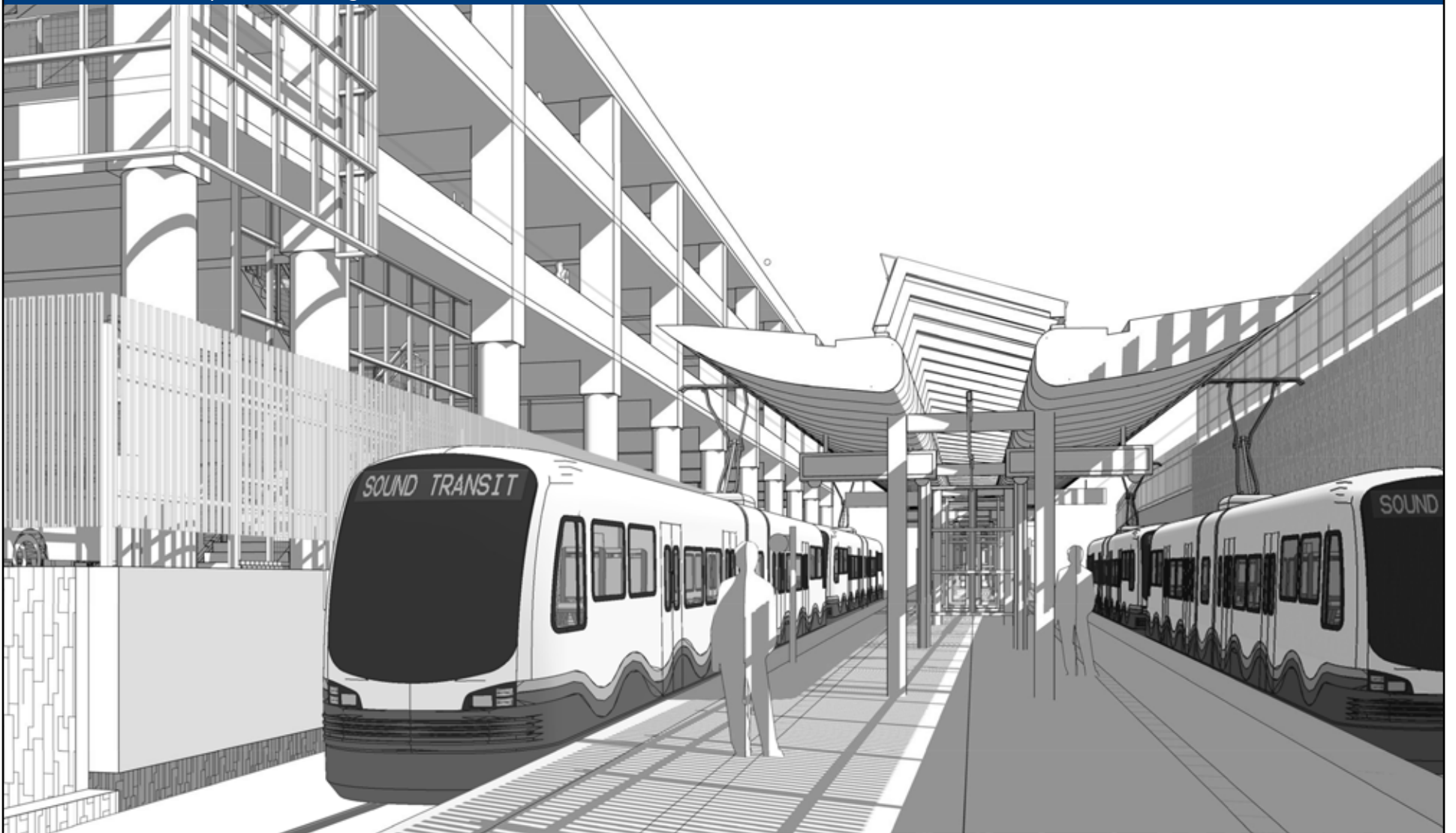

NOV 2016

REDMOND TECHNOLOGY CENTER STATION

EAST LINK EXTENSION

View from platform looking north



Bus loop

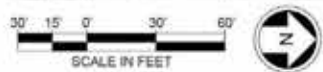
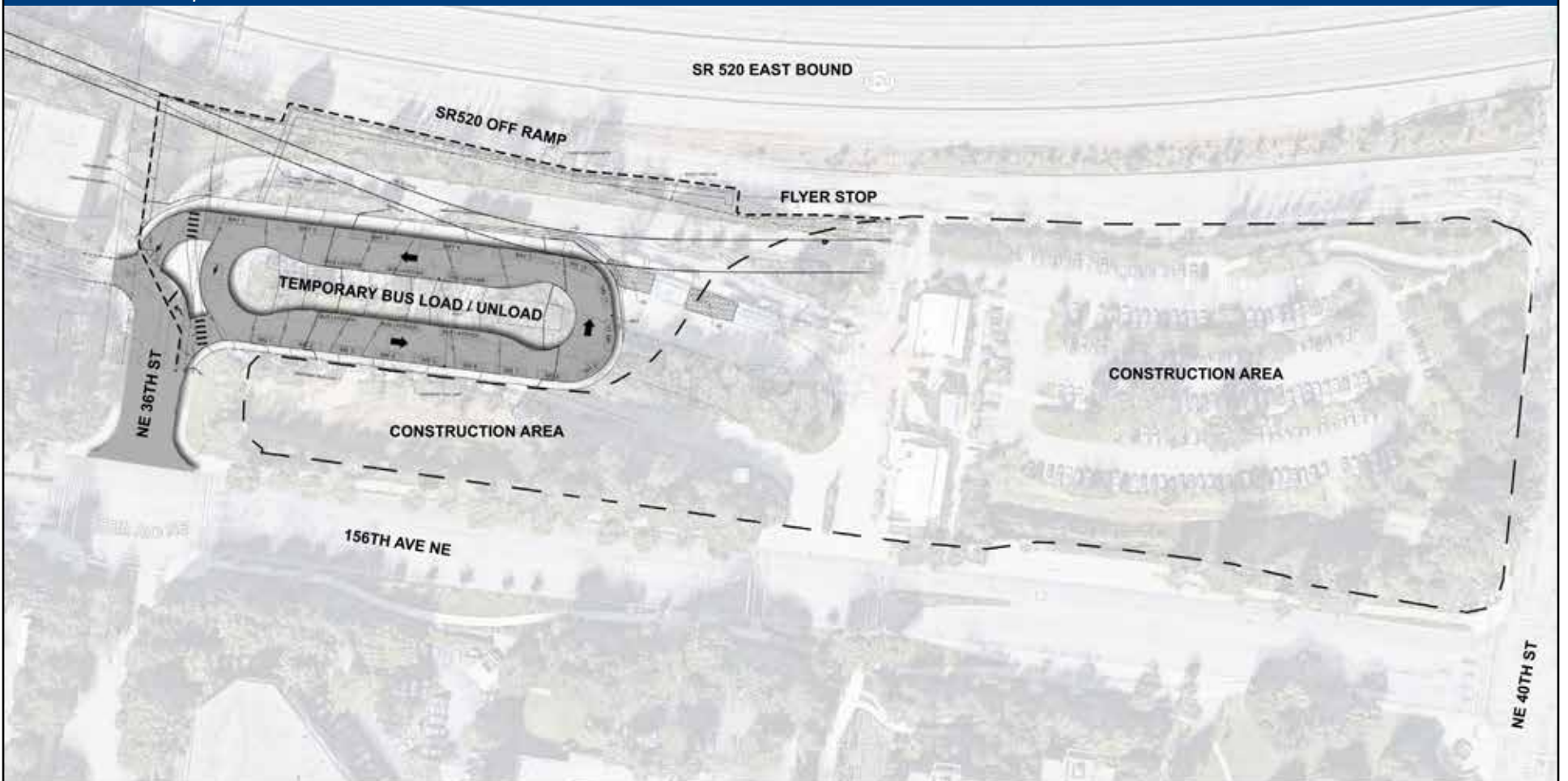

NOV 2016

CONSTRUCTING THE OVERLAKE STATIONS

EAST LINK EXTENSION



Starting in spring 2017, the Overlake Transit Center site will become an active construction zone. A temporary transit loop will be constructed at the south end of the site, and the north end of the site will no longer be accessible to the public until the station opens in 2023. The new 320 stall park-and-ride garage on site is scheduled to open with the start of light rail service. Sound Transit and the contractor will explore options to open the garage sooner if possible.

- The Overlake Transit Center Park-and-Ride will serve as the construction hub for building the Redmond Technology Center Station, track and 320-stall parking garage and staging equipment.
- Sound Transit has identified alternative options for park-and-ride users, including directing riders to underused park-and-rides, leasing parking space from nearby lots in the community and partnering with King County Metro to provide alternative transit options during construction.

Project schedule

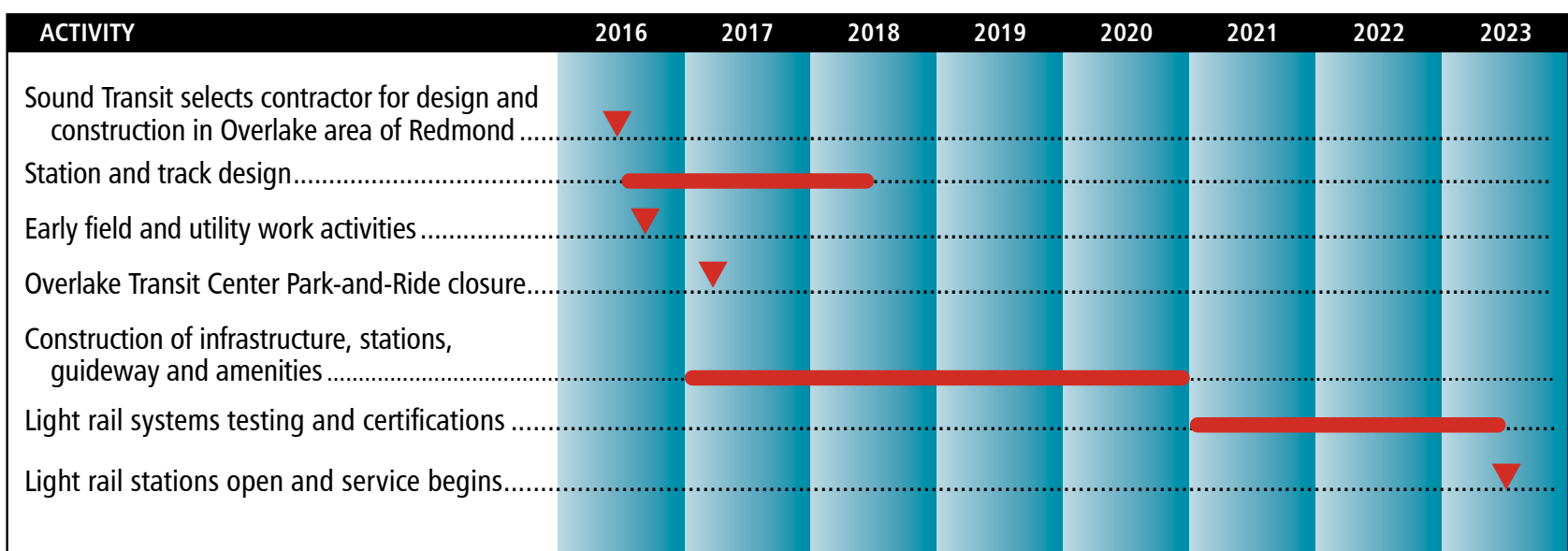

2017

Site preparation | utility and underground infrastructure work | bus loop and garage construction | station construction and garage finishes | site finishes | systems testing | station opens

2023

- 50,000 cubic yards of dirt will be excavated from both station sites and used within the project area to construct the access road along the guideway.
- 38 drilled shafts for the project as deep as 80 feet.
- The park-and-ride will be closed for up to six years during construction.



NOV 2016