



East Link Extension Bel-Red Final Design Open House

March 28, 2013

Tonight's Agenda

- 4-7 p.m. – Open house
 - Meet the team
 - View design plans
 - Tell us what you think!
- 5:30 – Presentation
 - Welcome and introductions (Katie Kuciemba)
 - East Link overview (Leonard McGhee)
 - Bel-Red station design update (Chad Zettle & Mark Reddington)
 - *STart* (Barbara Luecke)
 - Questions and answers
- 6:15 – Return to open house
- 7:00 - Close



Link Light Rail System

- 16 miles of light rail with 13 stations currently in service
- University Link under construction; opens 2016
- ST2 Plan funded extensions to Overlake, South King County, and Lynnwood
- 50+ mile system
- New Operations and Maintenance Satellite Facility

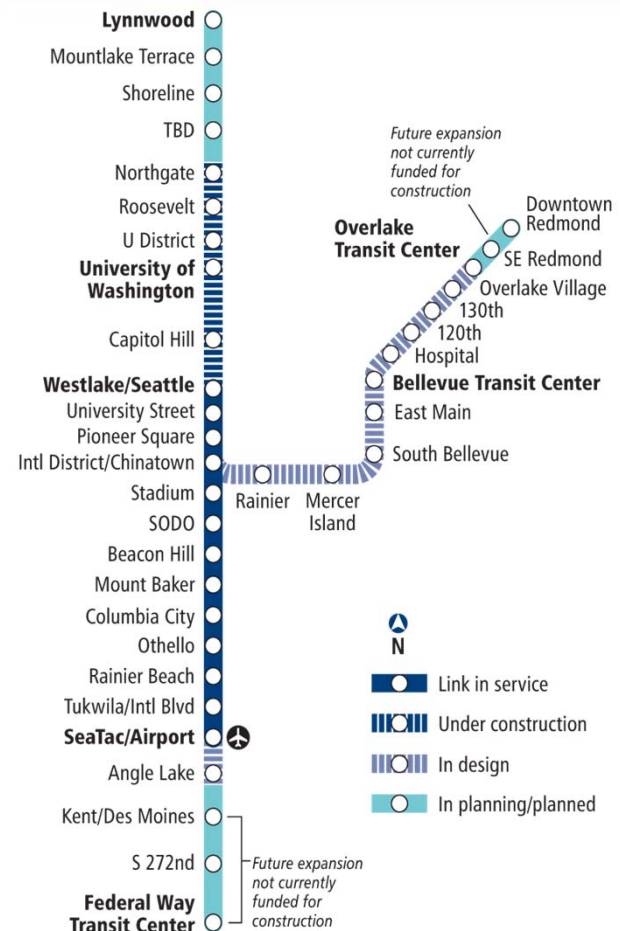

East Link Overview

Length: 14 miles

Ride times:

- Mercer Island to UW: 20 min.
- S. Bellevue to Airport: 50 min.
- Overlake Transit Center to
Bellevue Transit Center: 10 min.

Rider projection: 50,000 daily by
2030

Budget: \$2.8 billion (2010 \$)

Start of Service: Targeted 2023

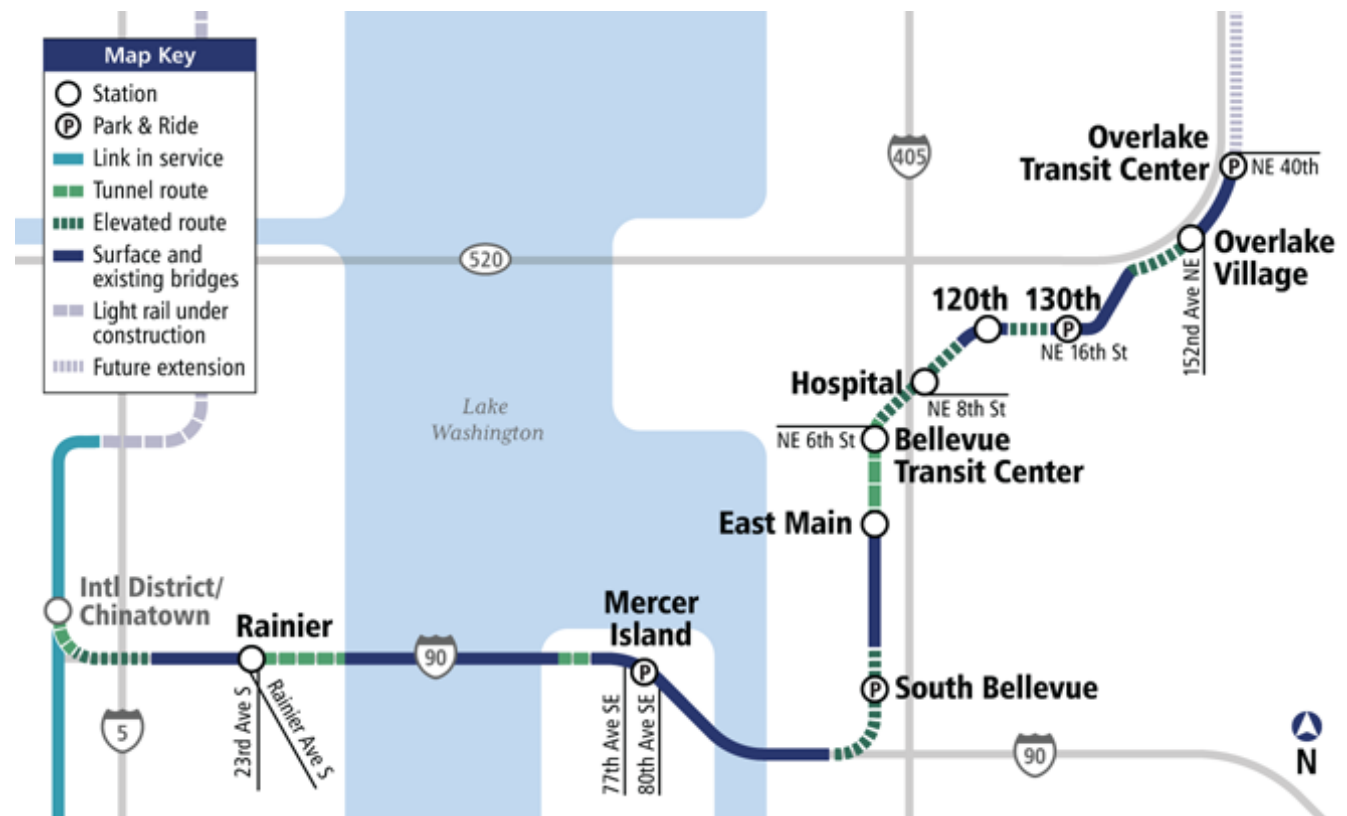

East Link Timeline



What you can expect during final design

Design milestones

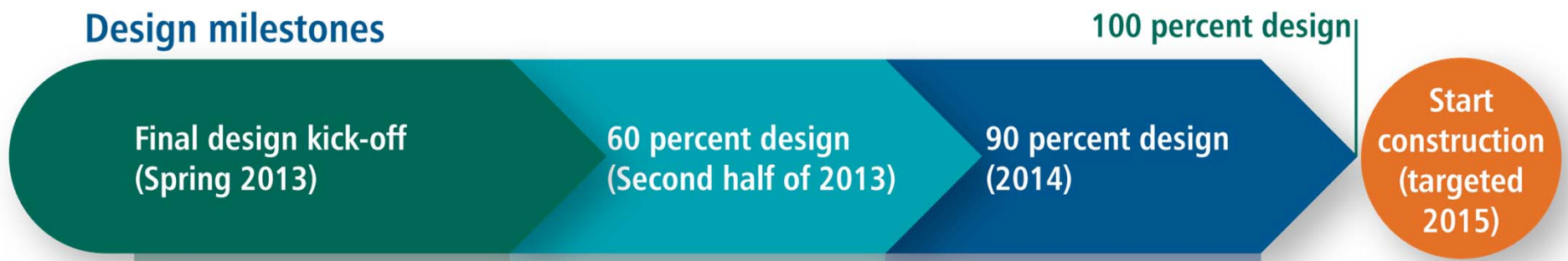

The Transformation of Bel-Red

Bellevue's Land Use Vision for Bel-Red

- Mixed Use development
- 5000 housing units and 10,000 employees

Bellevue's Transportation Vision for Bel-Red

- Increased capacity for existing roads
- New East/West Corridor and grid network of streets
- Extensive system of sidewalks, trails and bike facilities
- Re-greening including open spaces and stream corridors

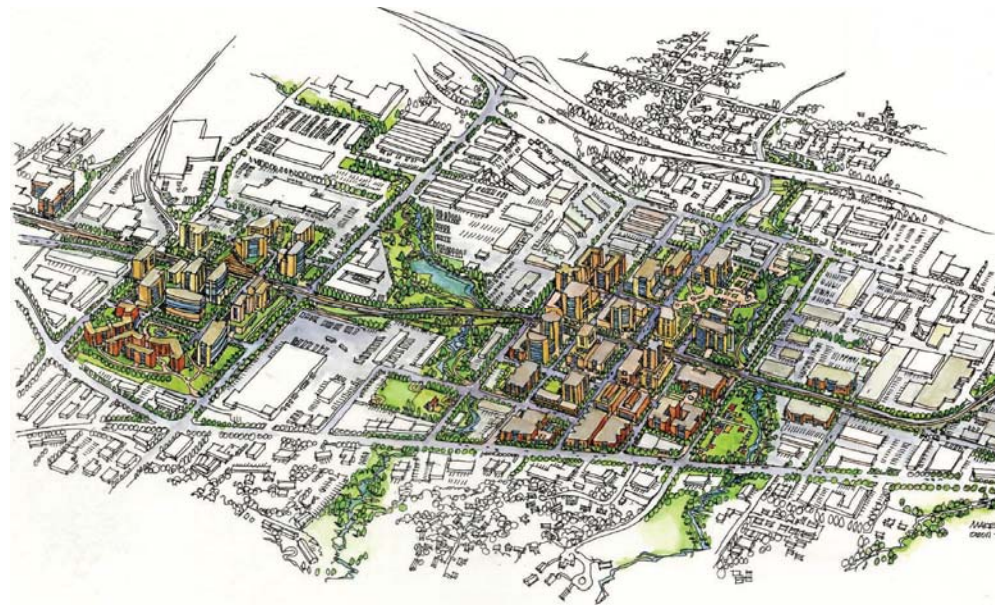

Bel-Red Segment Overview

- At-grade, elevated and retained cut alignment
- Stations at 120th and 130th
- New 300 stall park-and-ride
- Planning for future development and street improvements

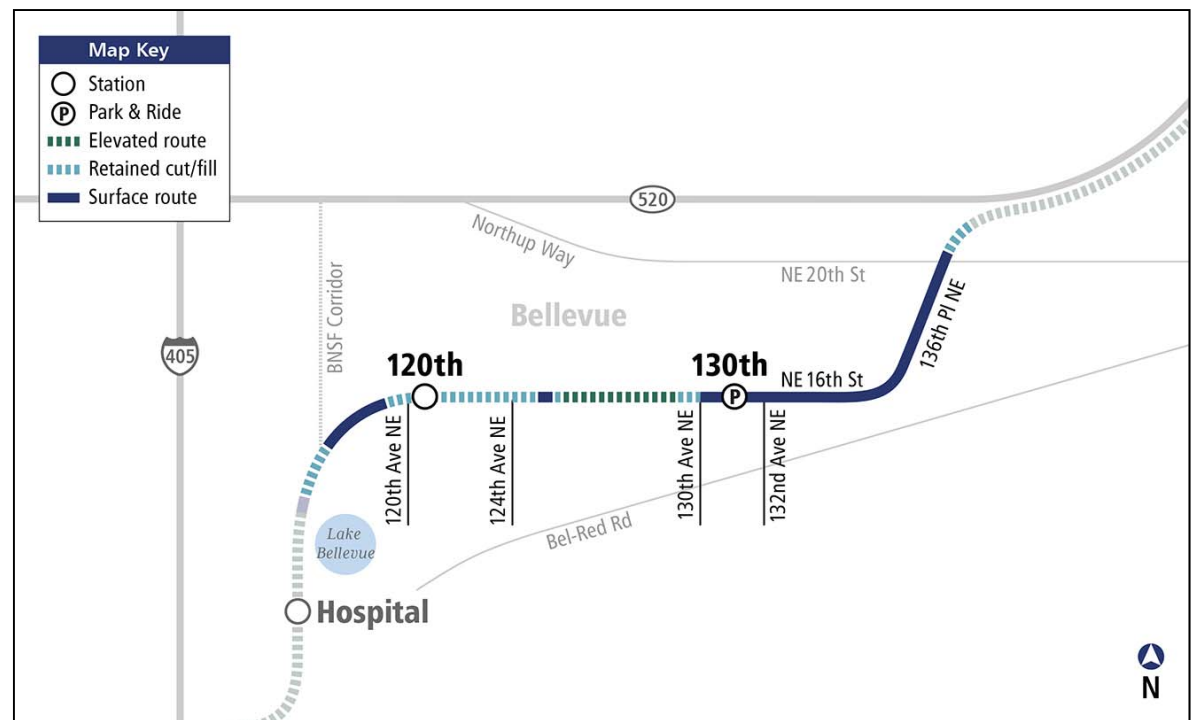

Permanent Station Names

- Reflect the nature of the community and environment
- Succinct and easy to read
- Comply with federal Americans with Disabilities Act guidelines and limited to 30 characters
- Avoid commercial references
- Avoid similar names or words in existing facilities



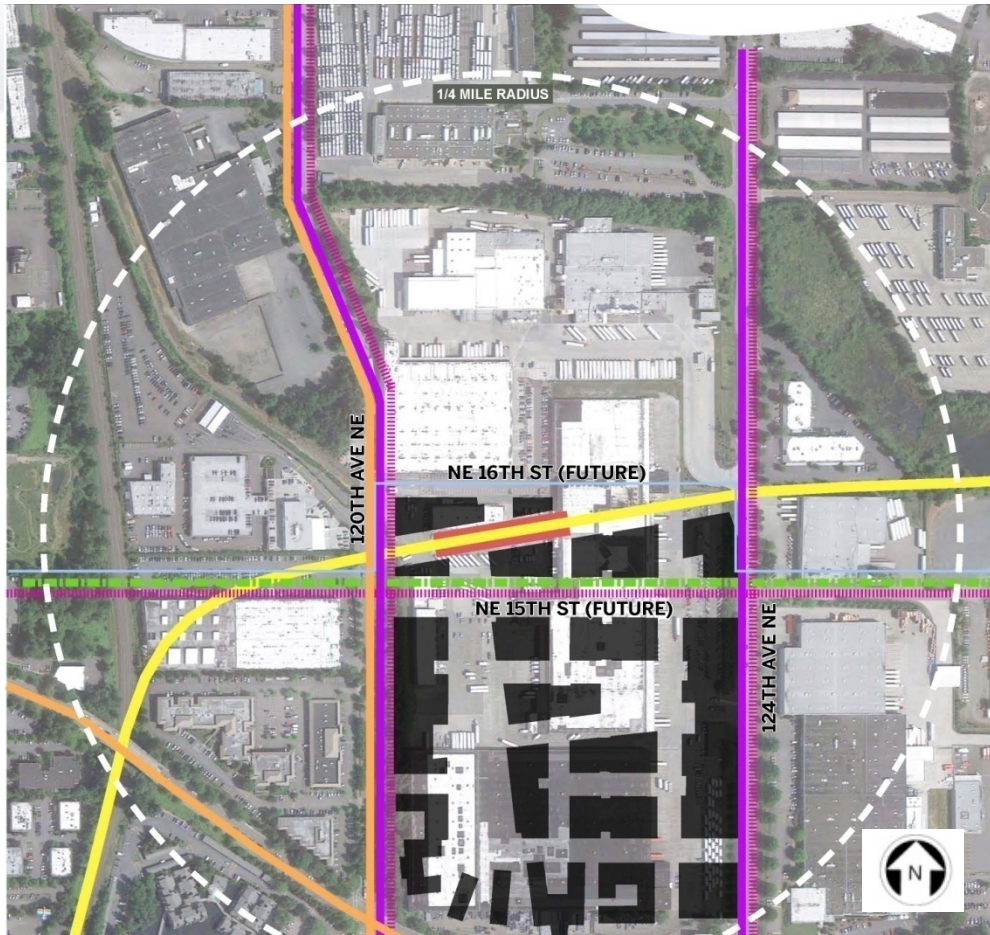

LEGEND

BUS ROUTE

BICYCLE ROUTE

BICYCLE LANE

OFF STREET PATH

PROPOSED
NEW SIDEWALKS

LIGHT RAIL TRACKS

STATION

PATRON CATCHMENT
AREA

FUTURE DEVELOPMENT

City of Bellevue and
Sound Transit planned
improvements

120th Station: Neighborhood Context Plan

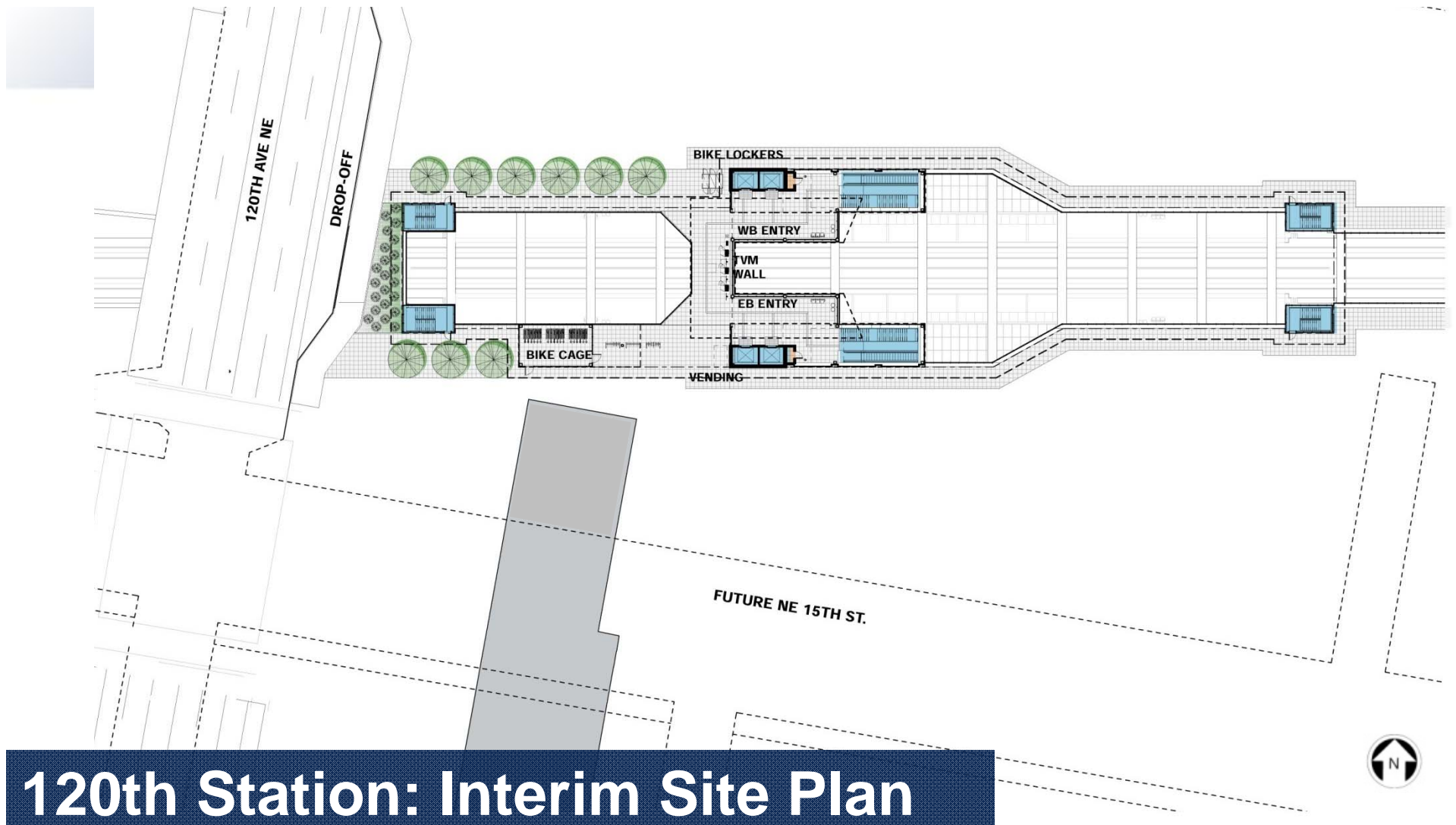

120th Station: Interim Site Plan

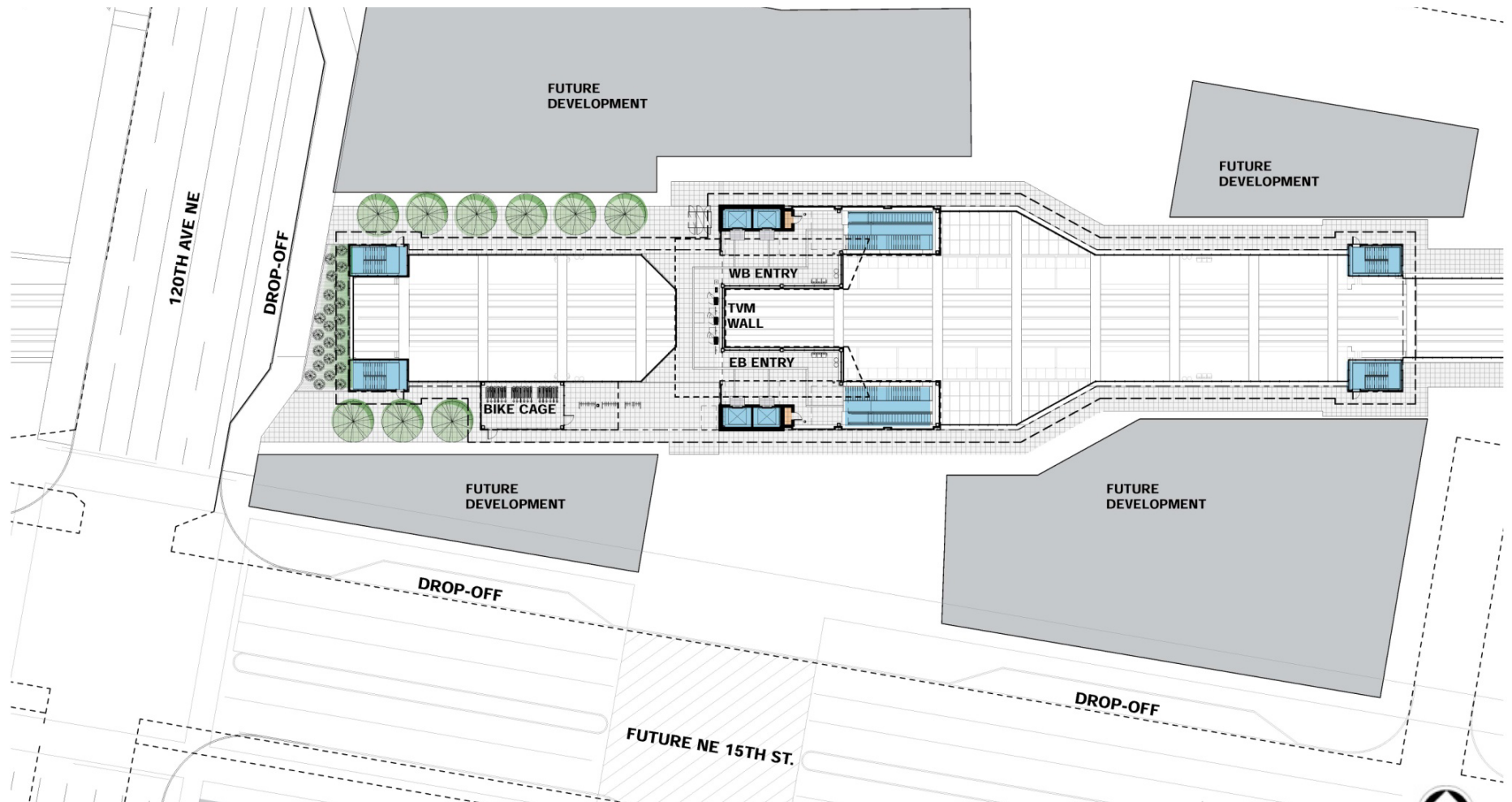

120th Station: Future Conceptual Site Plan

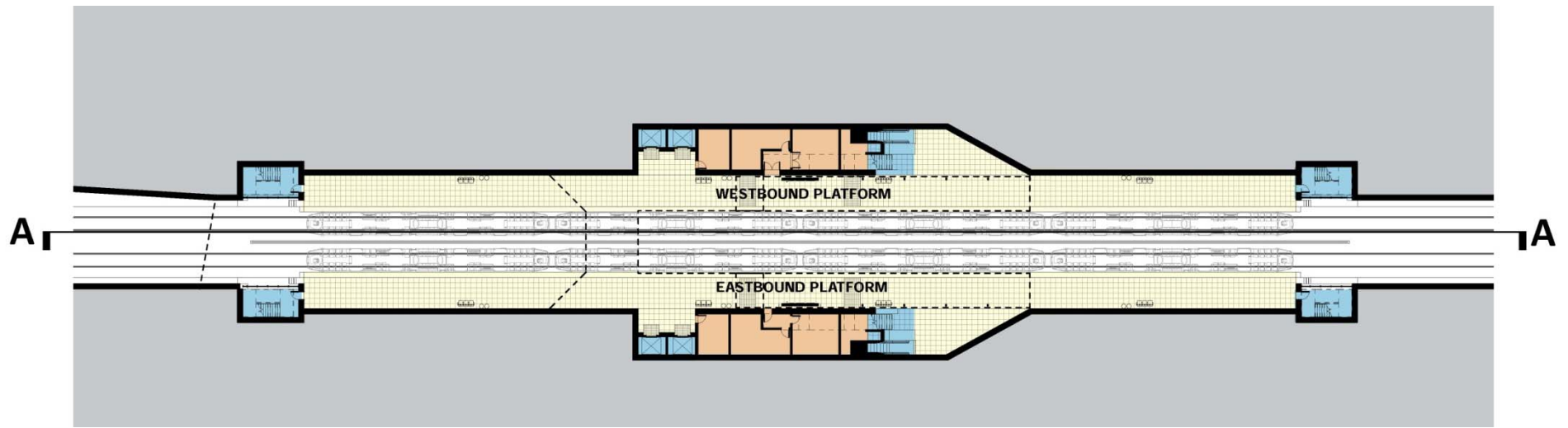

120th Station: Platform Level Plan

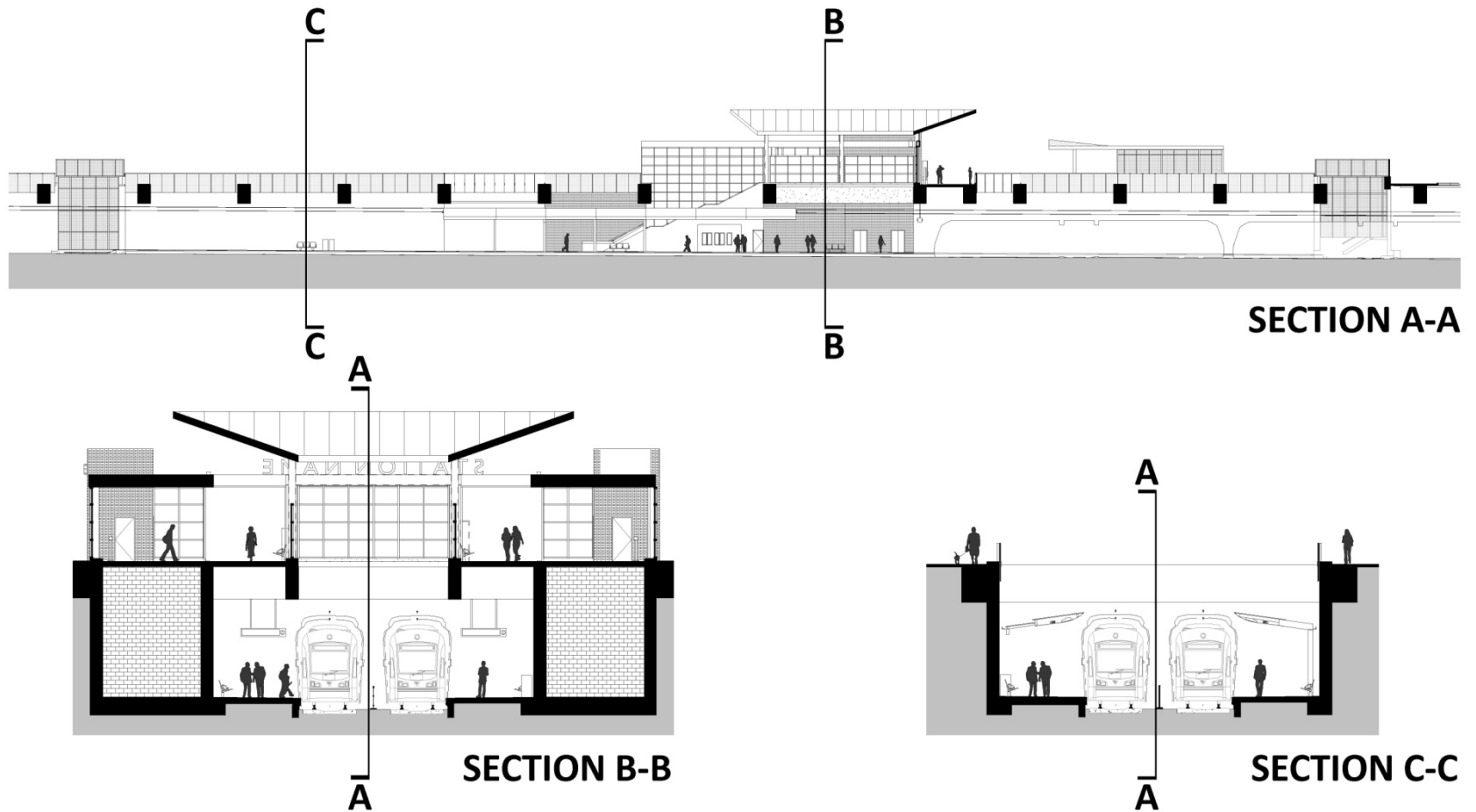

120th Station: Cross Sections



120th Station: Platform View

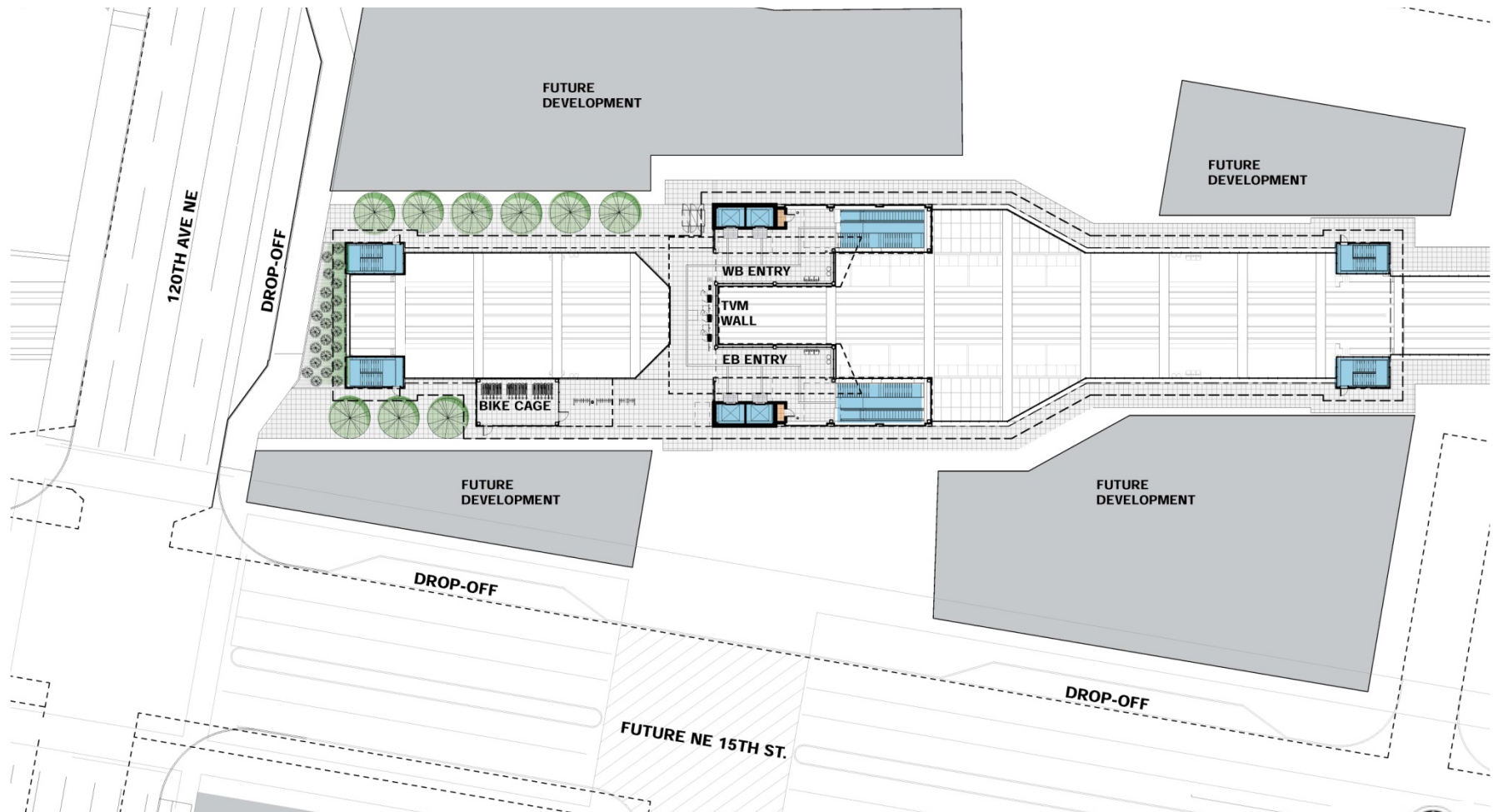

120th Station: Future Conceptual Site Plan

120th Station: Entrance from future NE 15th St.



120th Station: Entrance from 120th Ave NE





LEGEND

BUS ROUTE 8

BICYCLE ROUTE

BICYCLE LANE

PROPOSED NEW
BICYCLE LANE

OFF STREET PATH

OFF STREET PATH

SIDEWALKS

PROPOSED
NEW SIDEWALKS

GOFF CREEK

LIGHT RAIL TRACKS

SHOPPING CORRIDOR
- BEL-RED CORRIDOR
2030 MASTER PLAN, COB

B
CURRENT BUS STOP

130th Station: Neighborhood Context Plan

City of Bellevue and
Sound Transit planned
improvements

130th Station: Site Plan



130th Station: Future Conceptual Site Plan

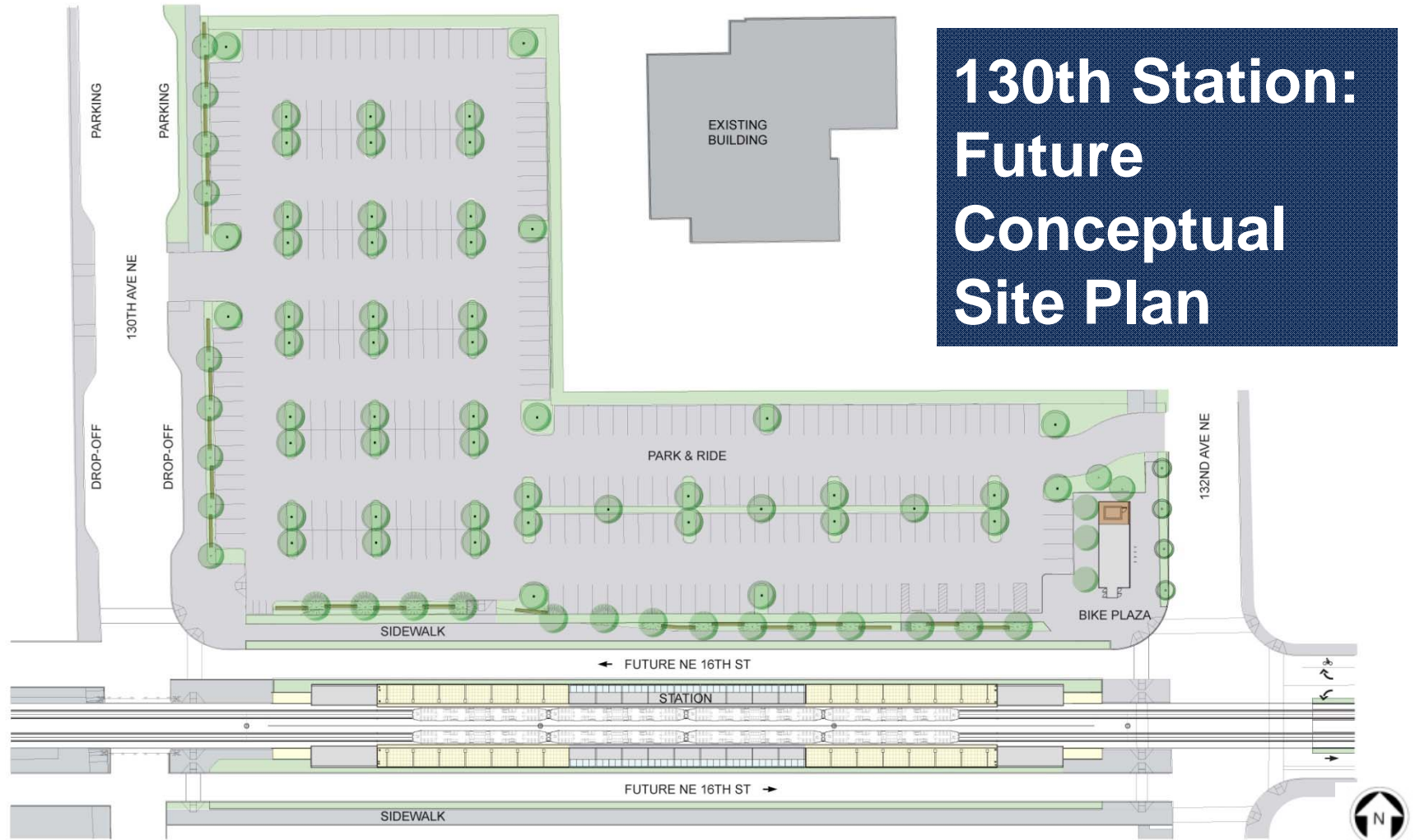

130th Station: Ancillary Structures

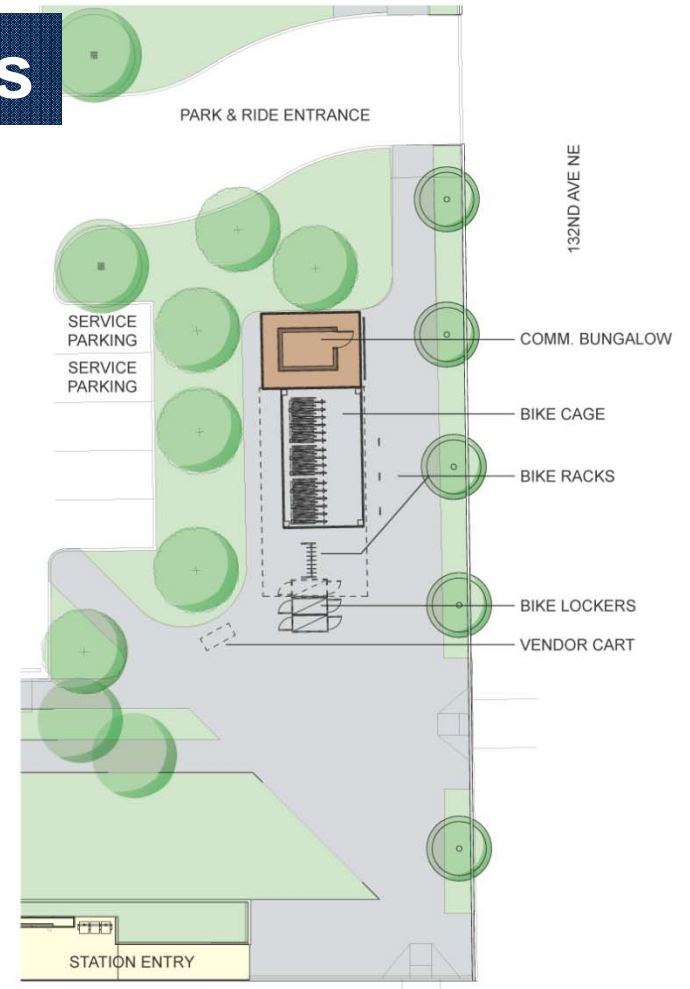

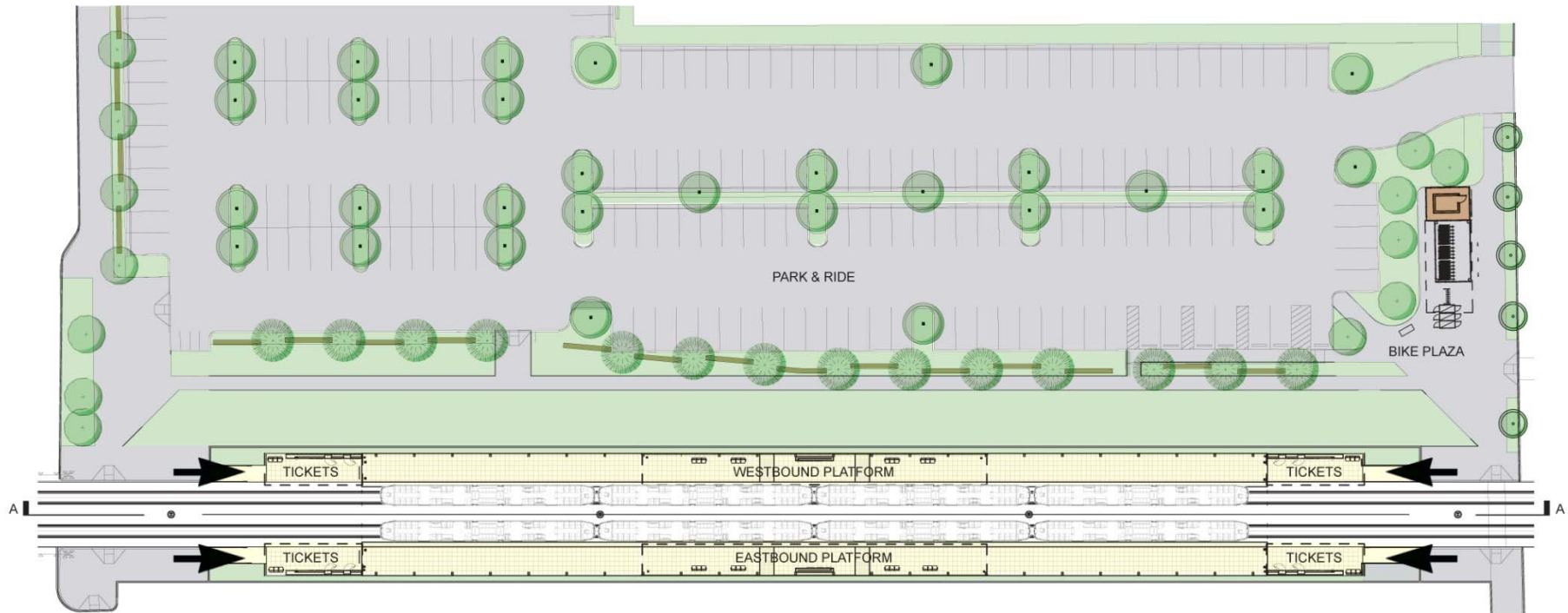

130th Station: Platform Plan View



130th Station: Cross Sections

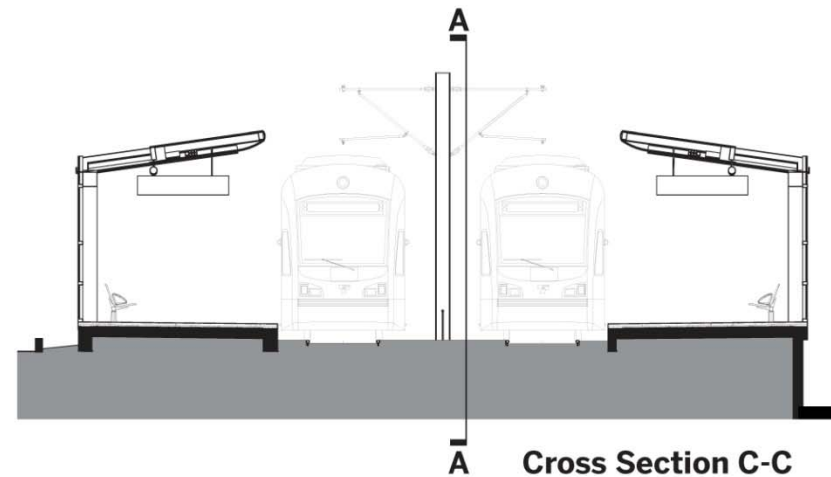
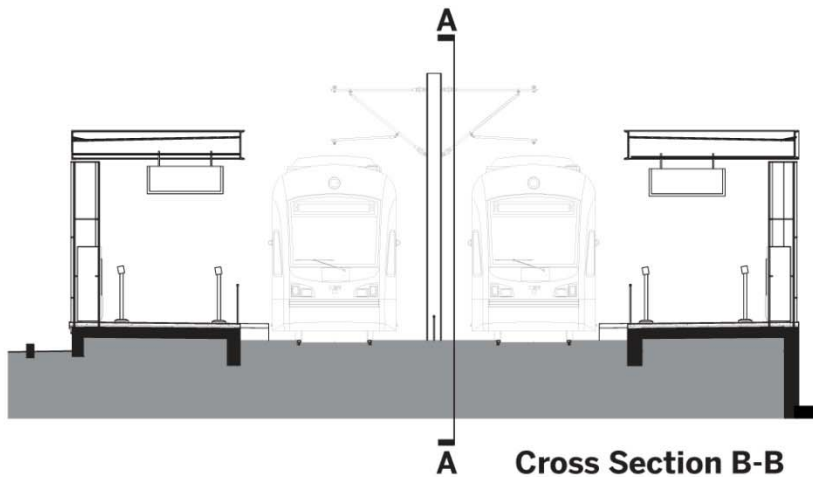
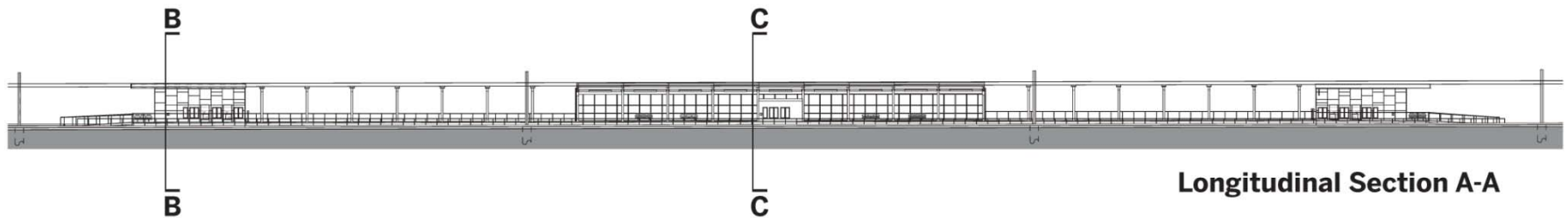

130th Station: Platform View Looking West



130th Station: Entrance from 132nd Ave NE



Sound Transit Art Program

STart on LINK



Next Steps

- Continue coordination with local jurisdictions
- Station naming
- Select artists
- Advance design to 60%



We want to hear from you!

- Sound Transit Community Outreach staff is accessible by phone, email, and is available to meet in person
- Contact Community Outreach staff: eastlink@soundtransit.org or 206-398-5470
- Attend final design community meetings
- Sign-up to receive email updates: www.soundtransit.org/subscribe
- Visit the project website: www.soundtransit.org/eastlink

Questions?

