

# ***Downtown Redmond Link Extension Project Update***

*Community Oversight Panel  
7/13/22*



# ***Introductions***

## Today's Presenters:

- **Tony Raben**  
*Executive Project Director, Downtown Redmond Link Extension*
- **Eza Agoes**  
*Deputy Executive Project Director, Downtown Redmond Link Extension*
- **Charlie Hockett**  
*Senior Community Engagement Specialist, Downtown Redmond Link Extension*

# ***Downtown Redmond Link Extension Project Update***

- Project Overview
- Project Status
- Construction Activities
- Stakeholder and Community Engagement
- Q&A



*Marymoor Village Station & Garage*

# Downtown Redmond Link Extension

- 3.4 miles, 2 stations
  - Marymoor Village Station
  - Downtown Redmond Station
- 1,400 stall parking garage at Marymoor Village with Ground floor transit center
- Design Build Delivery – 1 Contract
- Start of service: 2024
- Redmond to Bellevue Downtown: 17 minutes
- Redmond to Downtown Seattle: 42 minutes
- Four-minute headways during peak hours

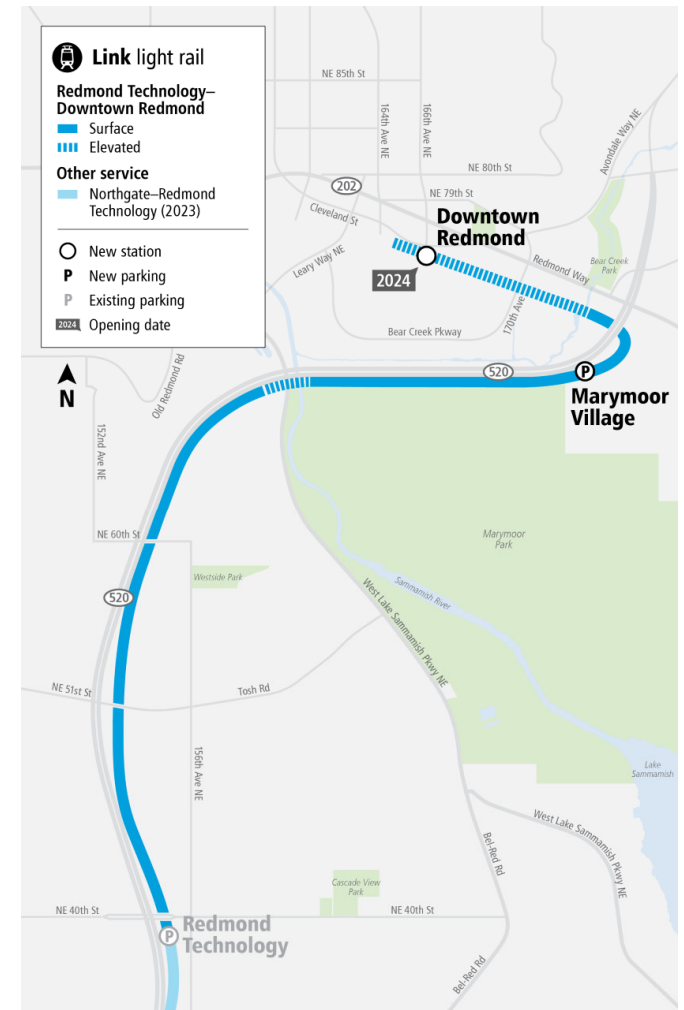



**Slide 4**

---

**HCO**

**Update Map**

Hockett, Charlie, 2022-06-24T17:18:34.798

# Baseline Schedule

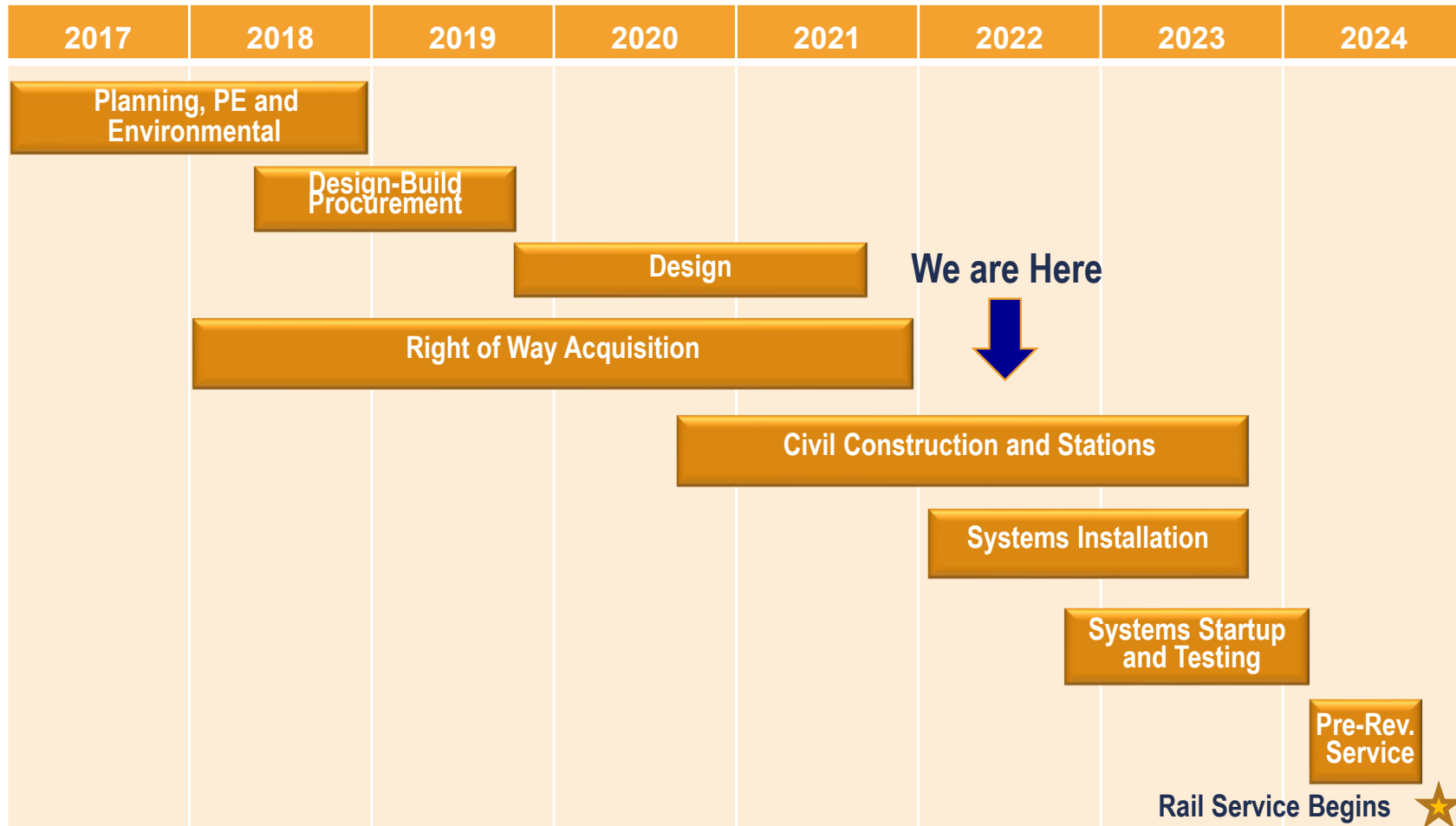

# Financial Status

## Cost Summary by Work Breakdown Structure Phase

Project Phase	Baseline Budget	Authorized Project Allocation	Commitment to Date	Incurred to Date	Estimated Final Cost (EFC)
Administration	\$77.00	\$77.00	\$20.60	\$20.40	\$77.00
Preliminary Engineering	\$23.00	\$23.00	\$19.60	\$19.30	\$23.00
Final Design	\$4.50	\$4.50	\$1.20	\$0.90	\$4.50
Construction Services	\$58.00	\$63.60	\$49.40	\$25.80	\$63.60
Third Party Agreements	\$17.00	\$17.00	\$10.70	\$7.10	\$17.00
Construction	\$1,151.50	\$1,145.90	\$768.00	\$371.10	\$1,145.90
ROW	\$199.00	\$199.00	\$107.10	\$106.40	\$199.00
<b>Total</b>	<b>\$1,530.00</b>	<b>\$1,530.00</b>	<b>\$976.70</b>	<b>\$550.90</b>	<b>\$1,530.00</b>

- 36% of the project baseline budget has been spent.
- The Estimated Final Cost is within the baseline budget.

*\*Above-listed costs shown as-of May 31, 2022, in millions of year-of-expenditure dollars.*

# ***Project Challenges/Risks***

## ***Utilities***

Interfacing with private utilities for utility relocations and power services.

## ***Changes During Construction***

Owner directed changes, safety and security lessons learned.

## ***Multiple Project Openings in 2024***

Coordinating, managing, and staffing the opening/operations- Lynwood Link, Federal Way Link, Downtown Redmond Link.

## ***Externalities***

Recovery and impact from Teamsters Strike, COVID-19, supply-chain interruptions, inflation, and labor availability.

# *Construction Activities*

# *Major Accomplishment Past One Year*

## Completed:

- All Ground Improvements
- All Drilled Shafts
- All Soil Nail Walls
- New NE51st Roadway Bridge – Traffic On
- New SR520/202 WB Off Ramp Structure – Traffic On
- Garage Structure SOG and Level 2 West Half
- Bear Creek Restoration In-Water Work

# R200 - Sound Transit Project Overview

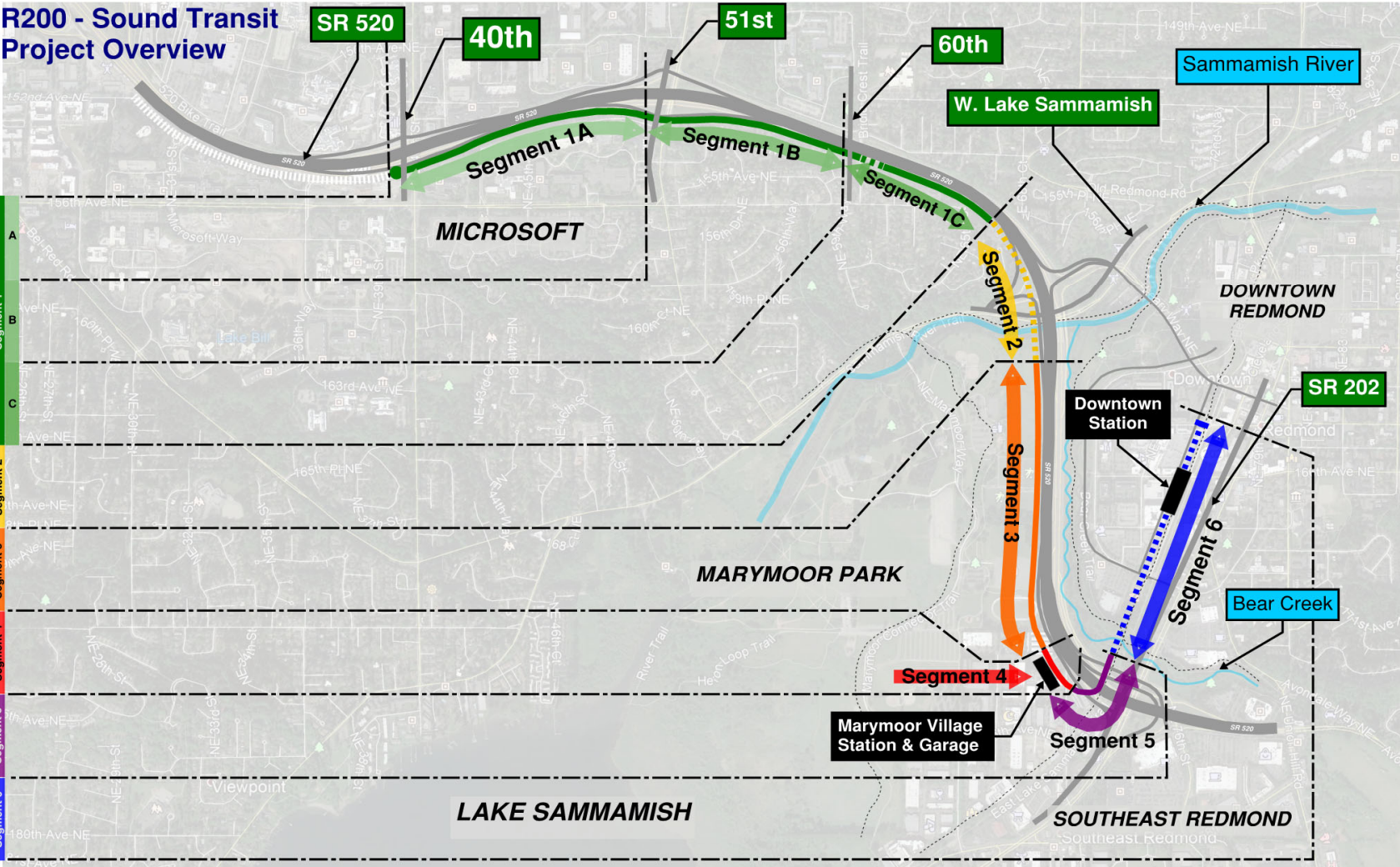



# R200 - Sound Transit Project Overview

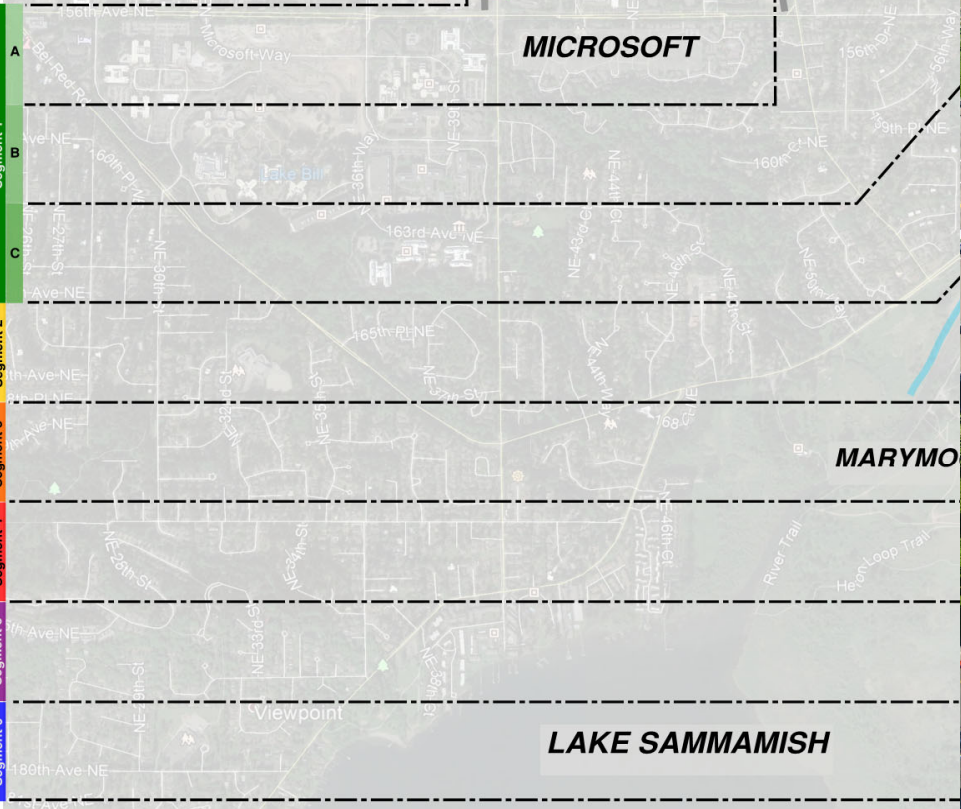
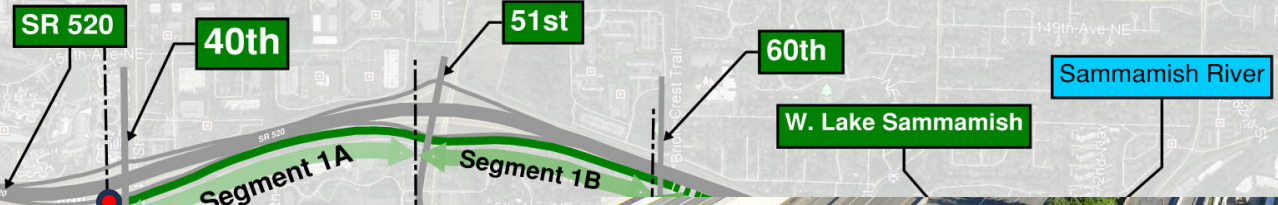



# R200 - Sound Transit Project Overview

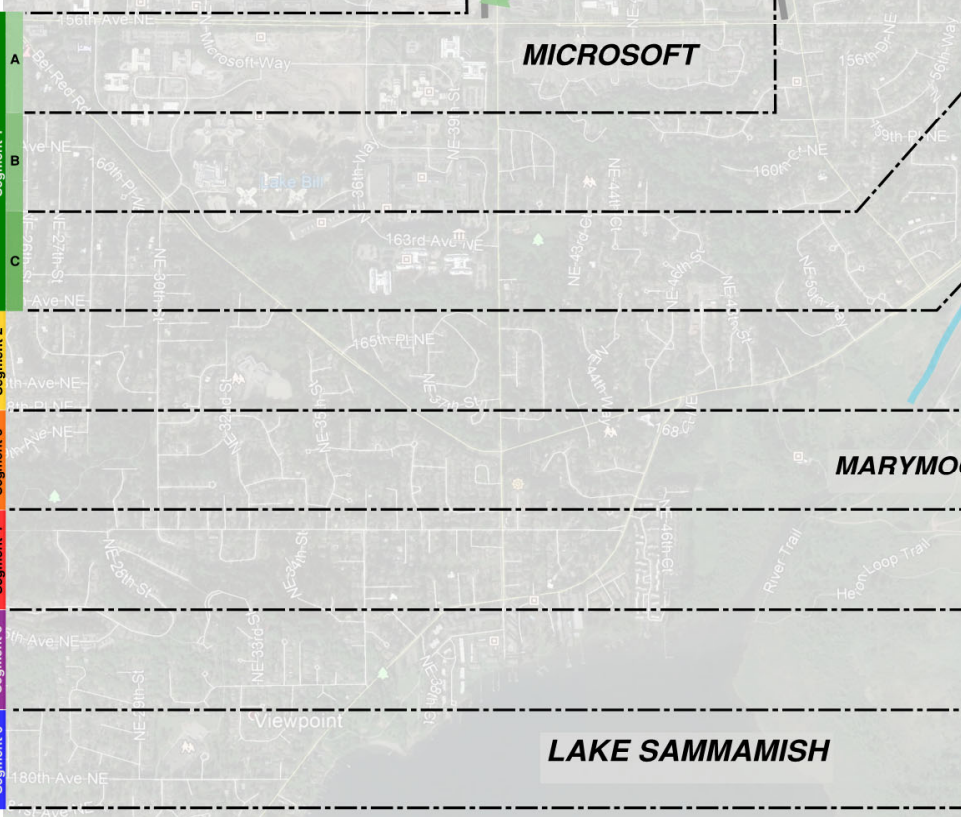
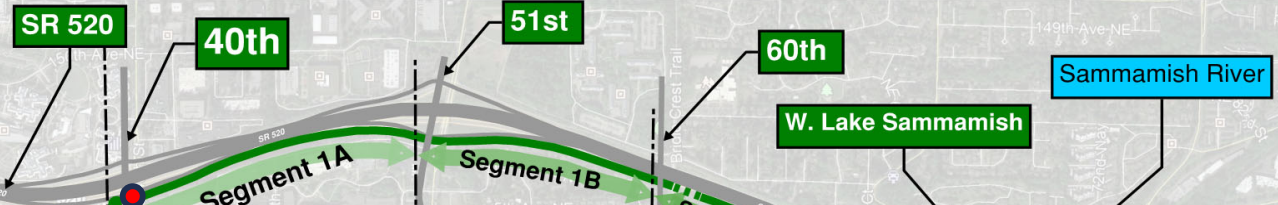



# R200 - Sound Transit Project Overview

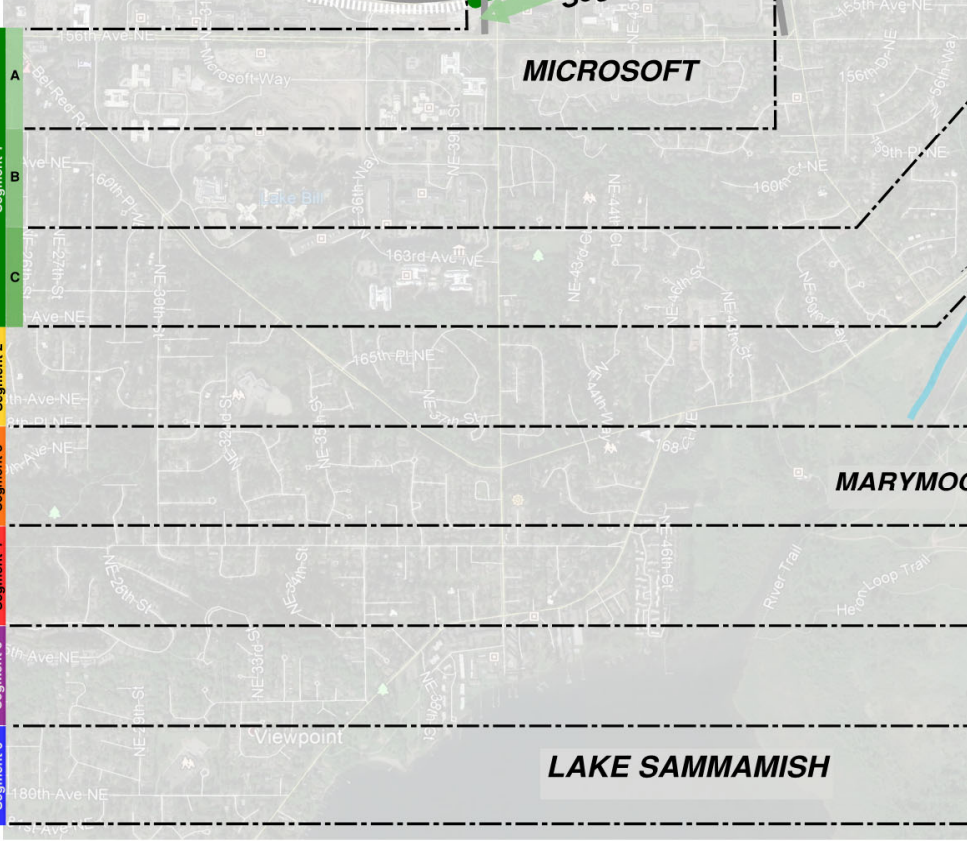
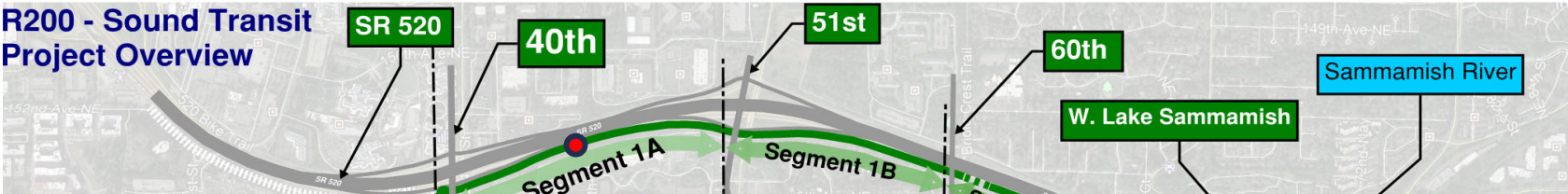



# R200 - Sound Transit Project Overview

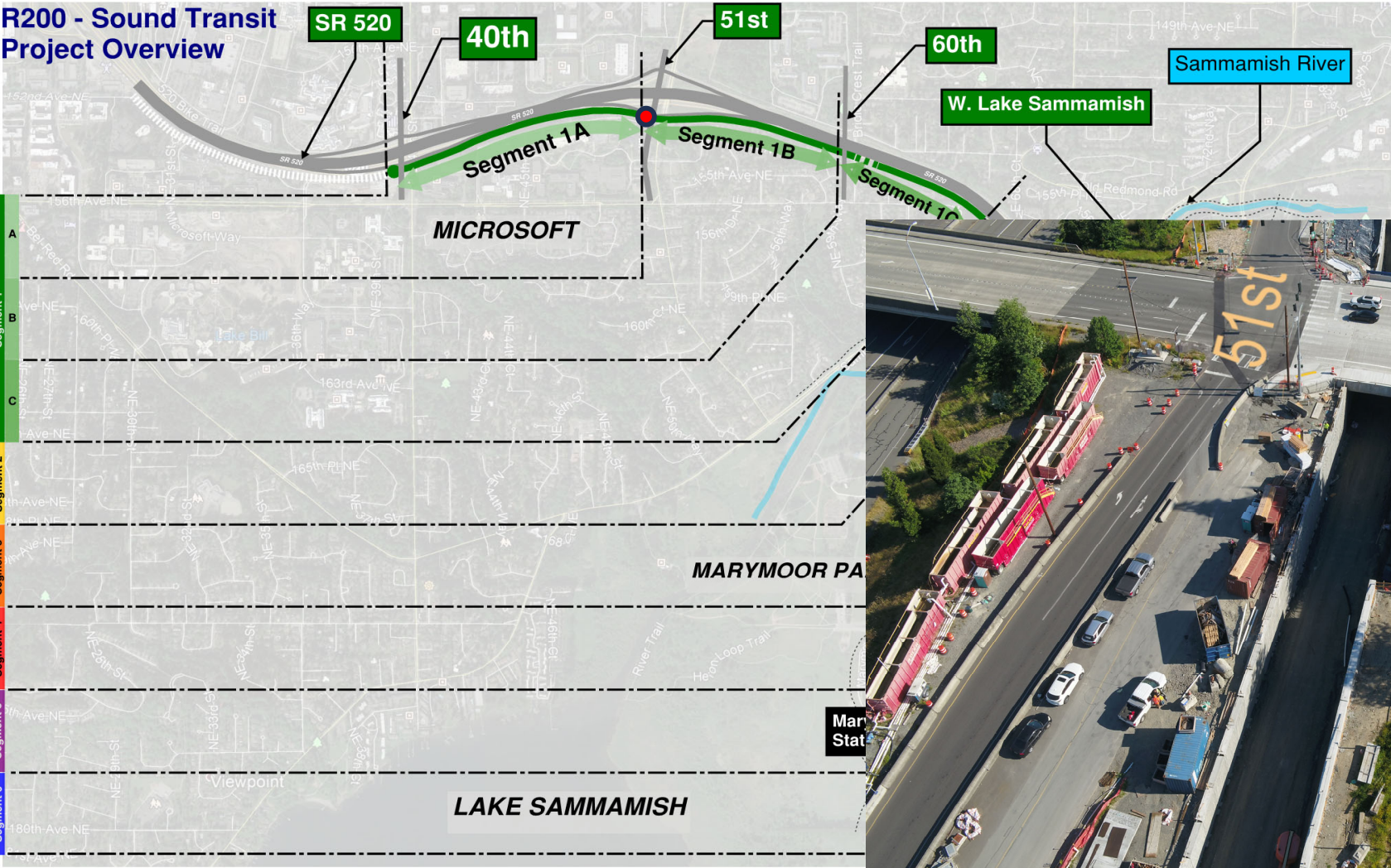



# R200 - Sound Transit Project Overview

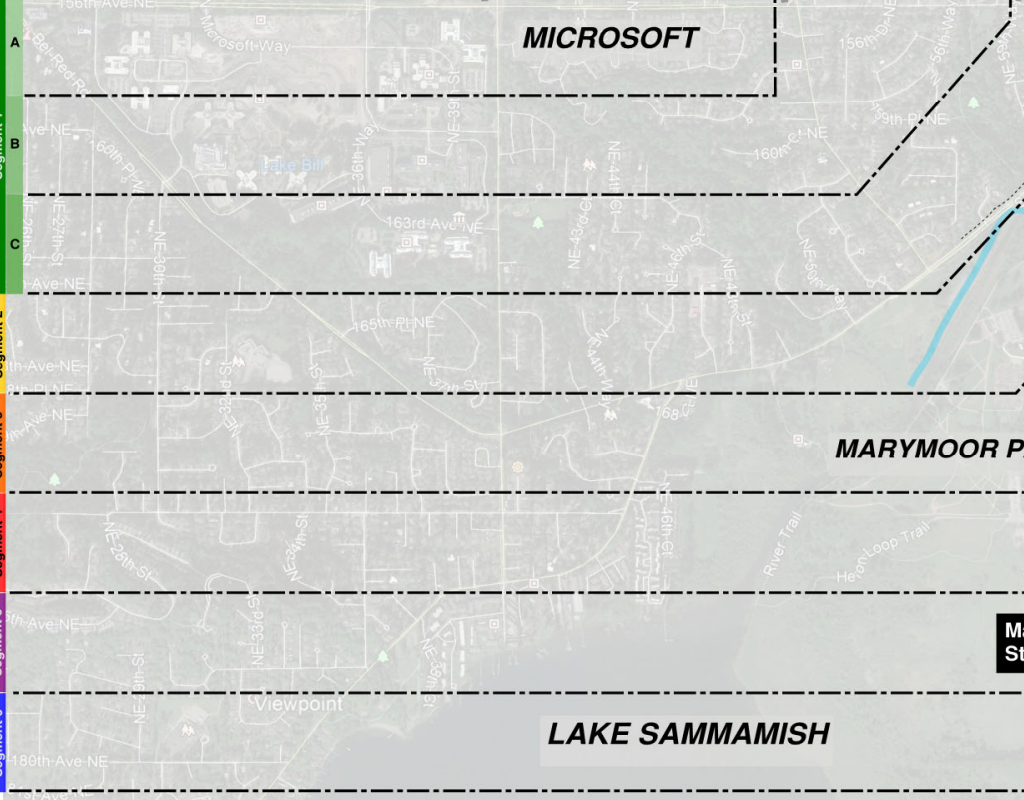
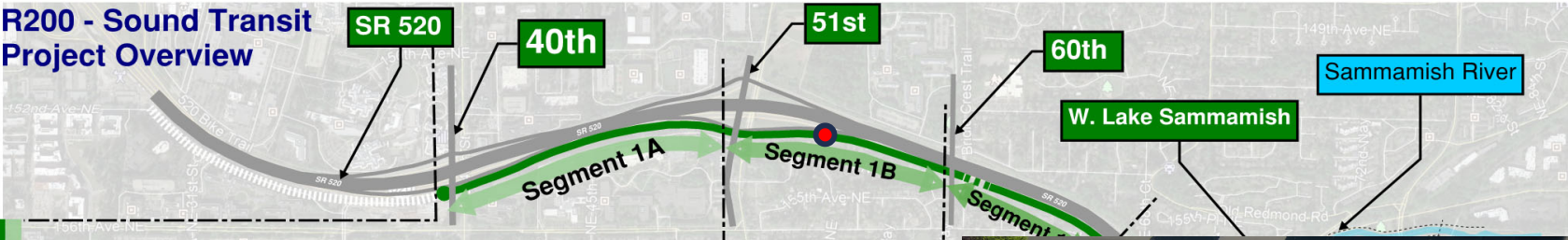



# R200 - Sound Transit Project Overview

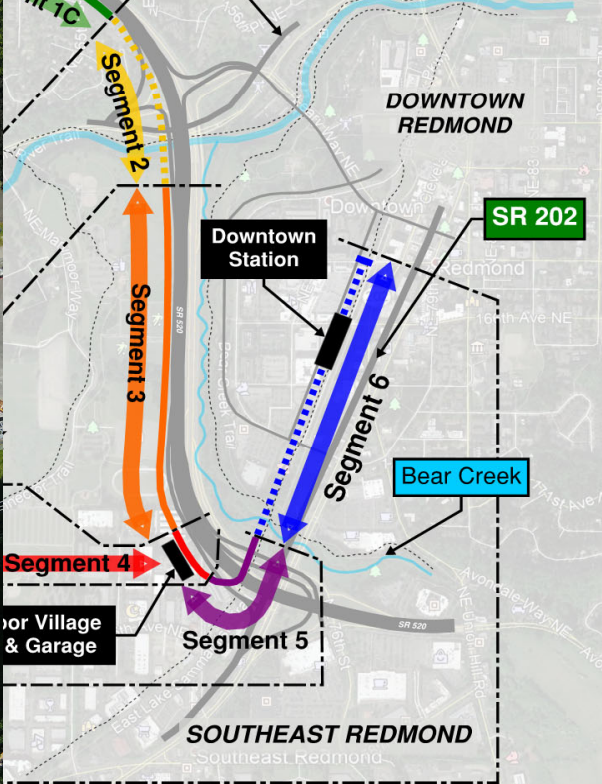
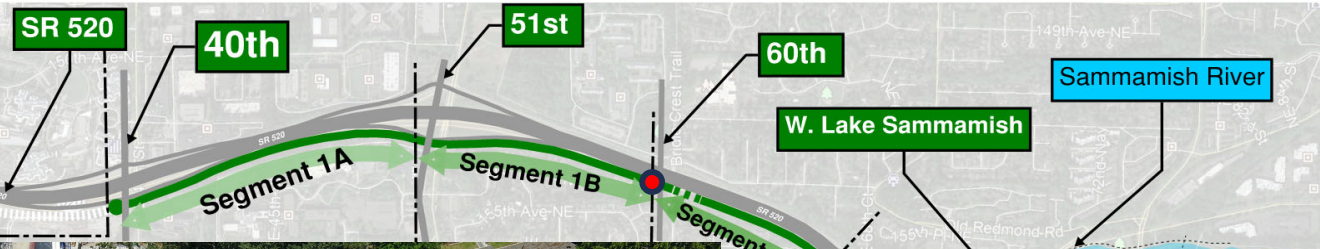



# R200 - Sound Transit Project Overview

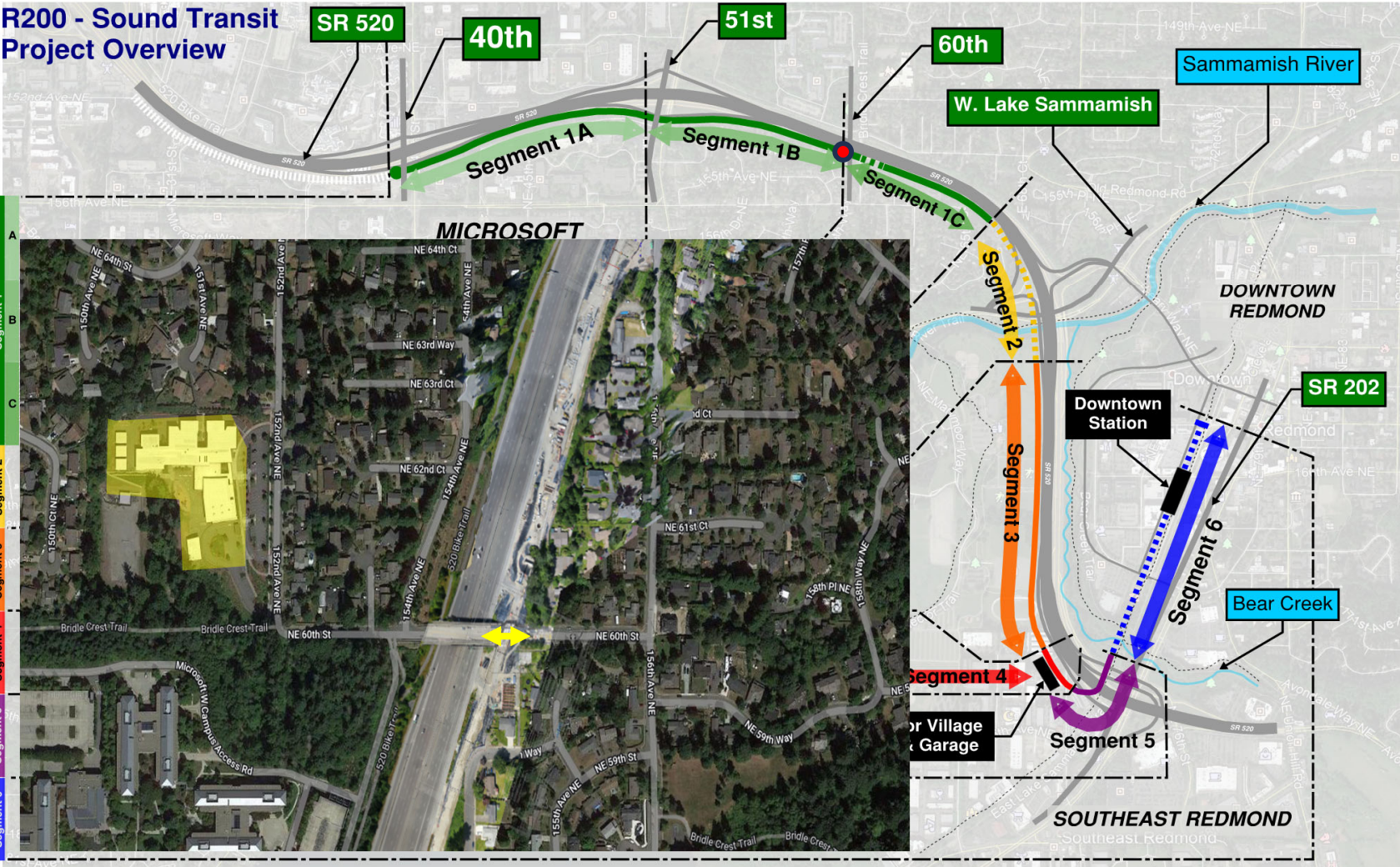



# R200 - Sound Transit Project Overview

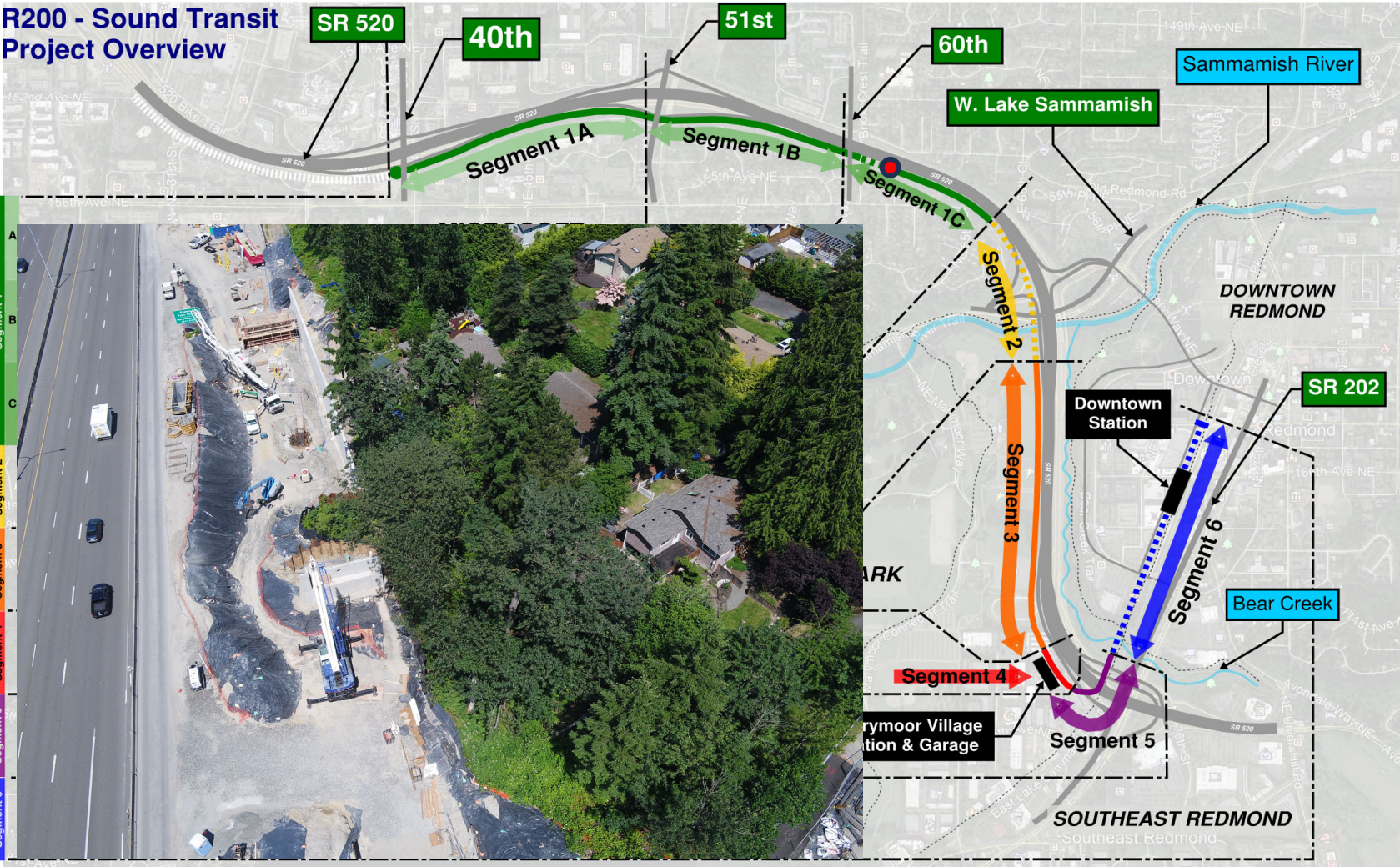



# R200 - Sound Transit Project Overview

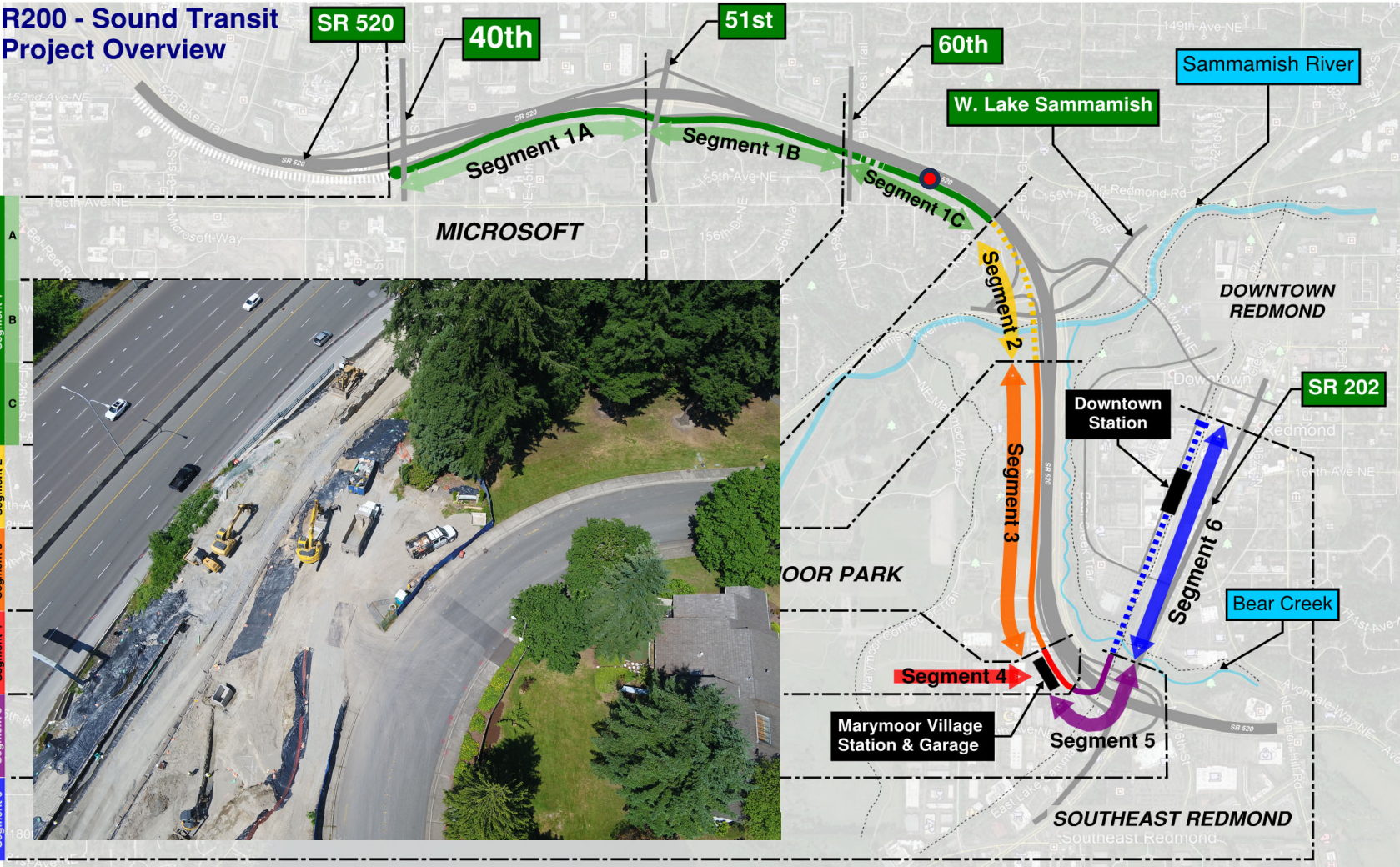



# R200 - Sound Transit Project Overview

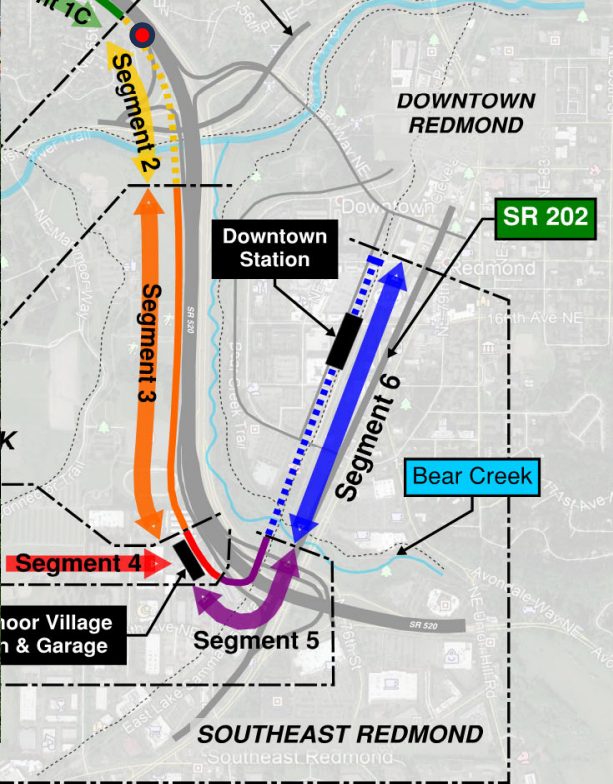
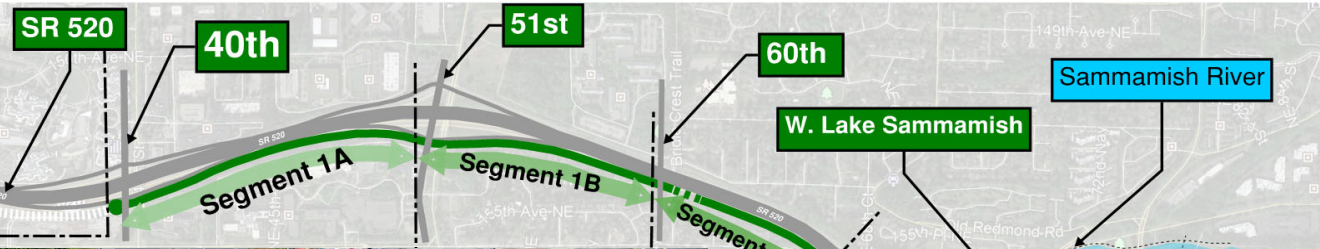



# R200 - Sound Transit Project Overview

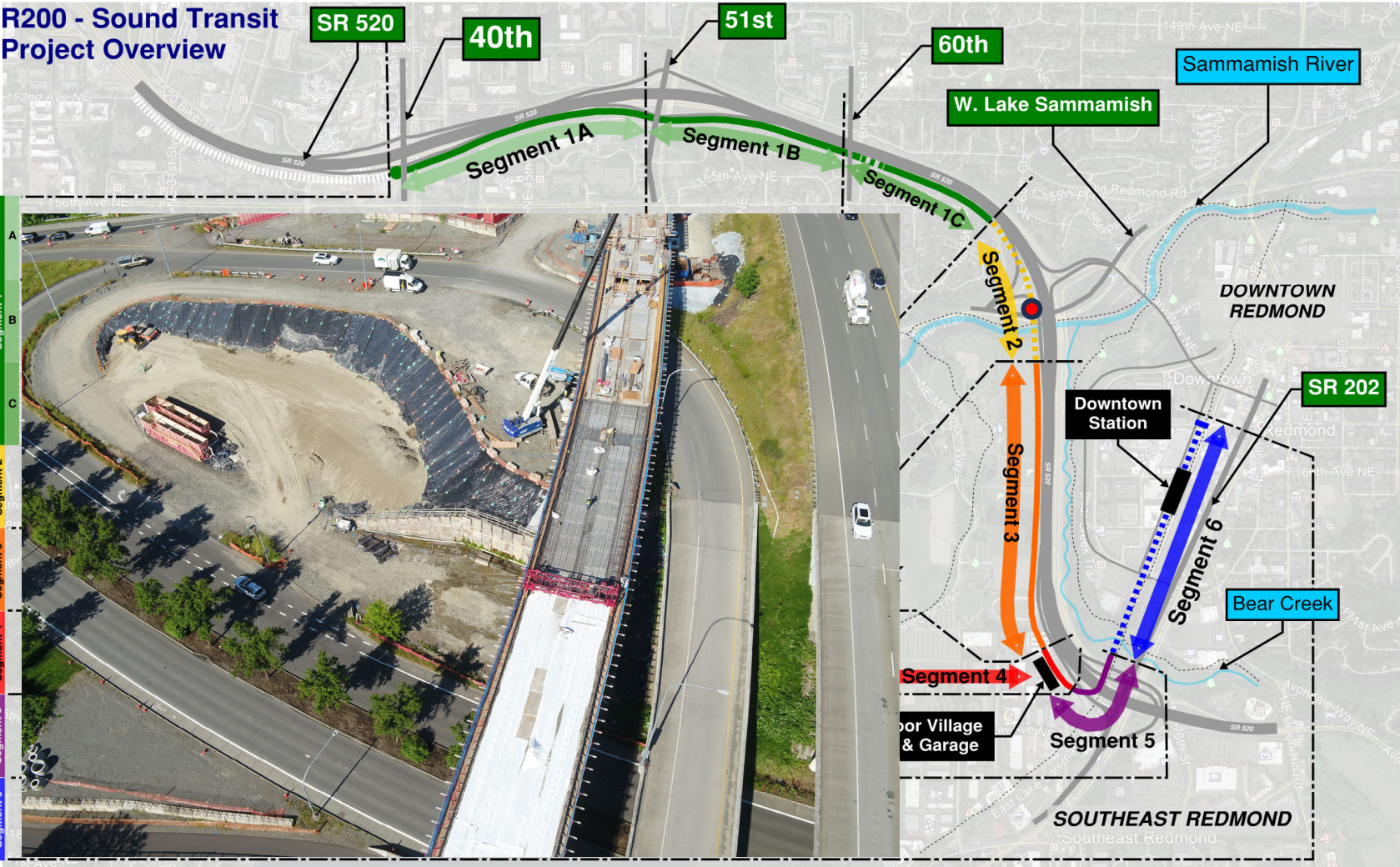



# R200 - Sound Transit Project Overview

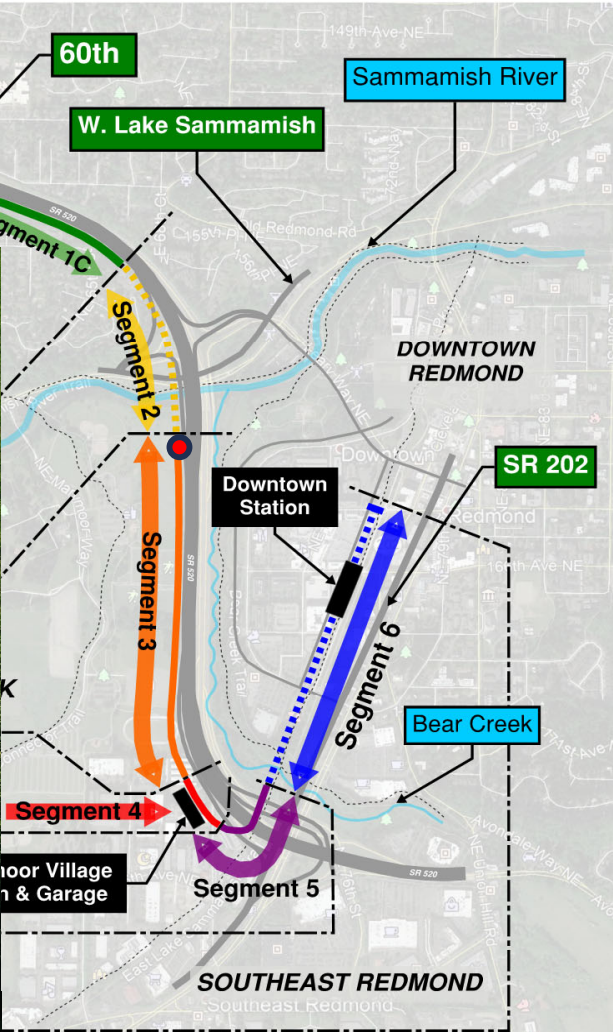
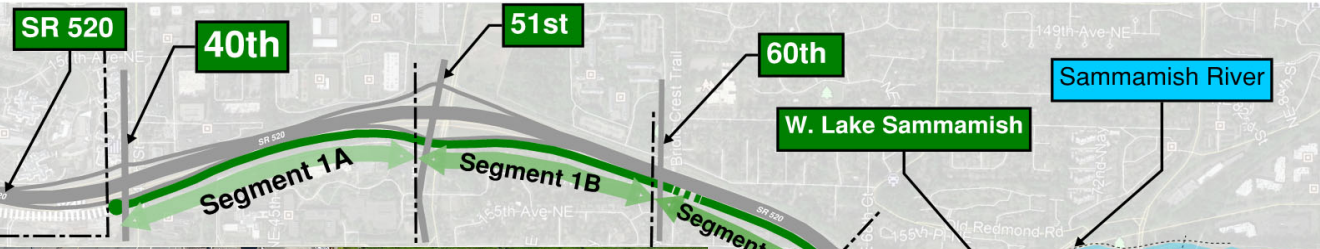



# R200 - Sound Transit Project Overview

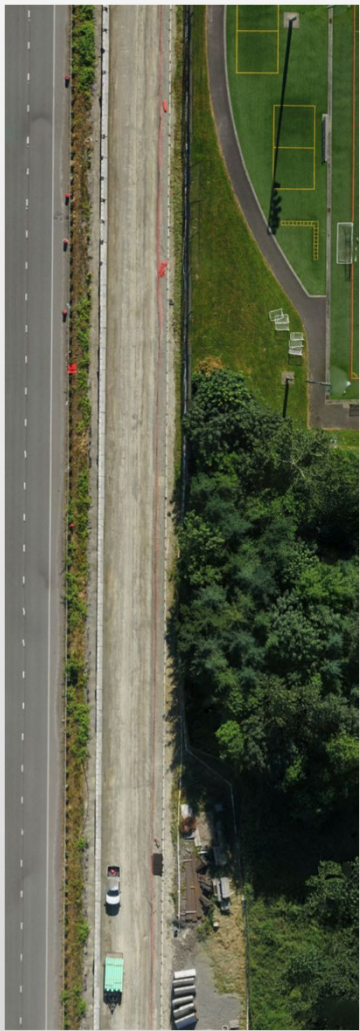
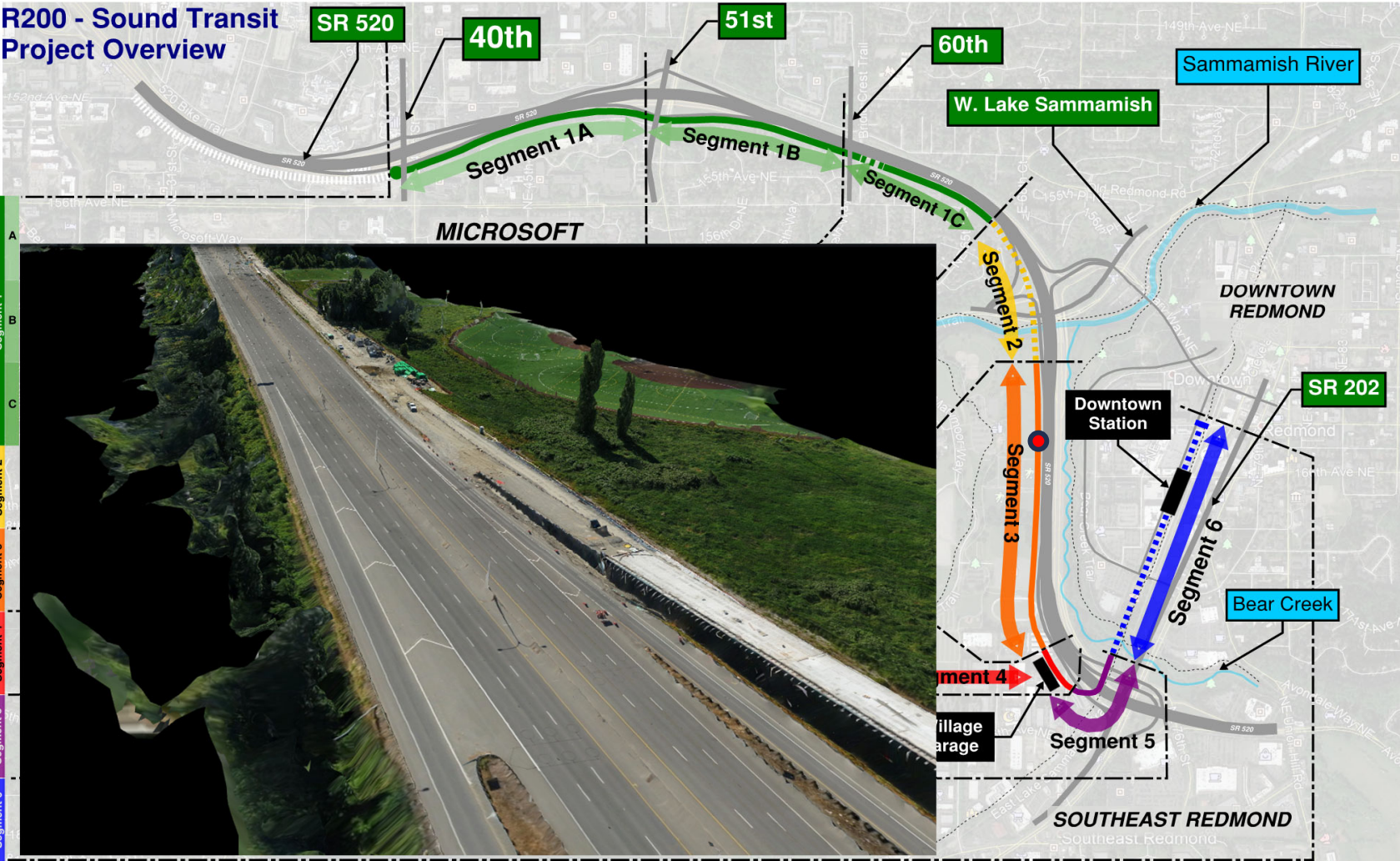



# R200 - Sound Transit Project Overview

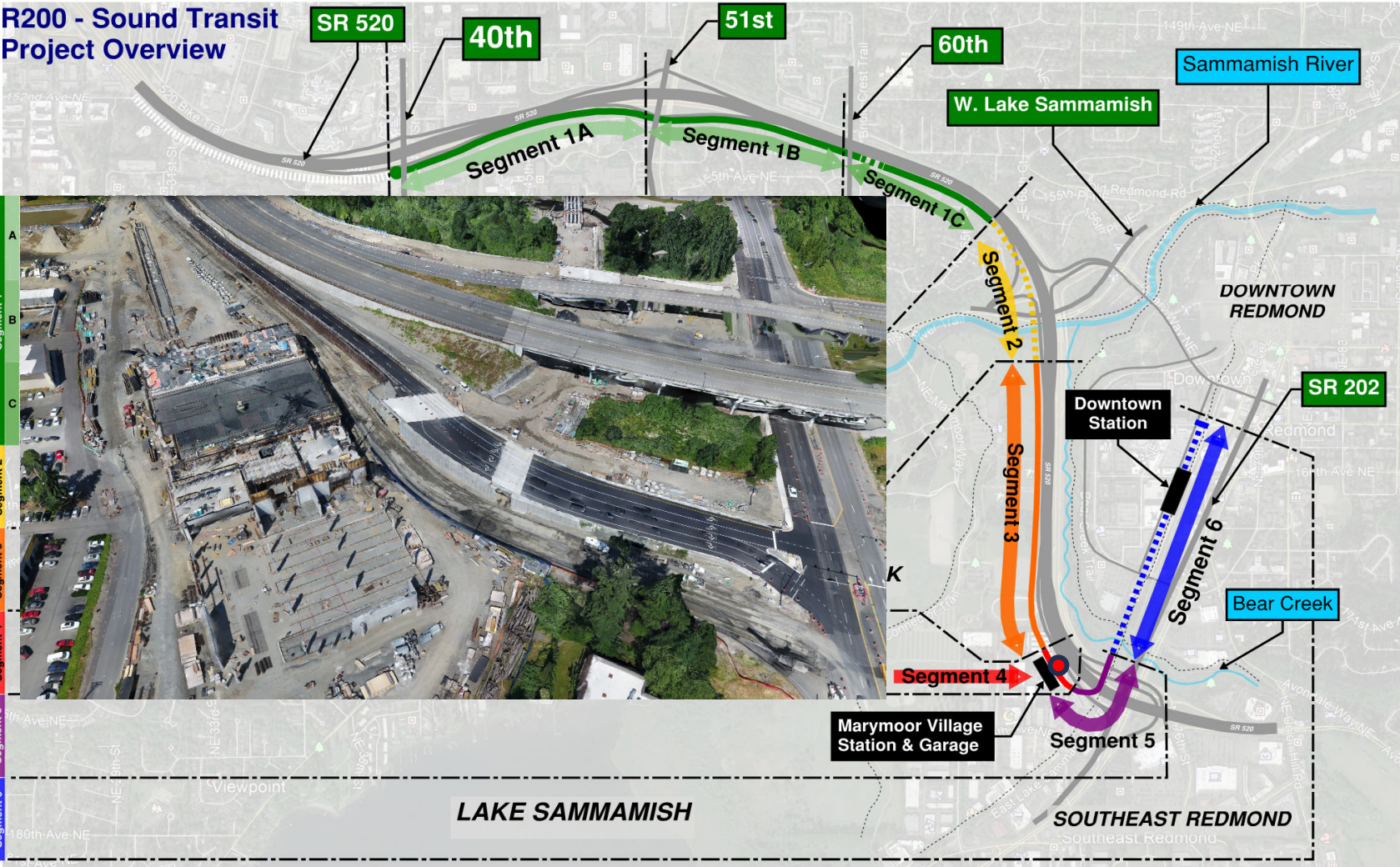



# R200 - Sound Transit Project Overview

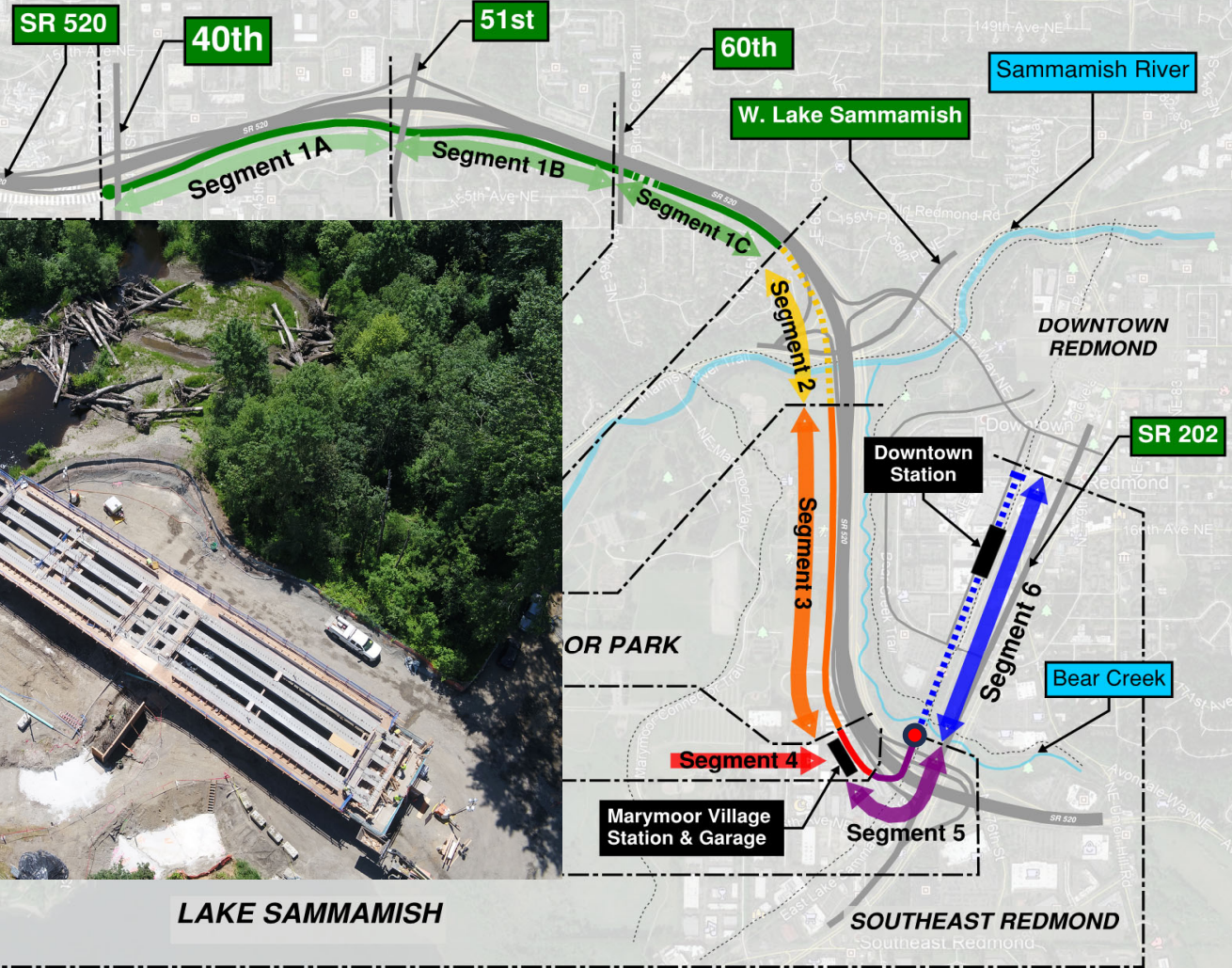

LAKE SAMMAMISH



# R200 - Sound Transit Project Overview

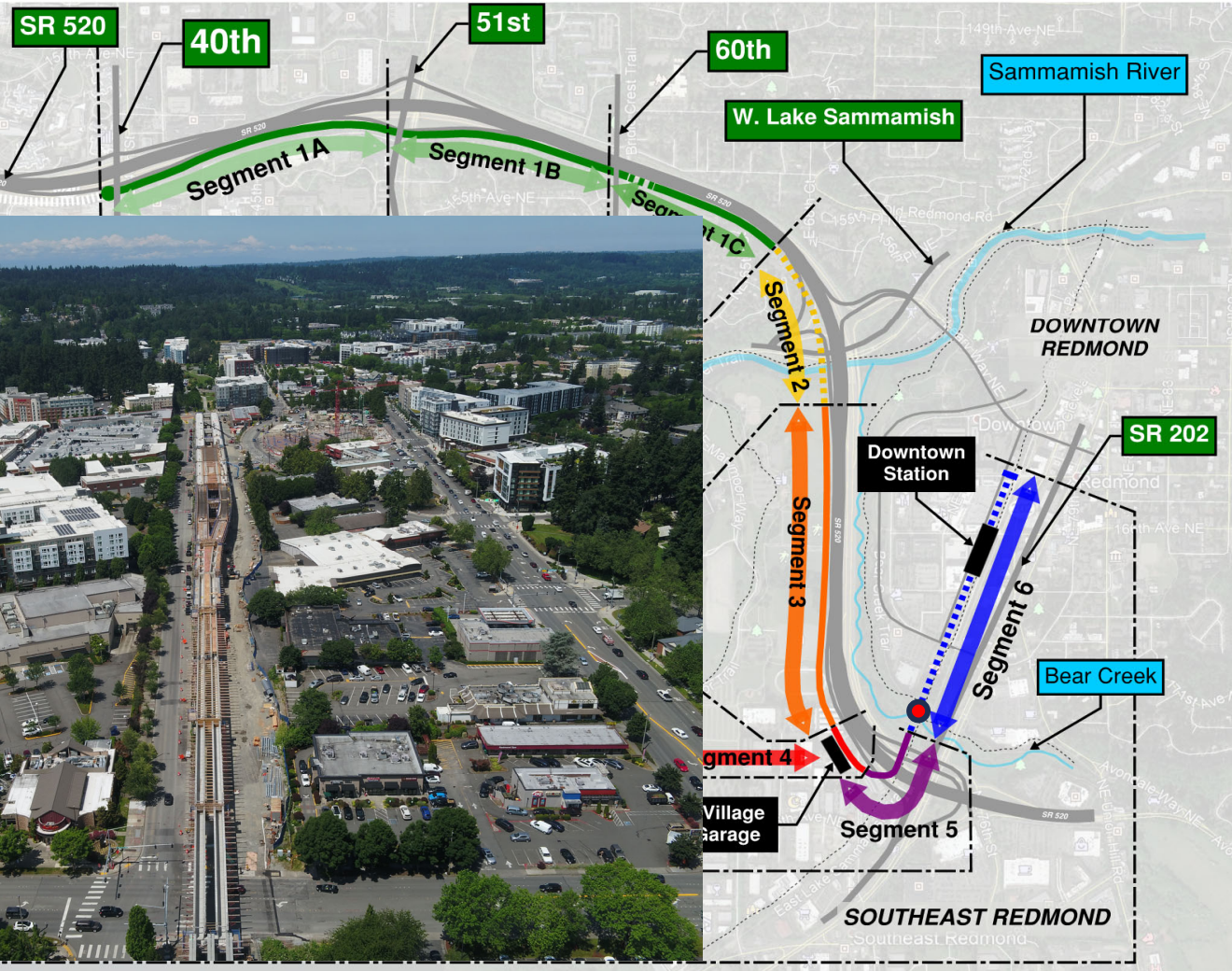



# R200 - Sound Transit Project Overview

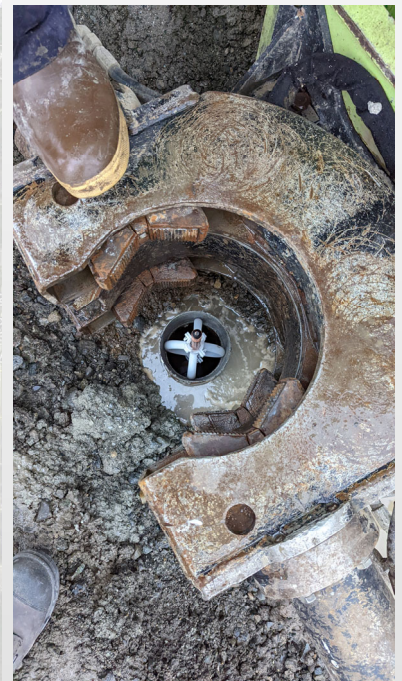
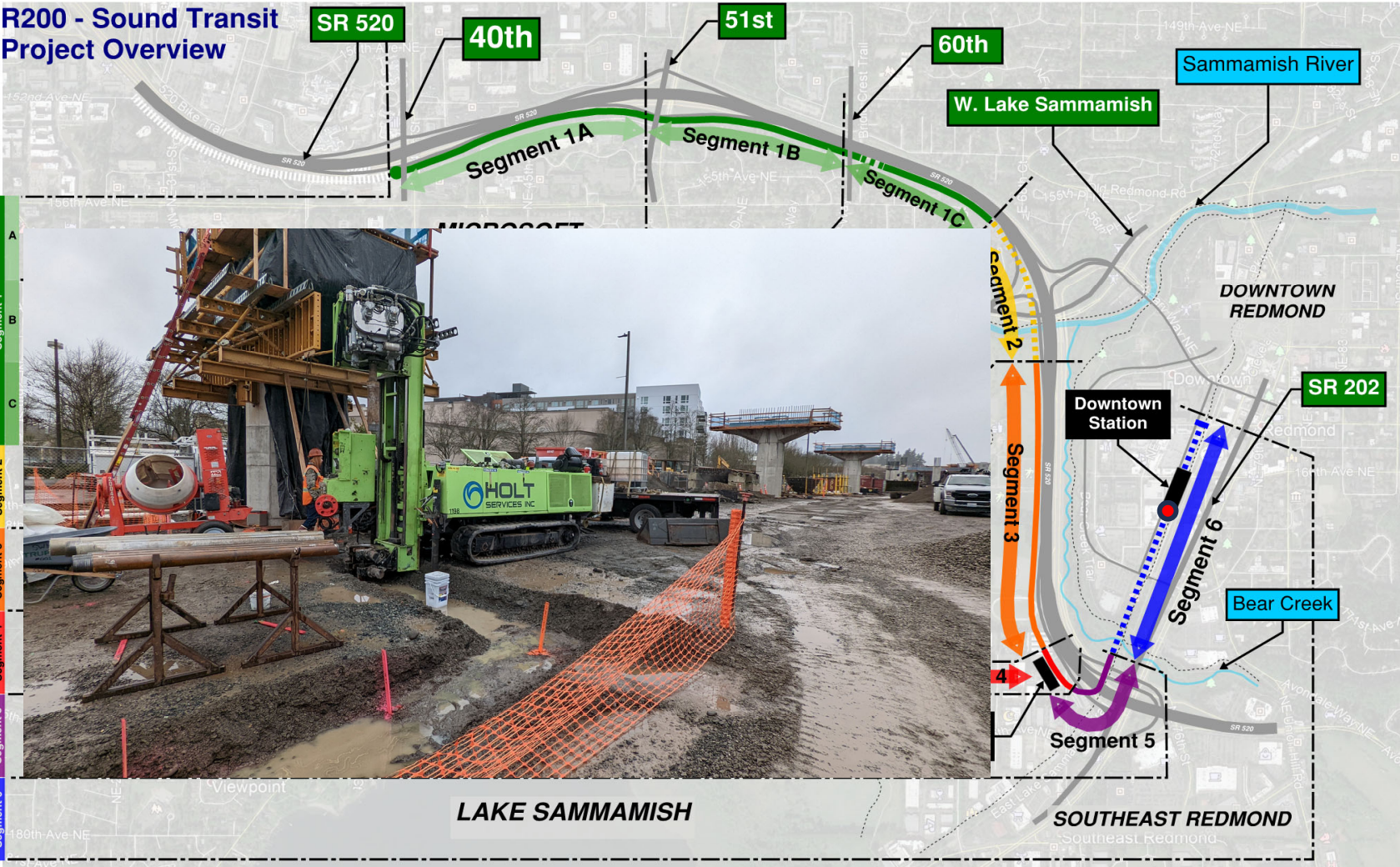



# R200 - Sound Transit Project Overview

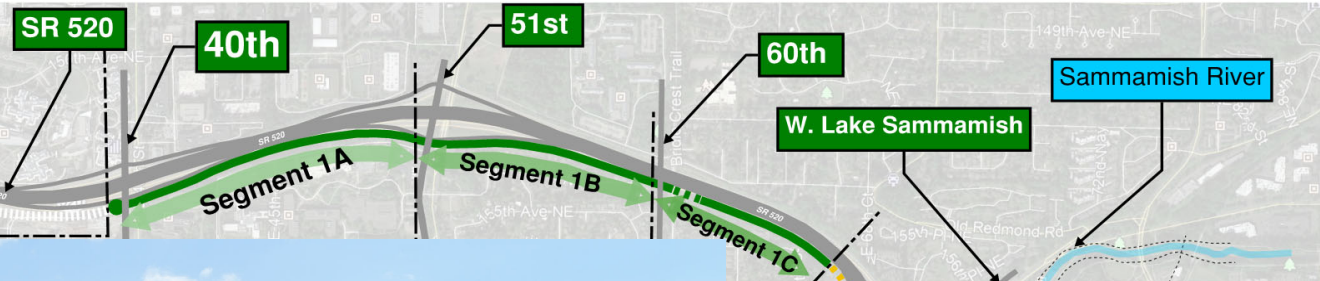



# R200 - Sound Transit Project Overview

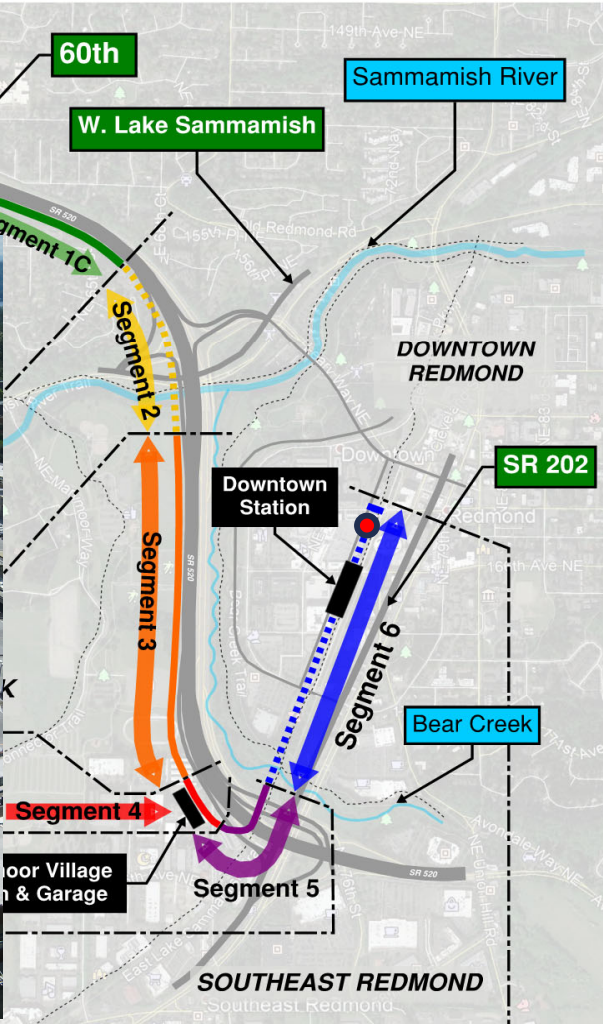
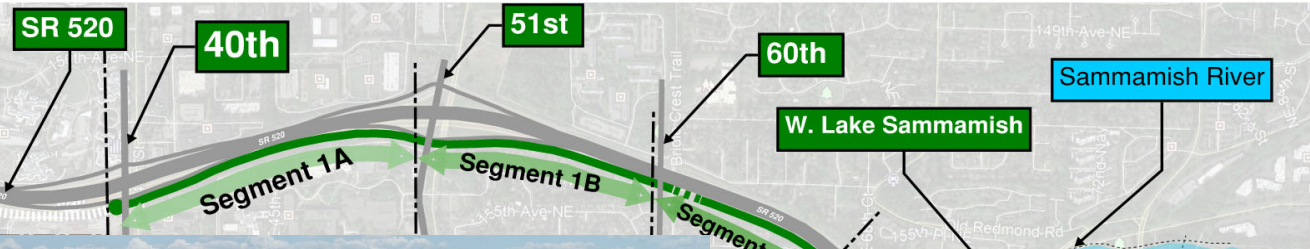

## ***Focus for next 12 month***

- Remaining Retaining Walls for at-grade guideway
- Both Superstructures for elevated guideway
- Begin Track work
- Begin OCS foundations and ductbank work
- Keep progressing the Garage & Downtown Station
- Installation of TPSS and Signal Houses and Communication Bungalows.
- Ready for Systems major operations

# *Community and Stakeholder Engagement*



# ***Good Neighbor Commitments***

Sound Transit is committed to being a good neighbor during construction. We work to manage impacts on surrounding communities by:

- Providing timely information
- Maintaining a safe construction site
- Keeping people moving
- Protecting the environment
- Maintaining a 24-hour Construction Hotline
- Outreach staff onsite, in the field



# Stakeholder Engagement

Jurisdictional Partner	Meeting Frequency
City of Redmond / Design and Construction Team City of Redmond / Real Property Team City of Redmond / Executive Team City of Redmond / Communications Team	Weekly Bi-weekly Monthly Weekly
WSDOT / Design and Construction Team WSDOT / Real Property Team WSDOT Executive Level WSDOT Communications Team	Weekly Weekly Bi-Weekly Monthly
King County / Design and Construction Team	As needed
King County Metro	As needed
Utilities	Weekly
Fire, Life Safety, and Security Committee (FLSSC)	Quarterly

# Engaging with the Community

Construction Alerts (4,500+ subscriptions)

Social Media (targeted and organic)

In-Person Events

Door-to-Door Outreach

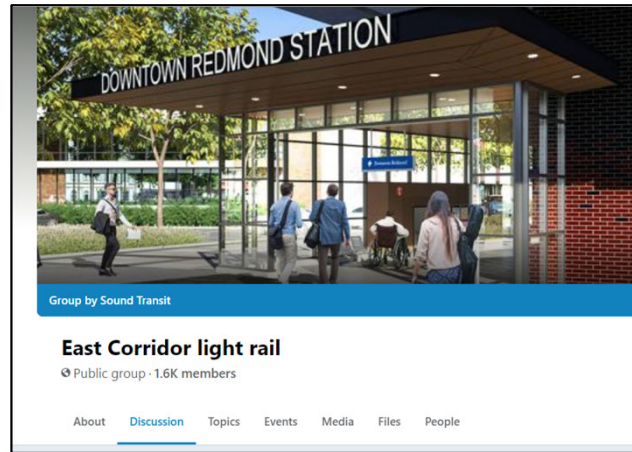
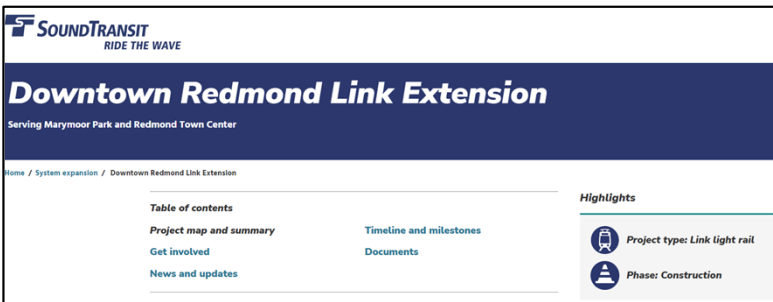
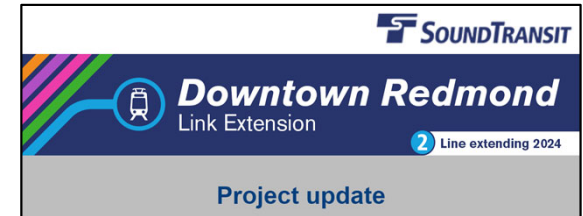

# Community Partnerships

Sound Transit is working with community-based organizations to engage new audiences

**Move  
Redmond**



**JERRY BAKER**  
M E M O R I A L  
**VELODROME**



# Collaboration Snapshot- NE 60th St Bridge

## *The Issue:*

How to maintain safe access for Ben Rush Elementary during construction?

## *Stakeholders:*

Sound Transit, the City of Redmond, Lake Washington School District and surrounding community



## *The Outcome:*

ST's contractor built a temporary bridge which was inspected by LWSD. Hundreds of students and families use the bridge to walk or roll to school

*Thank you.*



 [soundtransit.org](https://soundtransit.org)

