

Appendix F:
Presentation



Sound Transit East Link light rail

Mercer Island
Preliminary Engineering
Workshop

March 9, 2010

Agenda

- Opening Presentation - 6:00 p.m.
 - I. Meeting Purpose (Katie Kuciemba)
 - II. Project Status Update (Paul Cornish)
 - III. East Link Preferred Alternative (Paul Cornish)
 - IV. Key Features for Mercer Island (Paul Cornish)
 - V. Workshop Format Overview (Katie Kuciemba)
- Workshop continues - 6:30 p.m.
- Adjourn - 7:30 p.m.

Arriving at the Preferred Alternative

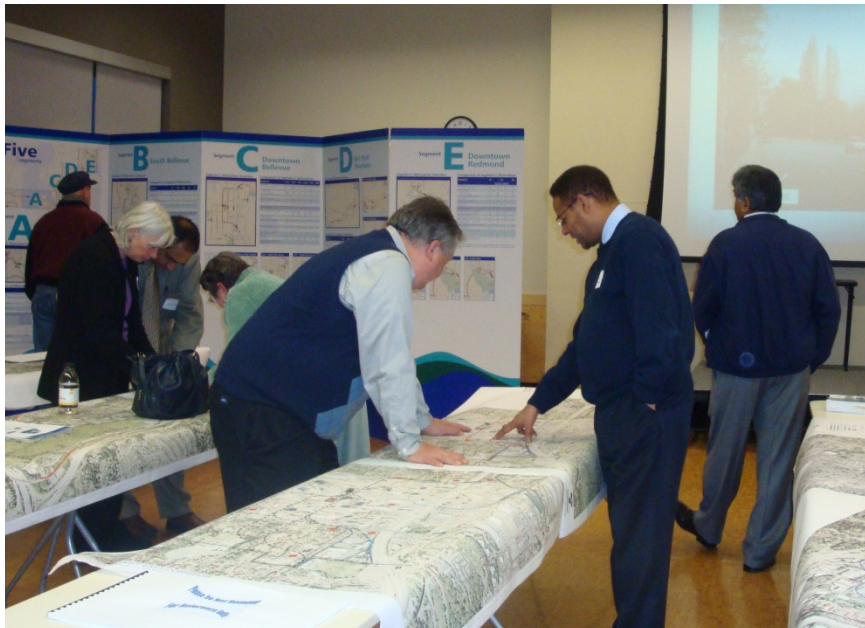

Mercer Island Open House

- Sound Transit published the Draft Environmental Impact Statement (EIS) on December 12, 2008
- Hosted five public hearings in Seattle, Mercer Island, Bellevue and Redmond
- Draft EIS public comment period
 - Mercer Island Light Rail Station Design Principles
- Preferred alternative identified by Sound Transit Board of Directors in May 2009

What's happening with East Link?



- Designing the East Link preferred alternative, including modifications recommended by the Sound Transit Board.
 - Preliminary engineering phase
- Collecting survey/geotechnical information
- Ongoing coordination with Mercer Island's Police, Planning, Transportation Department and City Council
- Preparing information for the Final Environmental Impact Statement

East Link Timeline

EIS Scoping	Fall 2006
Prepare Draft EIS	2007-2008
ST2 Approved by Voters	November 2008
Identify Preferred Route Alternatives	May 2009
Preliminary Engineering/FEIS	2009-2010
Identify Single Downtown Bellevue Preferred Alternative	April 2010
ST Board Selects Final Project	Early 2011
Final Design	2011-2013
Construction Starts	2013/2014
Service Starts	2020/2021
Public Meetings and Outreach is Continuous	

East Link Preferred Alternative



Seattle & Mercer Island

Seattle & Mercer Island (using I-90)



- Light rail will run on the existing I-90 center roadway
- Stations: Rainier Avenue in Seattle and Mercer Island
- New HOV lanes will be constructed on the I-90 outer roadways

At completion of East Link

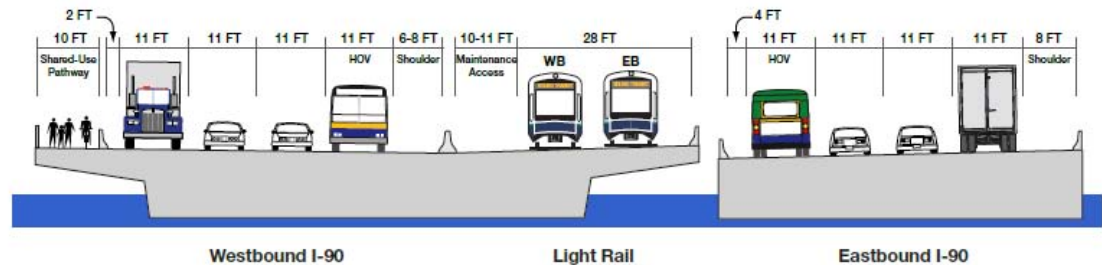

South Bellevue

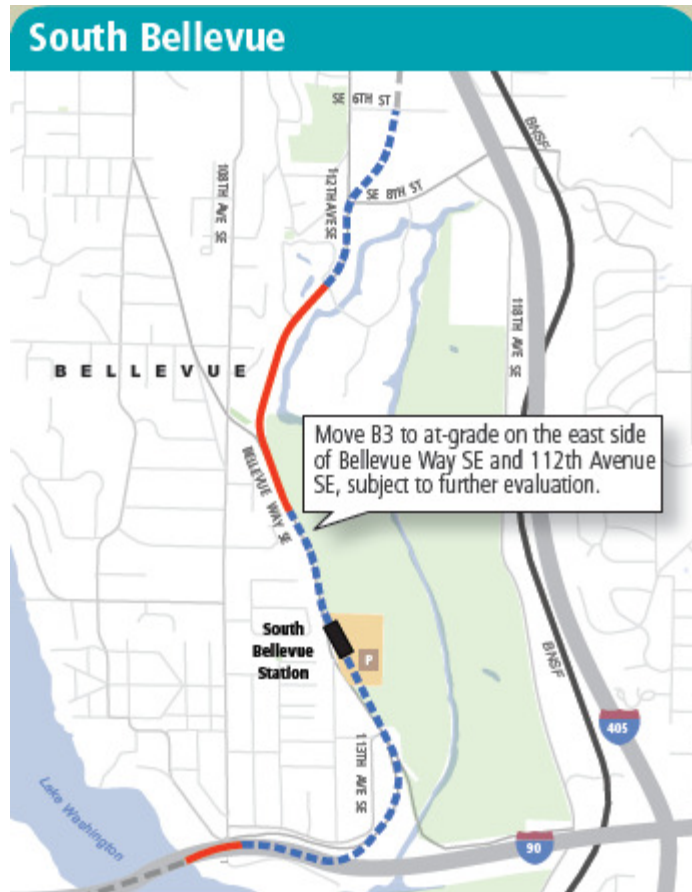

- Trains will run from I-90 north along Bellevue Way SE and 112th Ave. SE
 - Subject to further evaluation, the route will be on the east side of Bellevue Way and 112th Ave. SE
- South Bellevue Station with 1400 spaces and Park-and-Ride

Downtown Bellevue

Preferred Alternative (5/09) and Tunnel (Future Consideration)

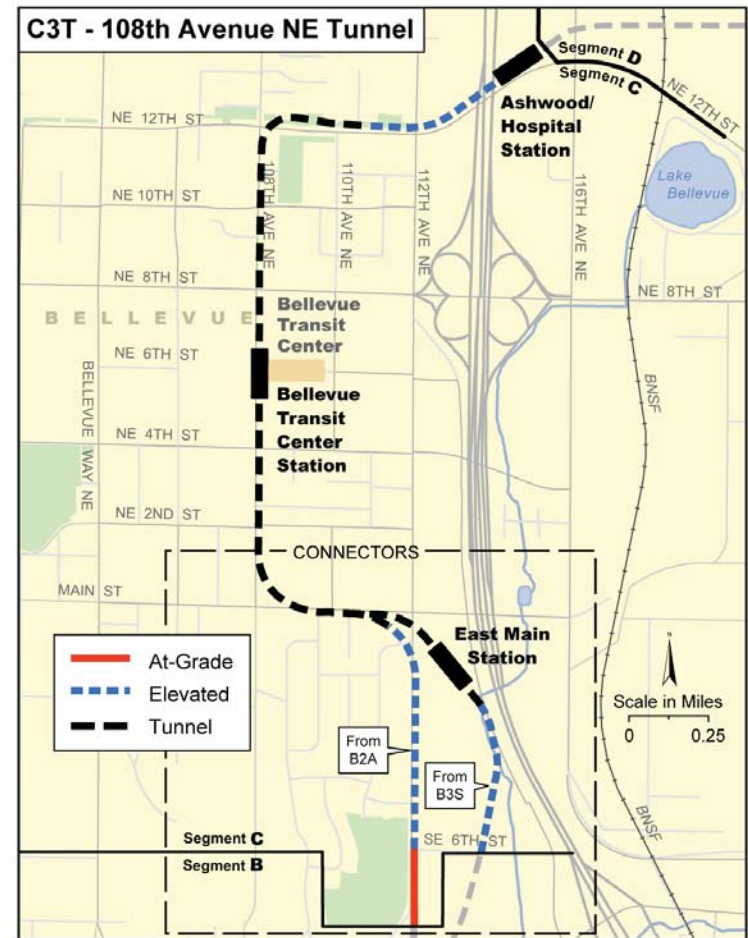
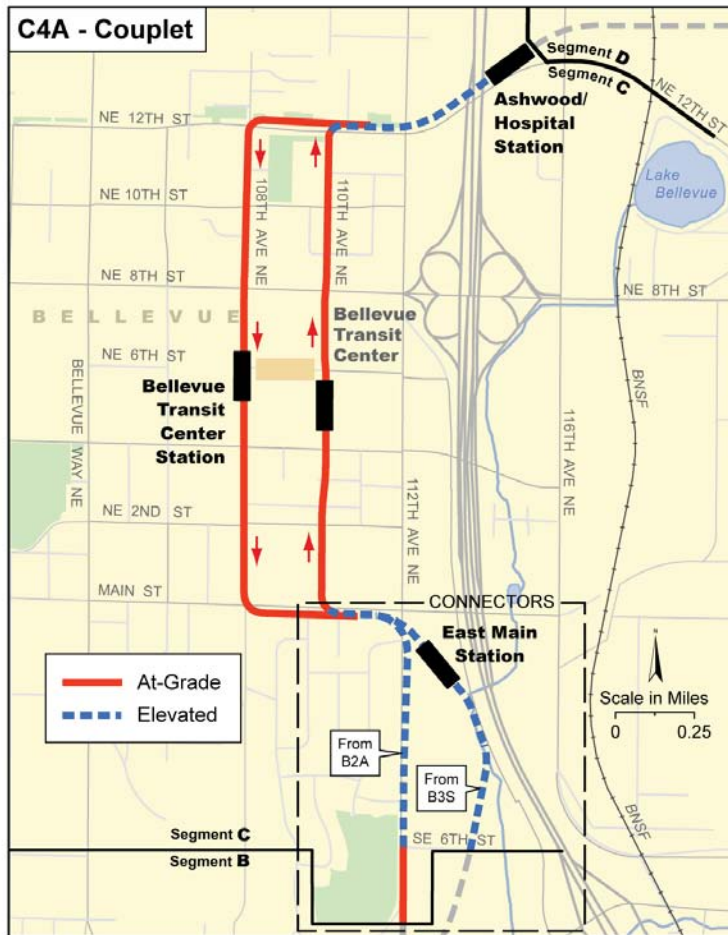

Bel-Red/Overlake Corridor



- Trains will serve the Bel-Red corridor, Overlake Village and Microsoft's campus
- 3 – 4 stations
- Alignment shifts to north side of NE 24th Street

Redmond



- Funding has not been approved for construction, however preliminary design and environmental study is funded
- Future route along State Route 520 and northern edge of Marymoor Park
- Stations: SE Redmond and terminal station near Redmond Town Center is under evaluation
- 1400 space Park-and-Ride

Key Features for Mercer Island

- **Station Access**

- 77th Ave. SE
- 80th Ave. SE

- **Station Features**

- Pedestrian & Bike Facilities
- Passenger Amenities



Mercer Island Station

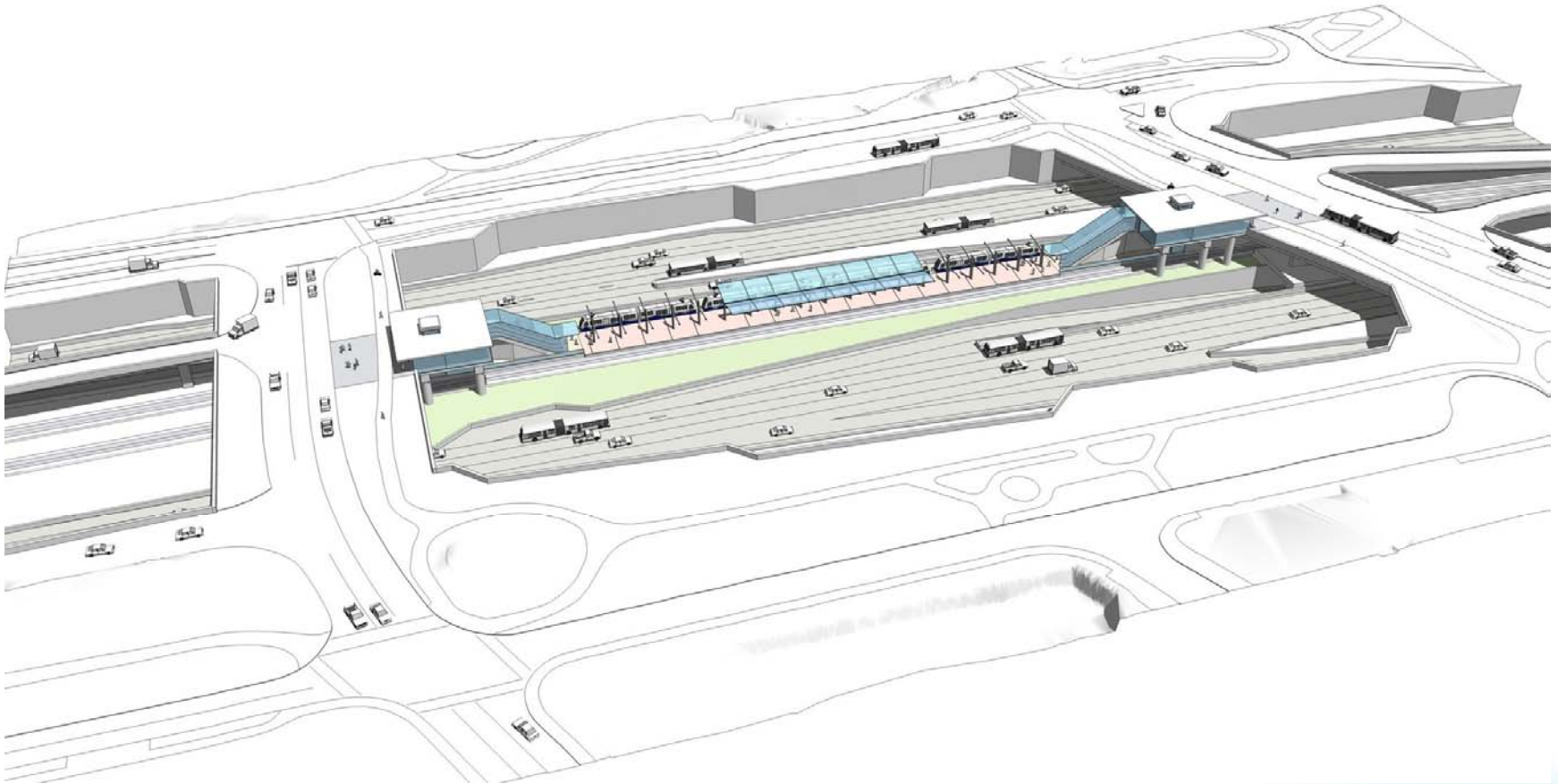

We Want to Hear from You!

- Preliminary Engineering Public Meetings (March – May 2010)
- Community and stakeholder briefings (ongoing)
- Project update mailings (ongoing)
- E-mail and web site updates (ongoing)



Questions?

Contact Katie Kuciemba,
Community Outreach Specialist

206-398-5459 or

eastlink@soundtransit.org