

WELCOME TO SOUTH BELLEVUE FINAL DESIGN

EAST LINK EXTENSION

The purpose of tonight's meeting is to:

- Present the final South Bellevue station, parking garage and corridor design plans
- Introduce the community to the artists selected for the South Bellevue station
- Provide an overview of traffic impact plans, share planning details, and review typical construction sequencing



Agenda

5-7 p.m. Open house

- Meet with project staff and view display boards and graphics featuring information about the final design plans for the South Bellevue segment of East Link

5:30 p.m. Overview presentation

7 p.m. Meeting adjourns



LIGHT RAIL ALIGNMENT

EAST LINK EXTENSION



Length: 14 miles

Ride times:

- Mercer Island to University of Washington: 20 minutes
- South Bellevue to Sea-Tac Airport: 50 minutes
- Overlake Transit Center to Bellevue Transit Center: 10 minutes

Rider projection: About 50,000 riders will use East Link every day by 2030

Budget: \$2.8 billion (2010 \$)

Start of service: Targeted 2023

2006-2011

Planning and environmental review

2011-2015

Final design
(we are here)

2015-2022

Construction

Targeted 2022

Testing & pre-operations

Targeted 2023

East Link in service



THE COLLABORATIVE FINAL DESIGN PROCESS

EAST LINK EXTENSION

Final design has been a collaborative effort between Sound Transit and project stakeholders including:

- Community members and neighborhood groups
- City of Bellevue
- City of Bellevue Light Rail Permitting Citizens Advisory Committee
- Other jurisdictional authorities, such as, Washington State Department of Transportation, emergency service providers, King County, and transit providers

Your input helped influence the station design elements, including:

- Station art reflective of the Mercer Slough natural environment
- Locating the northbound bus stop on Bellevue Way SE
- Preserving existing Cottonwood trees surrounding the park & ride
- Additional trees planted west of the station for screening
- Platform windscreens oriented to protect waiting passengers



Nov 2014

SOUTH BELLEVUE SEGMENT OVERVIEW

EAST LINK EXTENSION



Benefits:

- Provides access to high quality, frequent transit service that operates 20 hours per day
- Approximately 4,500 daily boardings (2030)
- Increases travel options for South Bellevue residents and employees, consistent with City of Bellevue transportation goals
- Expands the South Bellevue Park-and-Ride to approximately 1,500 stalls
- Bus transfer, layover areas and bicycle access.

Travel times (from South Bellevue Station)

- International District/Chinatown = 14 minutes
- University of Washington = 24 minutes
- Sea-Tac Airport = 50 minutes (with transfer at International District Station)
- Overlake Transit Center = 16 minutes



Nov 2014

SUSTAINABILITY

EAST LINK EXTENSION

Sound Transit's regional public transit system creates easy connections to more places for more people. We are committed to leaving the planet a better place.

Our framework for sustainability:

- **People** Help people move freely by increasing the availability and use of regional transit
- **Planet** Promote environmental stewardship and conserve natural resources
- **Prosperity** Maximize agency efficiency and enable people and businesses to save time and money

Sound Transit is always looking for ways to apply sustainable principles to our projects, including using renewable construction materials, natural drainage solutions and maximizing natural light at stations.

Sustainability measures in South Bellevue:



Stream enhancements near Coal Creek.



Reuse, salvage and recycle construction materials and debris.



Keep water clean by using bio-retention and infiltration drainage solutions.



Inventory migratory bird nests to minimize disruption during construction.

KEEPING YOU MOVING

EAST LINK EXTENSION

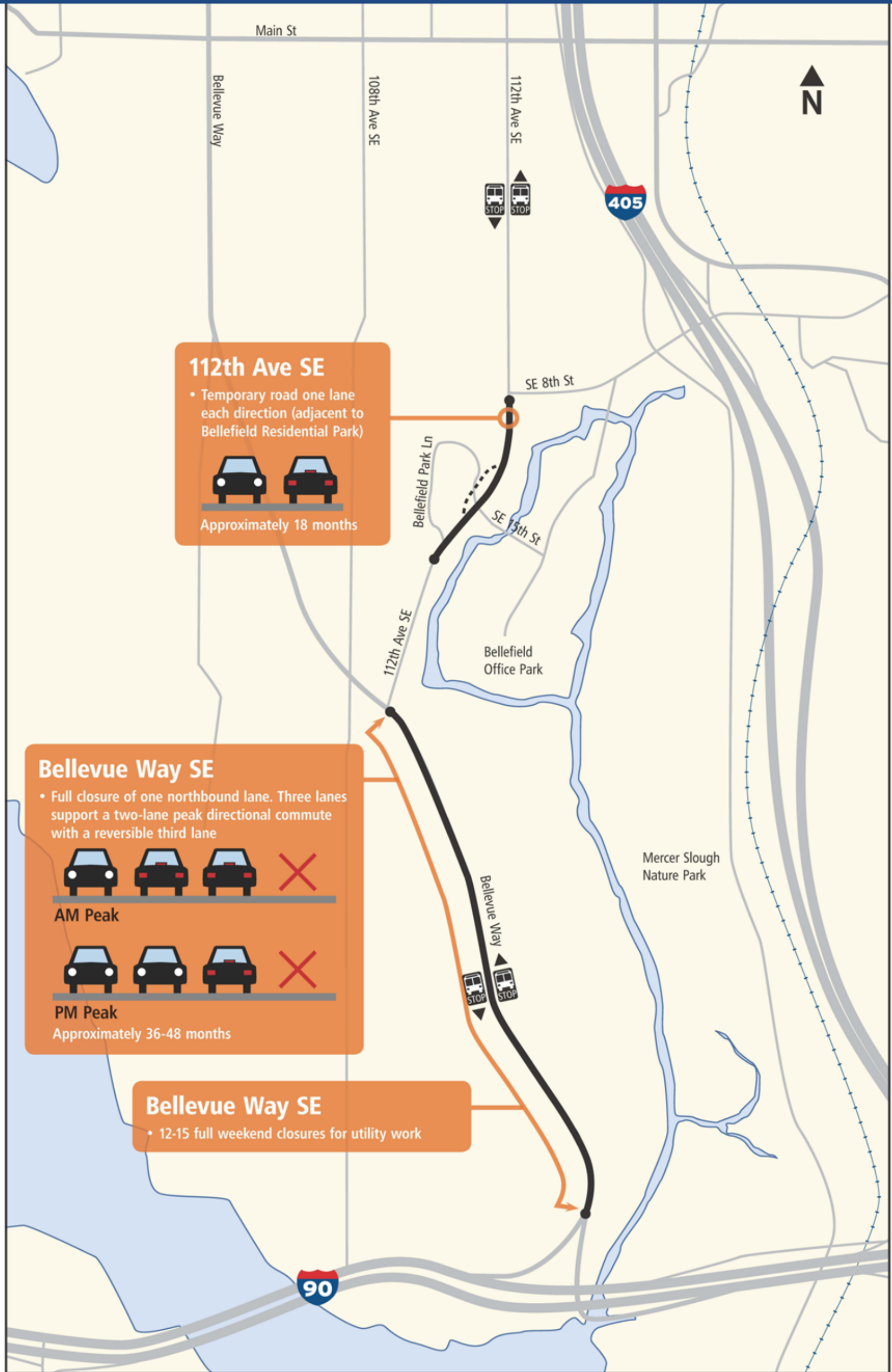

CONCURRENT PROJECTS 2014-2022

EAST LINK EXTENSION



CONSTRUCTING THE SOUTH BELLEVUE STATION

EAST LINK EXTENSION

Starting in 2016, the South Bellevue park-and-ride will become an active construction zone and no longer accessible to the public. The new 1,500 stall South Bellevue park-and-ride garage will open after approximately 5 years of construction.

- The South Bellevue park-and-ride will serve as the construction hub for building the light rail station, track, and 1,500-stall parking garage and staging equipment.
- Sound Transit is working to identify alternate options for park-and-ride users, including directing riders to underused park-and-rides, leasing parking space from community churches, and potentially constructing a new off-site parking facility.

2016

2023

Approximately 5 years of construction

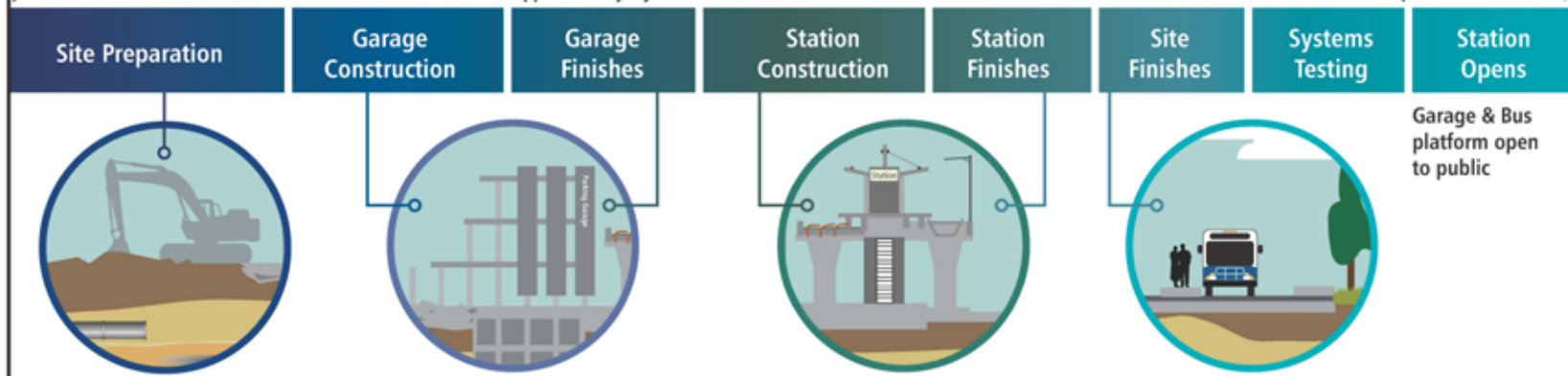

Garage & Bus platform open to public

Crews will only access the site from the west to avoid impacting the Mercer Slough.



22,000 cubic yards of concrete poured to build the garage and station – enough to fill seven Olympic size swimming pools.



Excavate 100,000 cubic yards Fill 110,000 cubic yards



The unique soil conditions of the Mercer Slough require excavating 100,000 cubic yards of earth from the site and hauling in 110,000 cubic yards of new fill dirt.

The park-and-ride will be closed for 5 years, reduced from the original estimate of 7 years.

210 drilled shafts that average 50-90' deep or approximately 3 miles in total combined length.

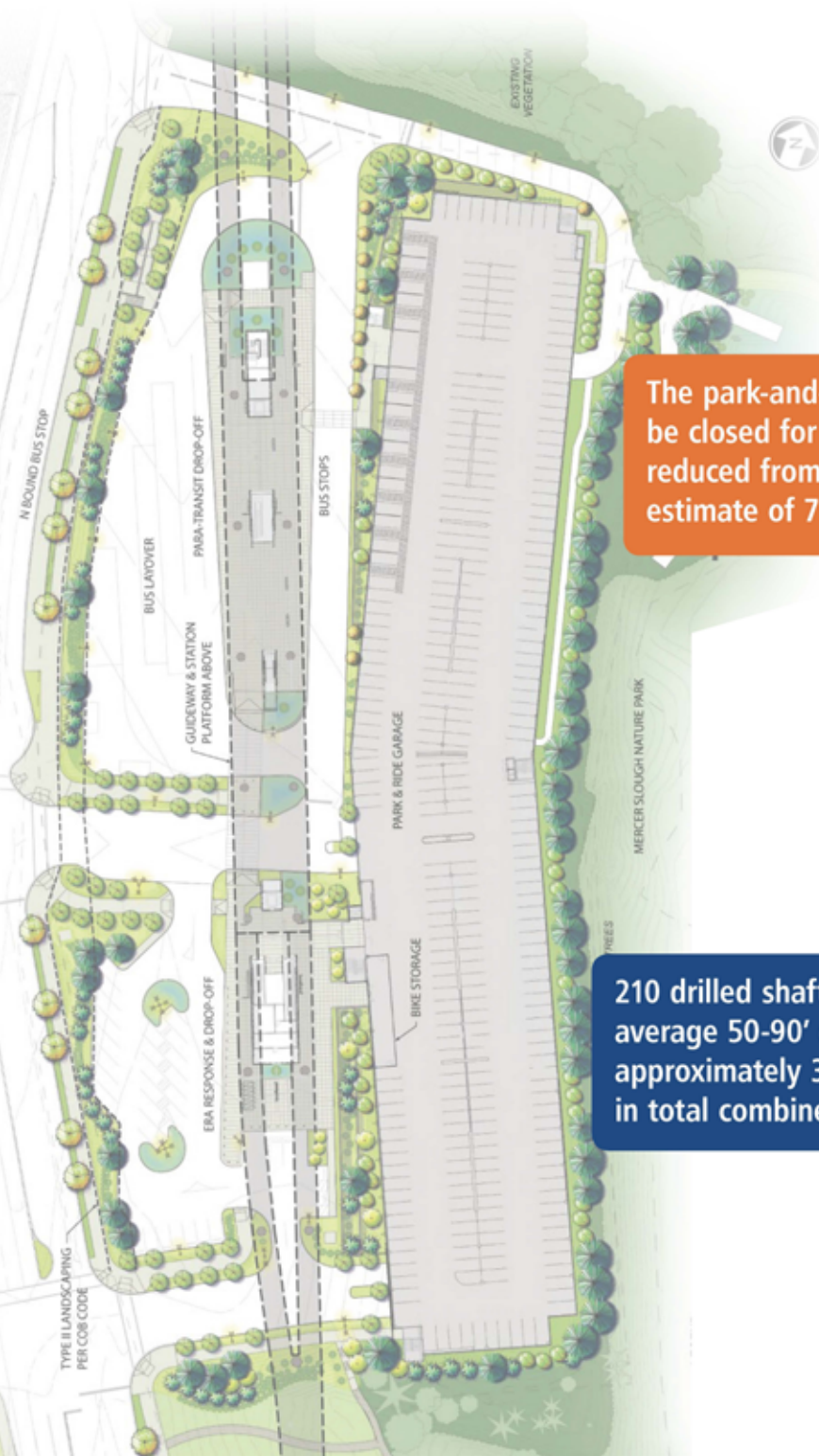

SOUTH BELLEVUE STATION – VICKI SCURI, ARTIST

STATION FRONT APPROACH ART OPPORTUNITY - EAST LINK EXTENSION

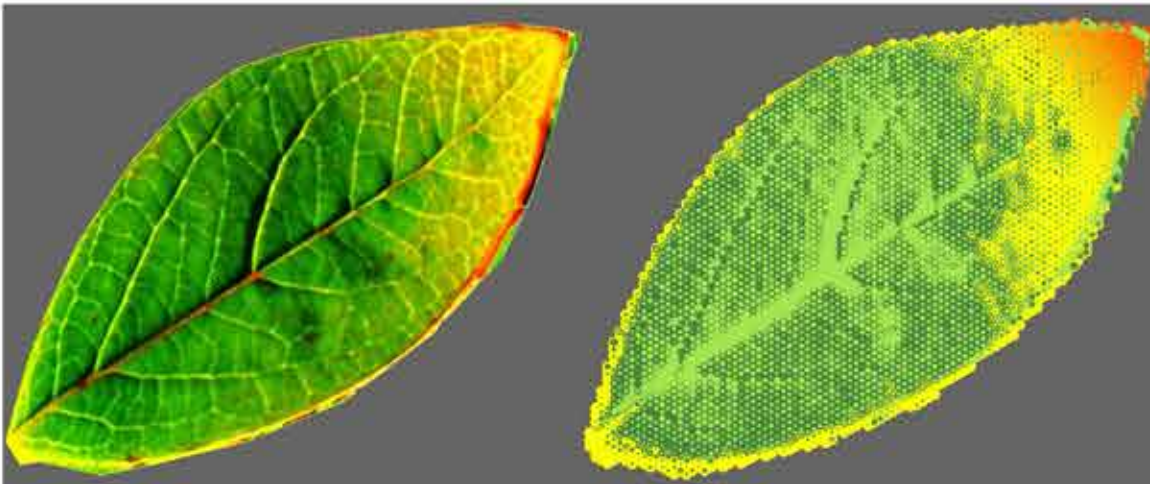

Leaf images are abstracted into hexagonal patterns to play off the faceted shape of the elevated station columns. The hexagon is a shape frequently found in nature, from bee hives to turtle shells.

"My practice specializes in infrastructure as public place, because infrastructure, best symbolized as the backbone of urban design, is the system upon which society builds its core values, creating meaning, mobility and connectivity."

– Vicki Scuri

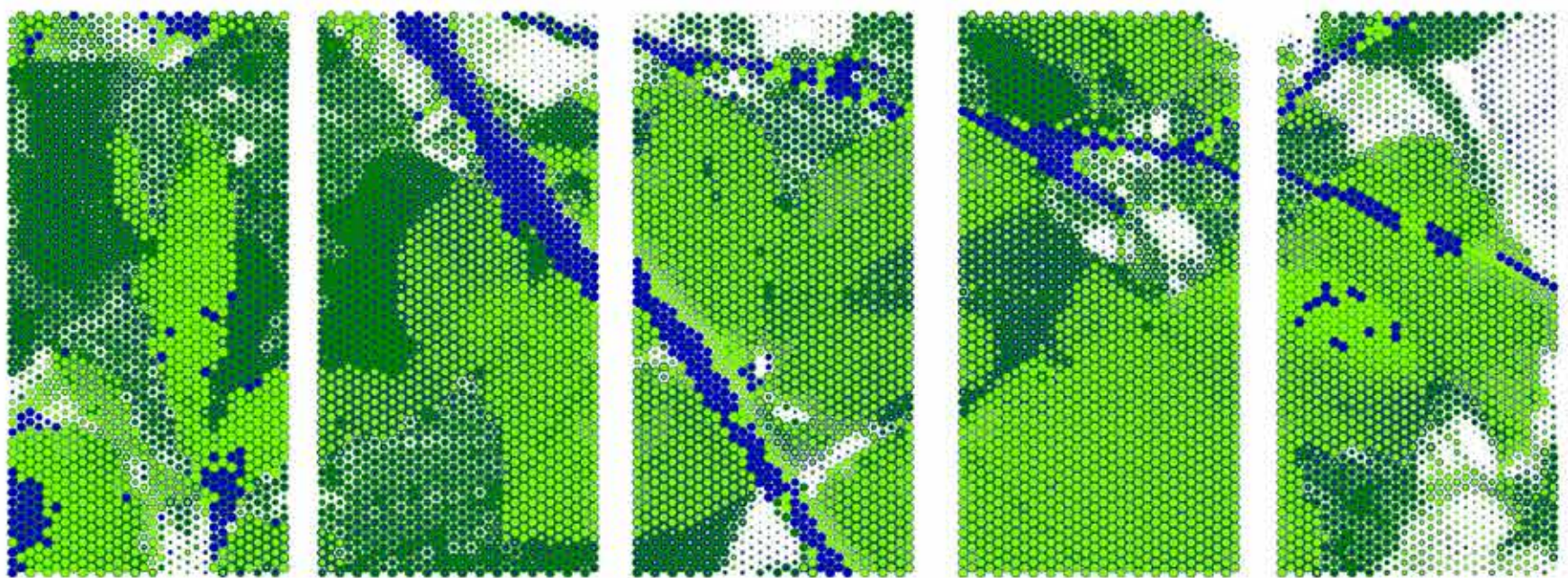

ACOUSTIC PANELS DESIGN: Hundreds of feet of unique patterns can be created from the five initial designs.



Inspired by light pouring through the plant canopy at Mercer Slough, Scuri abstracted leaf shapes for patterns on the acoustic panels and station columns. Glass patterns are under consideration.



SOUTH BELLEVUE STATION – KATY STONE, ARTIST

GARAGE ART OPPORTUNITY - EAST LINK EXTENSION



"Evoking natural forms and processes, both familiar and fantastical, the images are just a step away from dissolving into masses of line or shape."

– Katy Stone

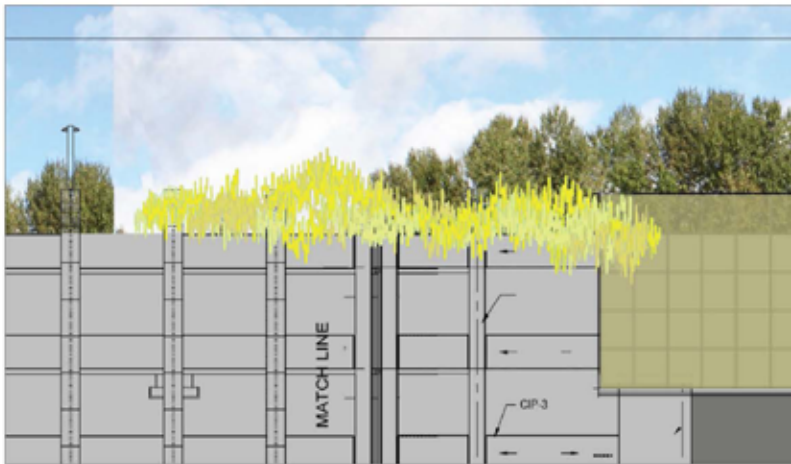

Stone's cattail inspired sculpture is carefully sited along the top edge of the garage for prime viewing by passengers both waiting and riding the train.

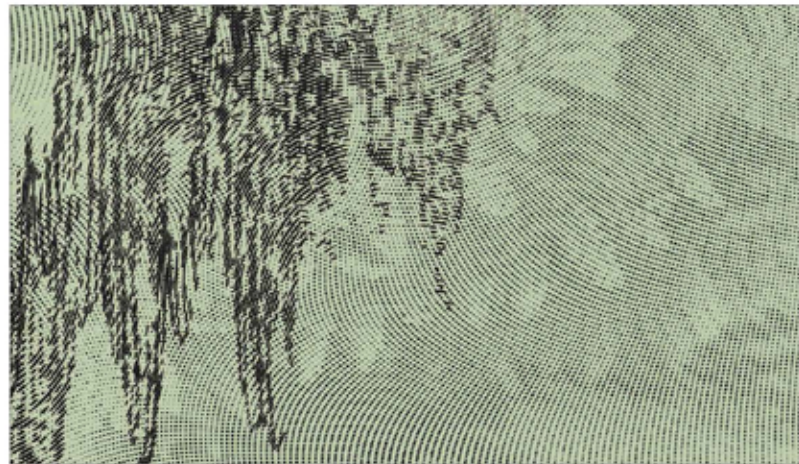

Stone is collaborating with architects Perkins + Will in designing a willow-inspired perforation pattern for the metal screening on the west side of the garage, that captures the motion in nature

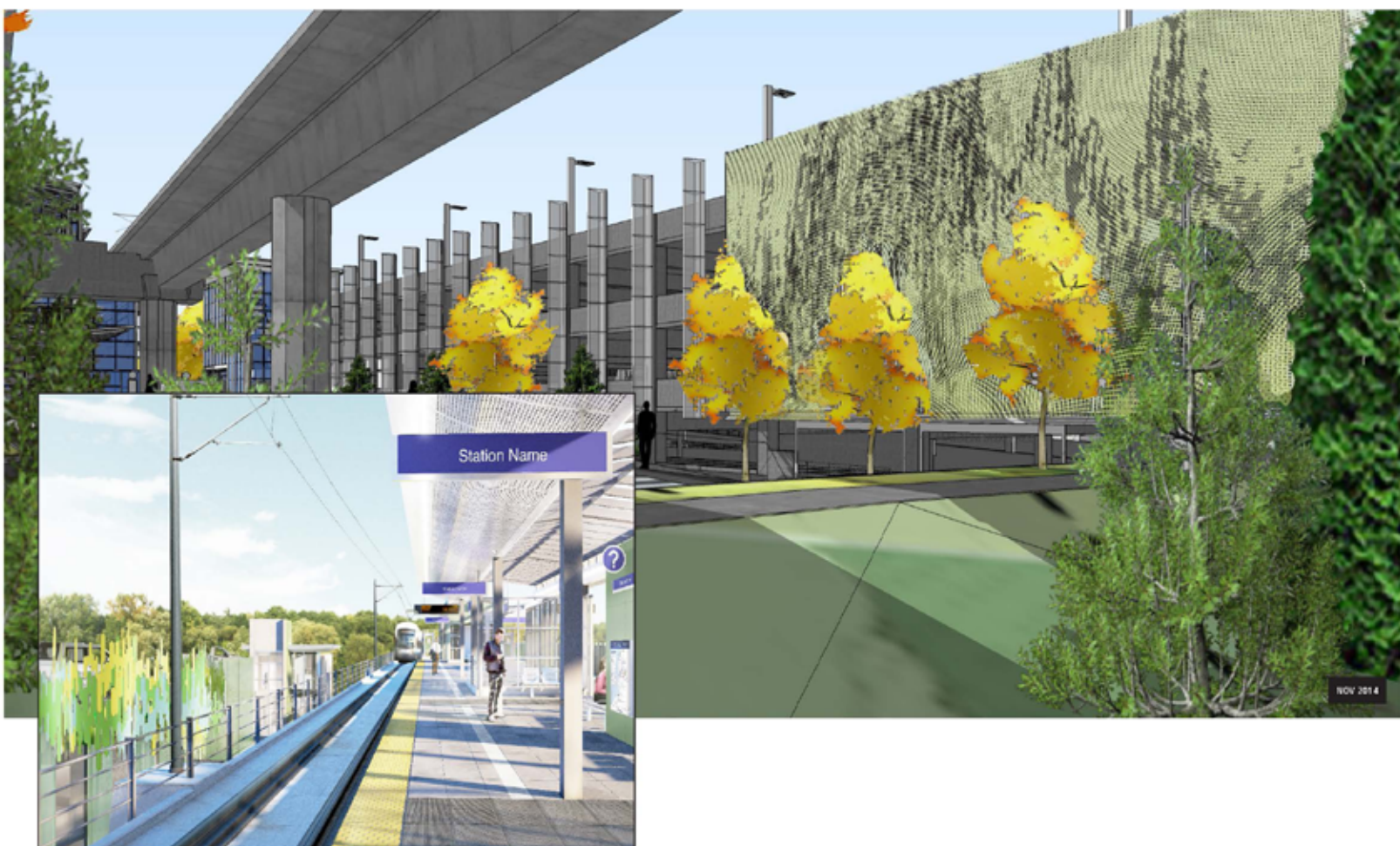

SOUTH BELLEVUE STATION – ARTIST PAST WORKS

EAST LINK EXTENSION



Artists Vicki Scuri and Katy Stone have each spent many hours at Mercer Slough, absorbing the colors and textures of the nature park.

Both artists bring the essence of nature to the human experience of moving through the built environment, as seen in their past work.

Rather than imitating, the artists take inspiration from the natural world.

VICKI SCURI, ARTIST - PAST WORK



KATY STONE, ARTIST - PAST WORK

SOUTH BELLEVUE STATION - LANDSCAPE PLAN

EAST LINK EXTENSION

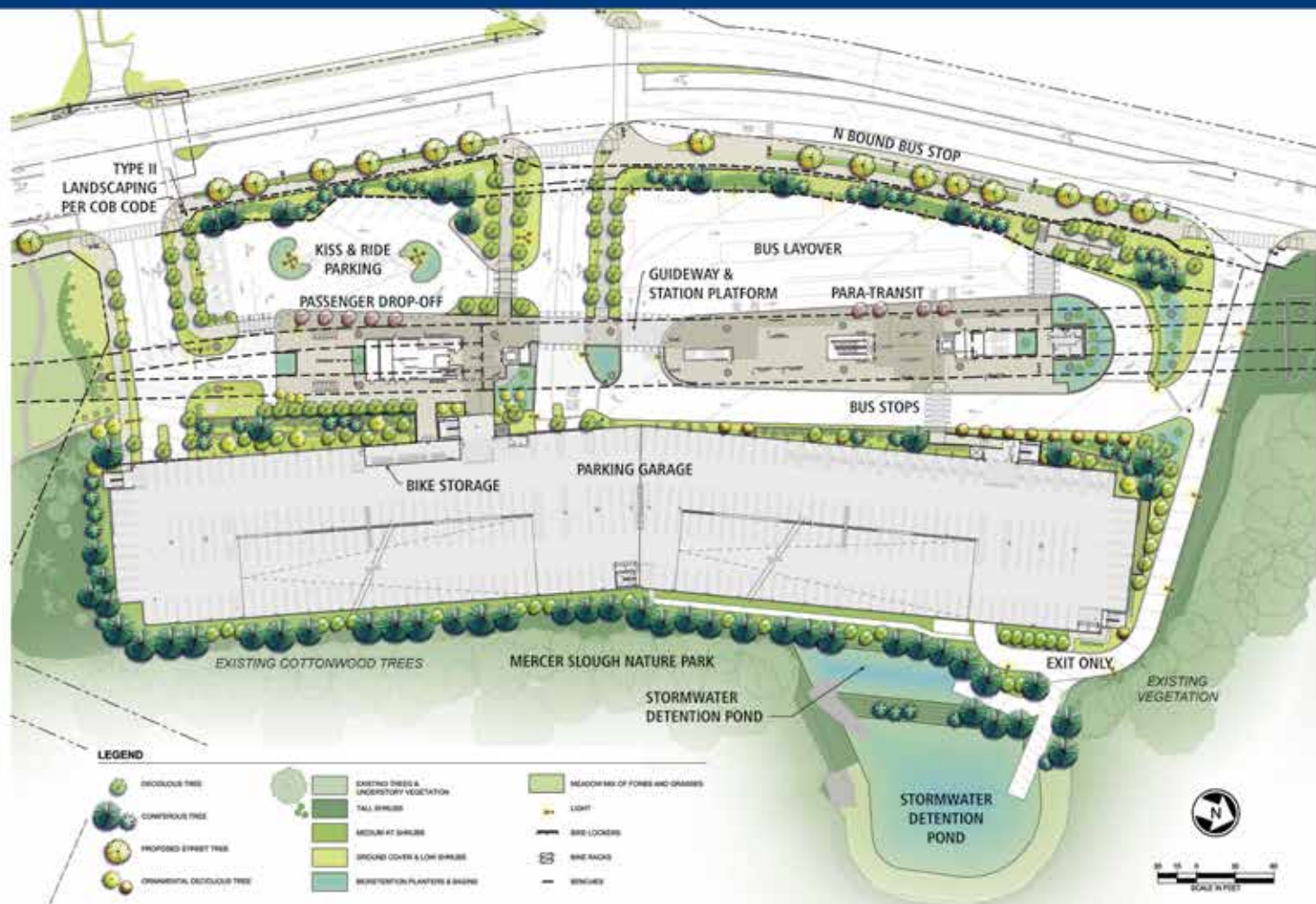

SOUTH BELLEVUE STATION - PLATFORM AND GRADE LEVEL PLANS

EAST LINK EXTENSION

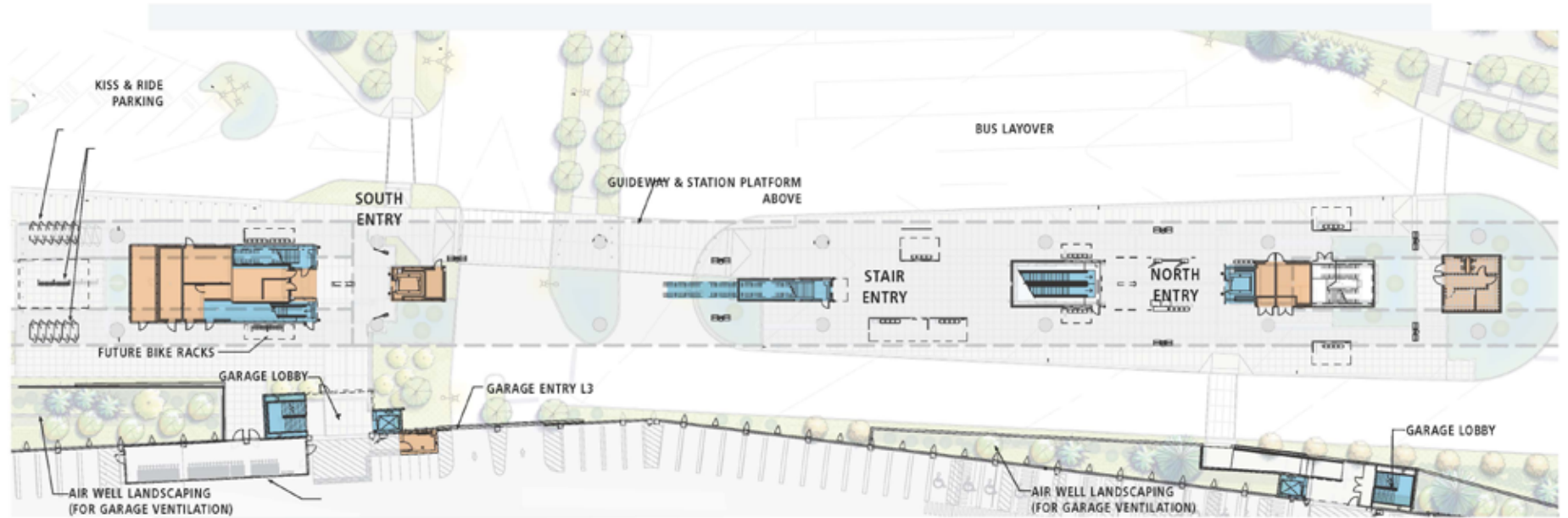
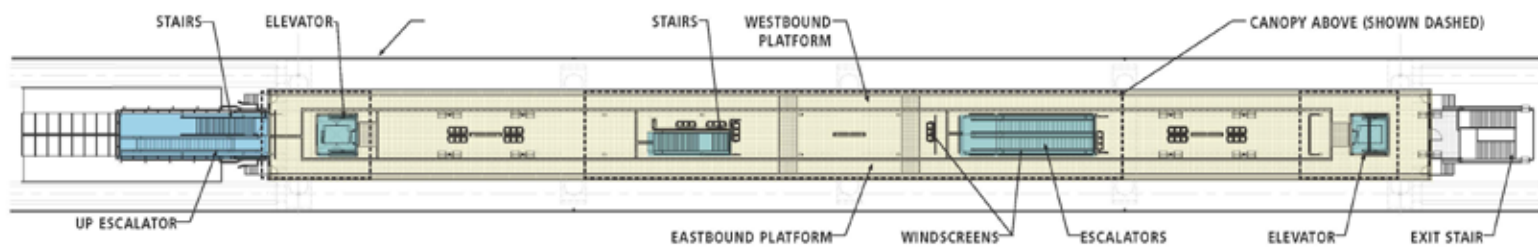

LEGEND

PLATFORM	
SERVICE	
PUBLIC CIRCULATION	

SOUTH BELLEVUE STATION - GARAGE AND ROOF LEVEL PLANS

EAST LINK EXTENSION

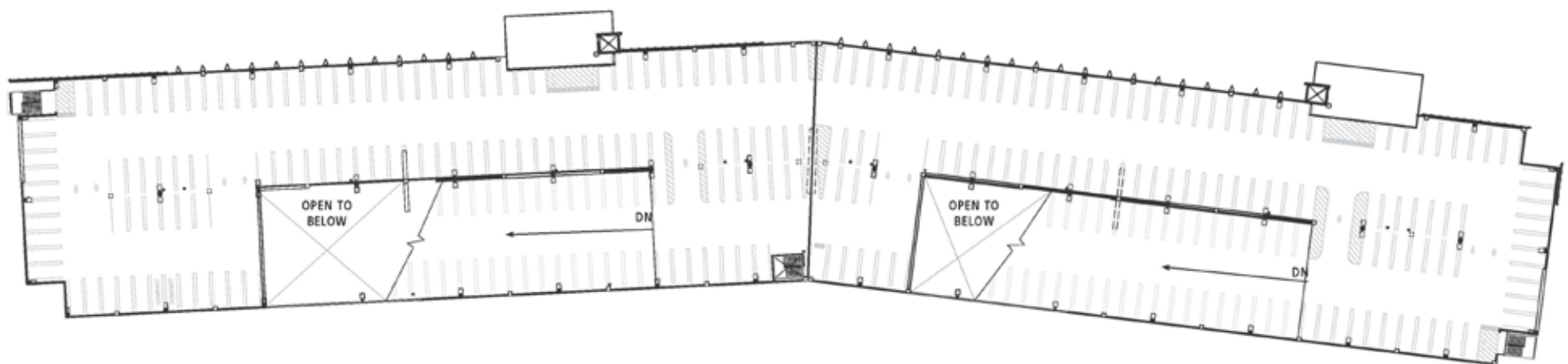
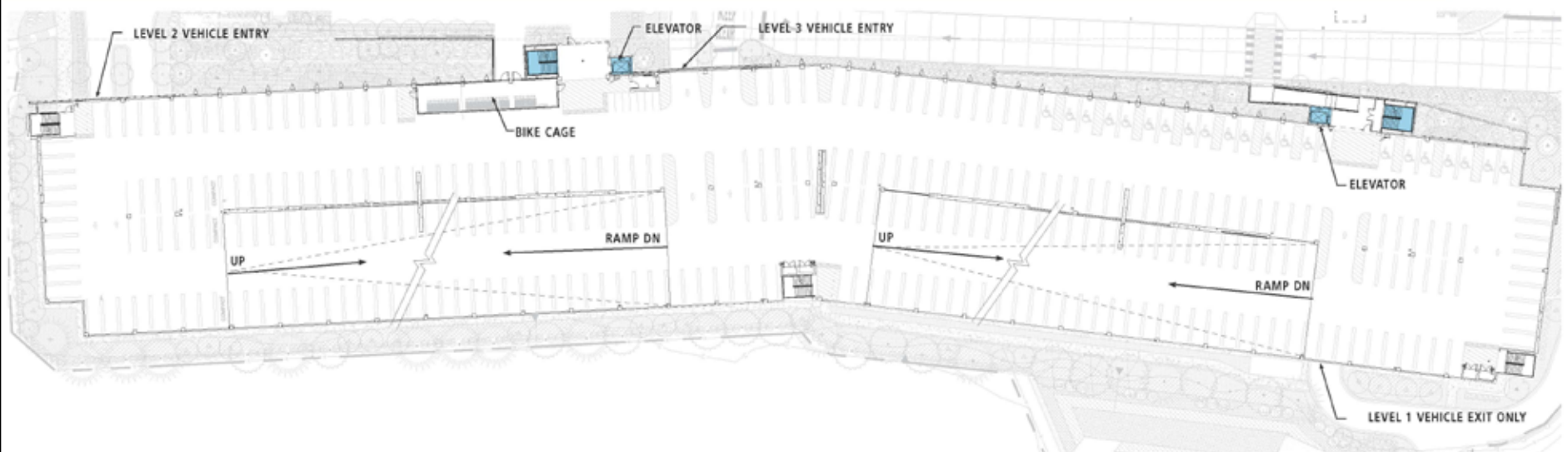

SOUTH BELLEVUE STATION - PLATFORM LOOKING SOUTH

EAST LINK EXTENSION



SOUTH BELLEVUE STATION - GARAGE SOUTH ENTRY

EAST LINK EXTENSION



SOUTH BELLEVUE STATION - NORTH ENTRY

EAST LINK EXTENSION



SOUTH BELLEVUE STATION - BUS PLATFORM

EAST LINK EXTENSION



SOUTH BELLEVUE STATION - SOUTH ENTRY

EAST LINK EXTENSION



May 2014

 **SOUNDTRANSIT**
RIDE THE WAVE