

DWG INFO:
 LTSCALE:
 1=1
 XREFs:
 -Attach:
 -Overlay:
 ELD_L75_KA-Interim
 ELD_L75_KA-Interim-100
 SUB-SDEIS
 ZG-2234H
 key_Segment
 x0531rx
 x0534rx
 x0831rx
 x0834rx
 x1131rx
 x1134rx
 x1431rx
 x1434rx
 x1437rx
 x1731rx
 x1734rx
 x1737rx
 x1740rx
 x2037rx
 x2040rx
 -Unresolved:
 ELD_L75_KA
 ELD_L75_KX-Interim

1
2
3
4
5

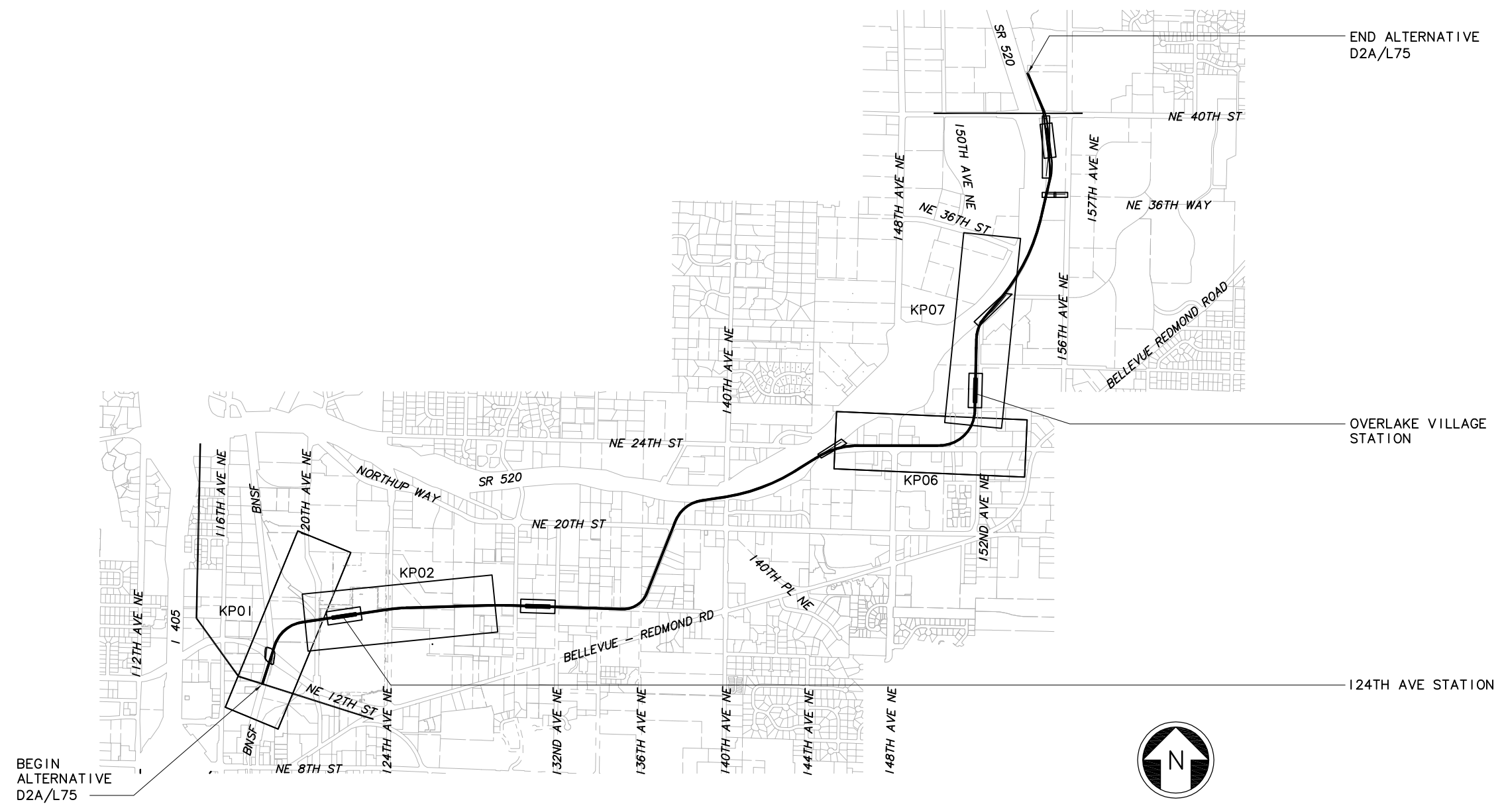

c:\work\sdeis\ELD_ID2AAGZ05.dwg
 10/08/10 09:45 : bolimaf OE6579

No.	Date	Dsn.	Chk.	App.	Revisions

Designed By:
 Drawn By:
 Checked By:
 Approved By:

FEIS CONCEPTUAL

CH2MHILL

Submitted: _____ Date: _____ Approved: _____

Grijalva
 ENGINEERING

BOLIMA
 DRAFTING & DESIGN INC.

Date: _____ Approved: _____

SOUNDTRANSIT

Date: _____

Scale: NTS
 Filename: ELD_ID2AAGZ05.dwg
 Contract No.:
 Date: 07/30/10

LINK LIGHT RAIL PROJECT
 EAST CORRIDOR
 SEGMENT D - ALT D2A
 NE 24TH STATION & NE 24TH DESIGN OPTION
 KEY PLAN

Drawing No.: D2AA-GZ05
 Sheet No.: D-26
 Rev.: _____

DWG INFO:
 L1SCALE:
 I=1
 XREFs:
 -Attach:
 -Overlay:
 ELD_L75_CA_Intrim
 ELD_L75_CM_Intrim
 ELD_L75_JO
 ELD_L75_KA_Intrim-100
 KEY_SEGMENT
 ZG-2234H
 ZG-010010
 x0531rx
 x0531sf
 x0534rx
 x0534sf
 x0831rx
 x0831sf
 x0834rx
 x0834sf
 x1405_chon
 -Unresolved: 2

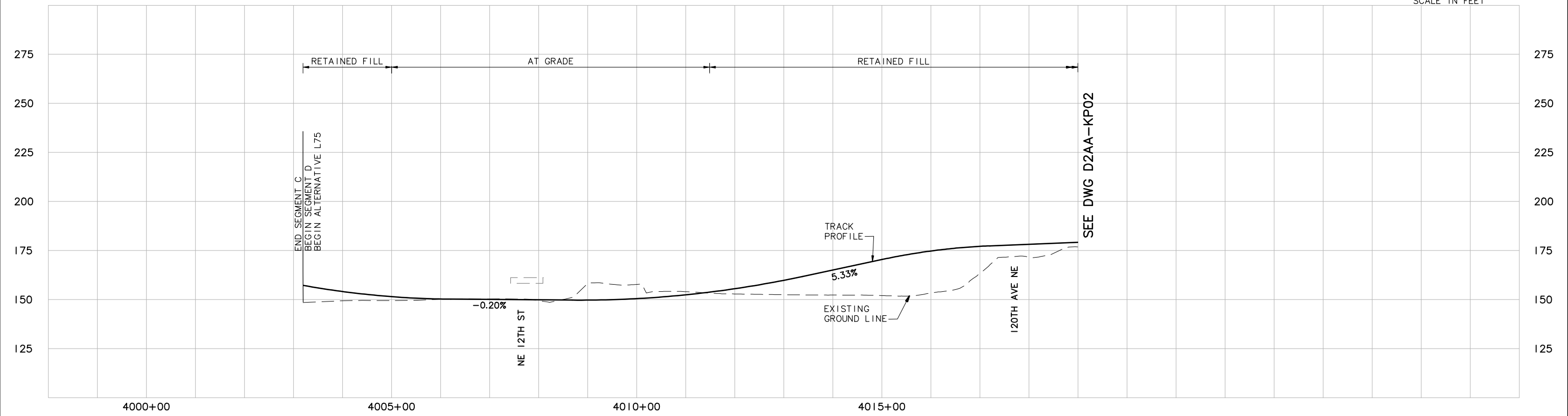
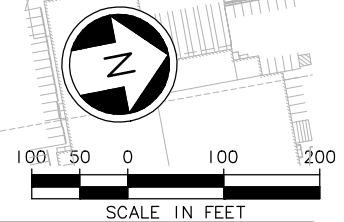
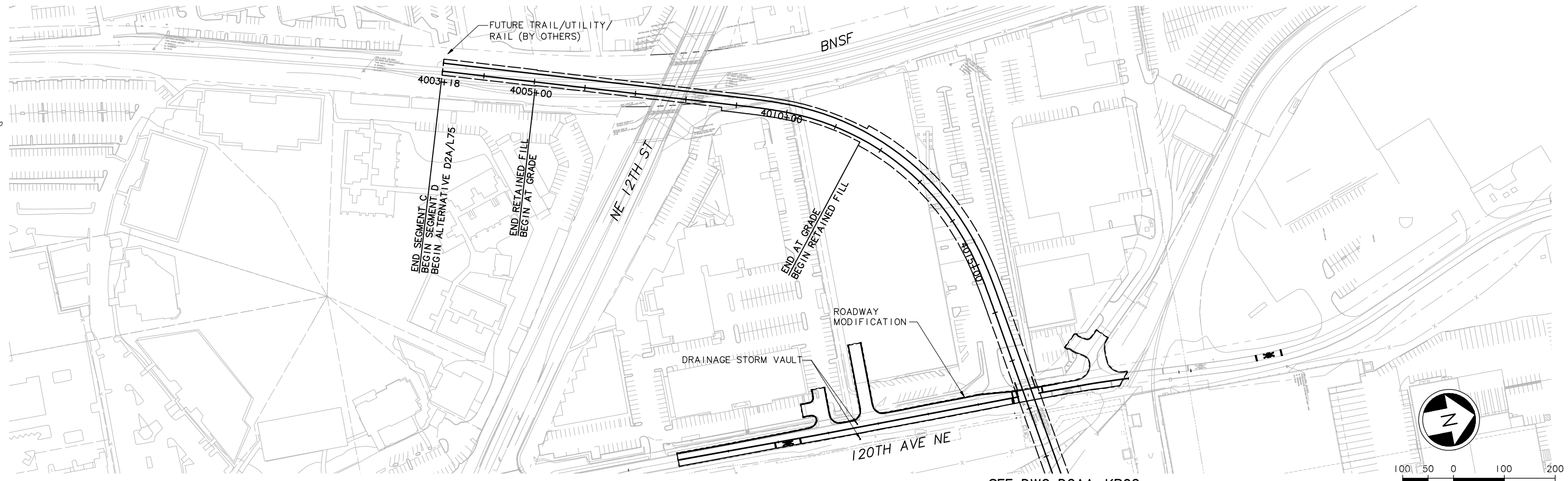

c:\work\feis\segment_d\ELD_ID2AAKP01.dwg
 04/18/11 10:27 : khuum 0E6585

Designed By:					
Drawn By:					
Checked By:					
Approved By:					
No.	Date	Dsn.	Chk.	App.	Revisions

FEIS CONCEPTUAL

CH2MHILL

Grijalva ENGINEERING

BOLIMA DRAFTING & DESIGN INC.

SOUNDTRANSIT

Submitted: _____ Date: _____ Approved: _____ Date: _____

Scale:
 H: 1"=100'; V: 1"=25'
 Filename:
 ELD_ID2AAKP01.dwg
 Contract No.:

LINK LIGHT RAIL PROJECT
 EAST CORRIDOR
 SEGMENT D - ALT D2A
 BETH STATION & NE 24TH DESIGN OPTION
 TRACK PLAN & PROFILE

Drawing No.: **D2AA-KP01**
 Sheet No.: **D-27**
 Rev.:



DWG INFO:
 LTSCALE:
 1=
 XREFs:
 -Attach:
 -Overlay:
 ELD_L75_CA_Interim
 ELD_L75_CM_Interim
 ELD_L75_KA_Interim-100
 ELD_L75_US
 SUB-SDE1S
 ZG-2234H
 ZG-G10010
 Key_Segment
 x0831rx
 x0831sf
 x1131rx
 x1131sf
 x1134rx
 x1134sf
 -Unresolved:

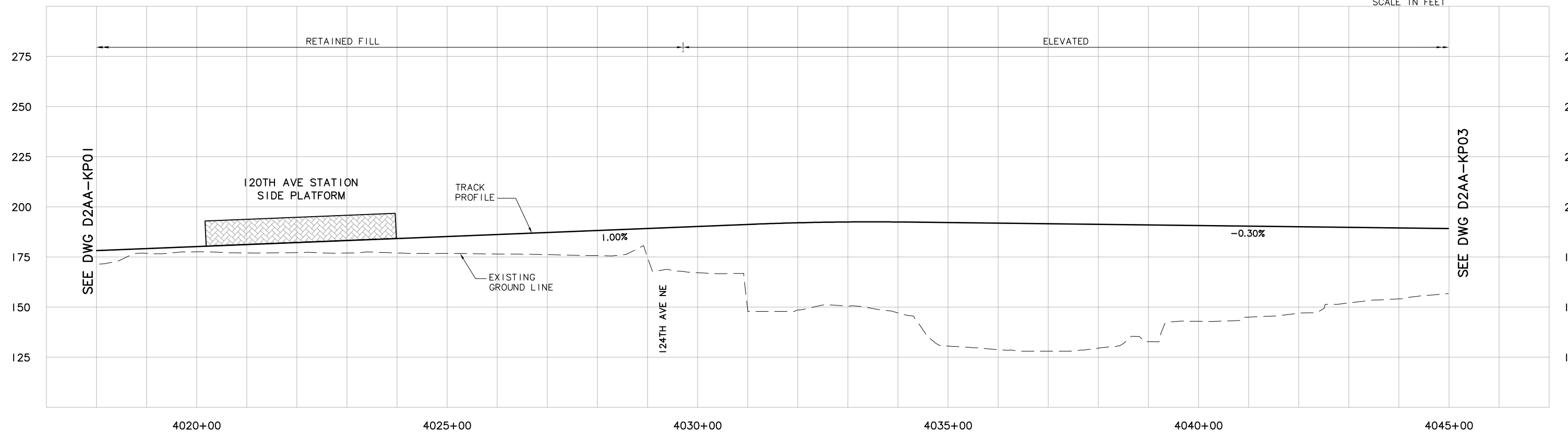
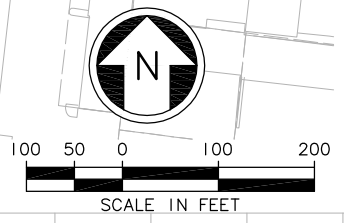
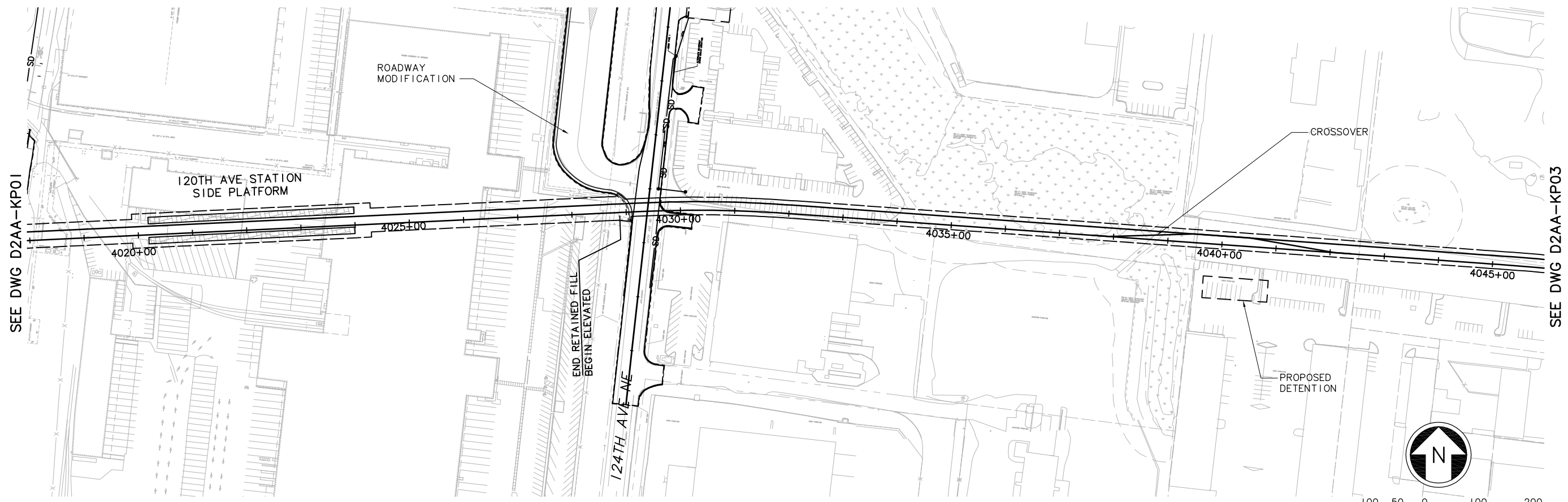

c:\work\sde1s\ELD_ID2AAKP02.dwg
 10/08/10 09:46 : bolimaf 0E6579

No.	Date	Dsn.	Chk.	App.	Revisions

Designed By:
 Drawn By:
 Checked By:
 Approved By:

FEIS CONCEPTUAL

CH2MHILL

Grijalva
 ENGINEERING

BOLIMA
 DRAFTING & DESIGN INC.

SOUNDTRANSIT

Scale:
 H: 1"=100'; V: 1"=25'
 Filename:
 ELD_ID2AAKP02.dwg
 Contract No.:
 Date: 07/30/10

LINK LIGHT RAIL PROJECT
 EAST CORRIDOR
 SEGMENT D - ALT D2A
 120TH STATION & NE 24TH DESIGN OPTION
 TRACK PLAN & PROFILE

Drawing No.:
D2AA-KP02

Sheet No.:
D-28

Rev.:

NOTES

I. ALIGNMENT D2A

SYMBOLS KEY

	NEW BUS STOP
	EXISTING BUS STOP
	BUS LAYOVER
	PARATRANSIT SHELTER
	PARATRANSIT STOP
	BUS ROUTE
	235 249
	BIKE PARKING: CLASS 1
	BIKE PARKING: CLASS 2
	CROSSWALK
	NEW LANDSCAPE
	NEW WALKS
	NEW PLAZA
	TRACK

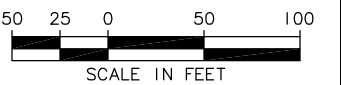

STATION AREA PLAN

SCALE: 1" = 50'

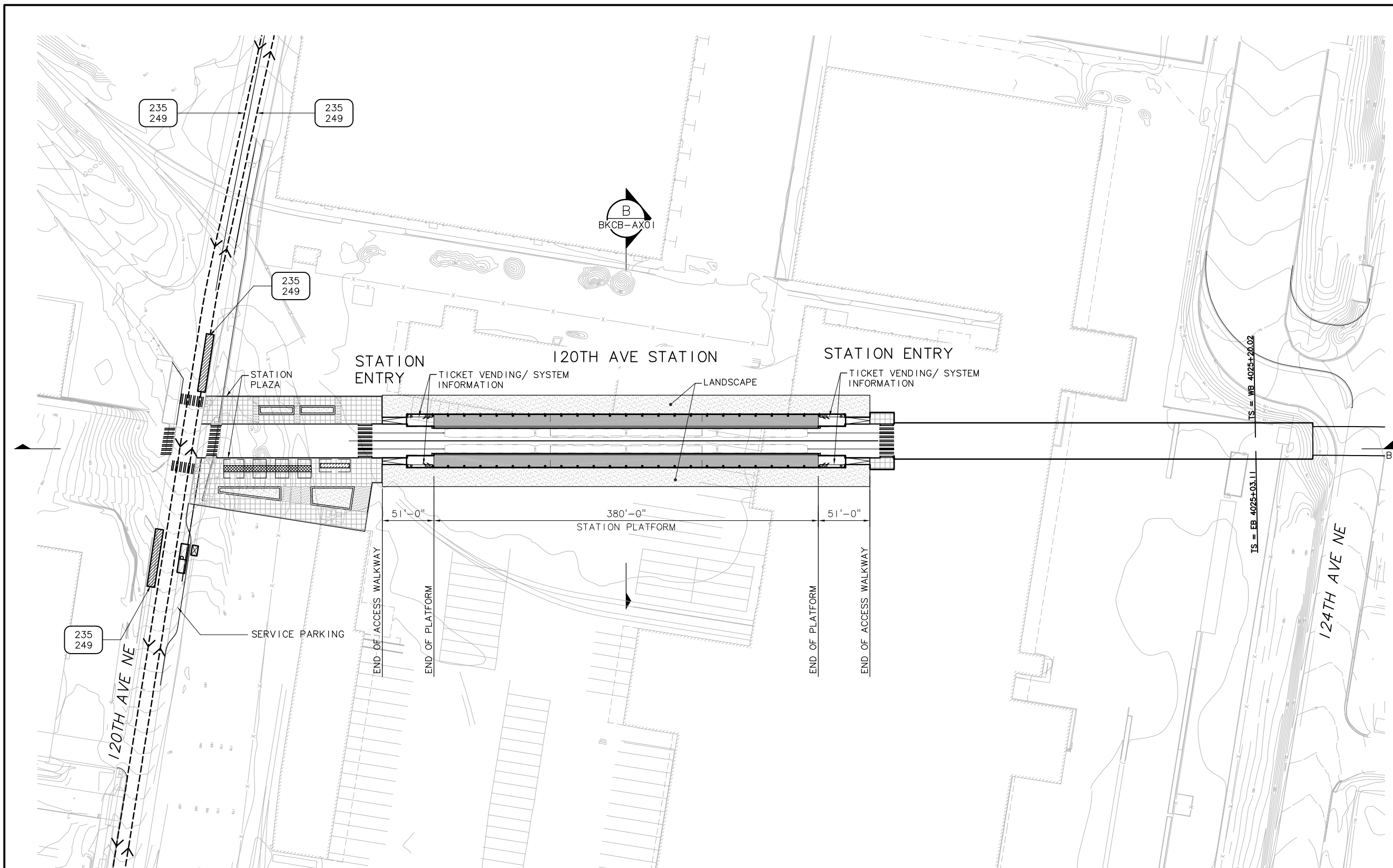

DWG INFO:
 L1SCALE:
 1=1
 XREFs:
 -Attach:
 ELD_L75_KA
 -Overlay:
 ELD_L75_CA
 ELD_L75_CM
 ELD_L75_CS
 ELD_N15_AP_2
 ELD_N15_AS_2
 SUB-SDE IS
 ZG-2234H
 x0831cn
 x0831rx
 x0831ef
 -Unresolved:

c:\work\sdeis\ELD_IBKCBASO1.dwg
 10/08/10 11:12 : bolimaf OE6579

Designed By:	
Drawn By:	
Checked By:	
Approved By:	

FEIS CONCEPTUAL

CH2MHILL

IBI GROUP

IBI Group
 801 Second Avenue - Suite 1400
 Seattle WA 98104 1576 USA
 tel 206.521.9091
 fax 206.521.9085

SOUNDTRANSIT

Scale: 1"=50'
 Filename: ELD_IBKCBASO1.dwg
 Contract No.:
 Date: 07/30/10

LINK LIGHT RAIL PROJECT
 EAST CORRIDOR
 SEGMENT D - ALT D2A
 120TH STATION DESIGN OPTION
 STATION AREA PLAN

Drawing No.: BKCB-ASO1
 Sheet No.: D-29
 Rev.:

No.	Date	Dsn.	Chk.	App.	Revisions

XREF'S
 Resolved
 ELD_N15_A
 ZG-2234H
 Unresolved
 LTSCALE
 1=1

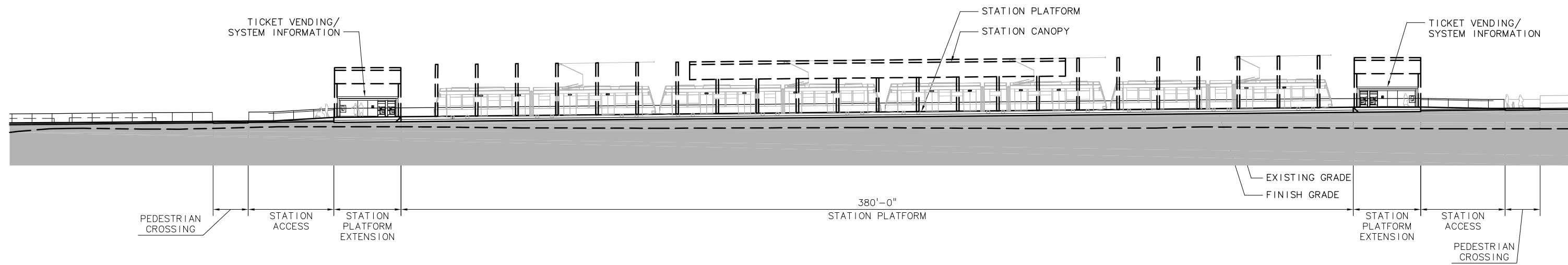

SITE SECTION A
 SCALE: 1" = 20' BKCB-AX01

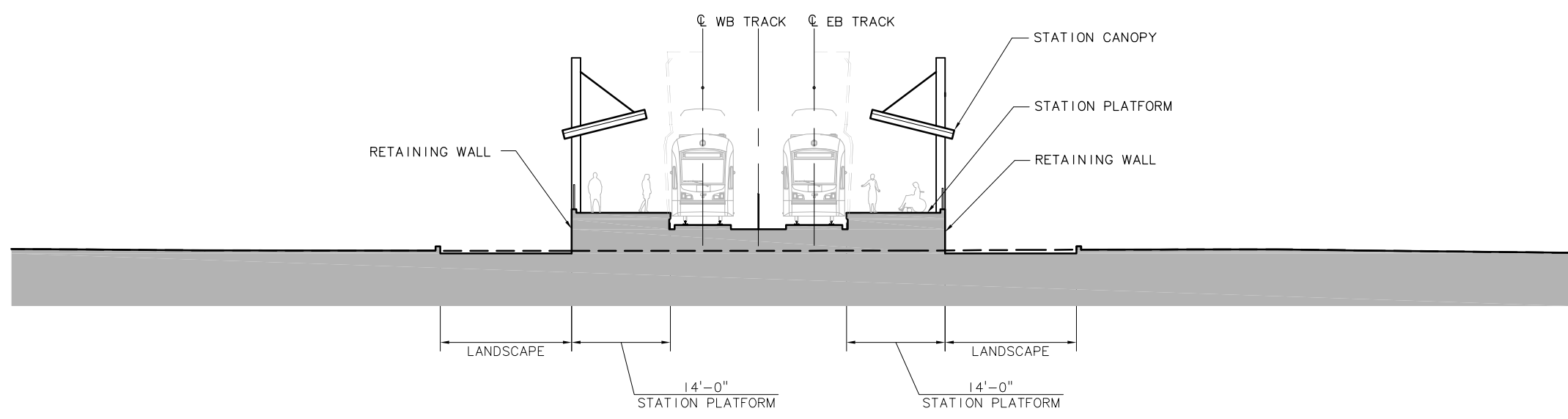

SITE SECTION B
 SCALE: 1" = 10' BKCB-AX01

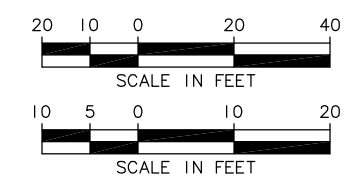

c:\work\sdeis\ELD_IBKCBAX01.dwg
 08/17/10 09:33 : BOLIMAF OE6579

No.	Date	Dsn.	Chk.	App.	Revisions

Designed By:
 Drawn By:
 Checked By:
 Approved By:

FEIS CONCEPTUAL

CH2MHILL

IBI GROUP

IBI Group
 801 Second Avenue - Suite 1400
 Seattle WA 98104 1576 USA

tel 206.521.9091
 fax 206.521.9085

SOUNDTRANSIT

Scale: AS NOTED
 Filename: ELD_IBKCBAX01.dwg
 Contract No.:
 Date: 07/30/10

LINK LIGHT RAIL PROJECT
 EAST CORRIDOR
 SEGMENT D - ALT D2A

120TH STATION
 SITE SECTIONS
 DESIGN OPTION

Drawing No.: BKCB-AX01
 Sheet No.: D-30
 Rev.:

DWG INFO:
 LTSCALE:
 1=1
 XREFs:
 -Attach:
 -Overlay:
 ELD_L75_CA-Interim
 ELD_L75_CM
 ELD_L75_CM-Interim
 ELD_L75_JD
 ELD_L75_KA-Interim-100
 SUB-SDE:IS
 ZG-2234H
 ZG-610010
 Rev_Segment
 x1434r
 x1434f
 x1734r
 x1734f
 x1737r
 x1737f
 xBGRk_suf
 xChild_bldg
 x405_chan
 xwsdot_LL-LM
 -Unresolved:

SEE DWG D2AB-KP05

SEE DWG D2AA-KP07

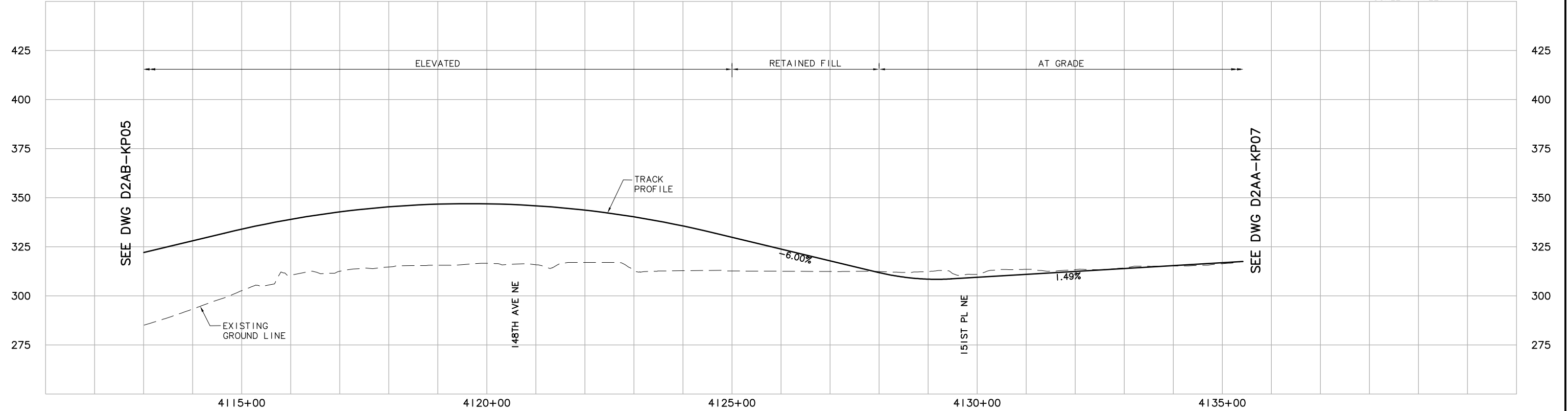
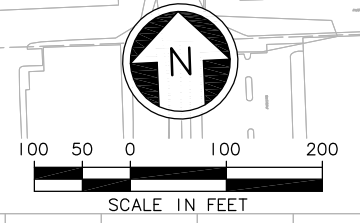
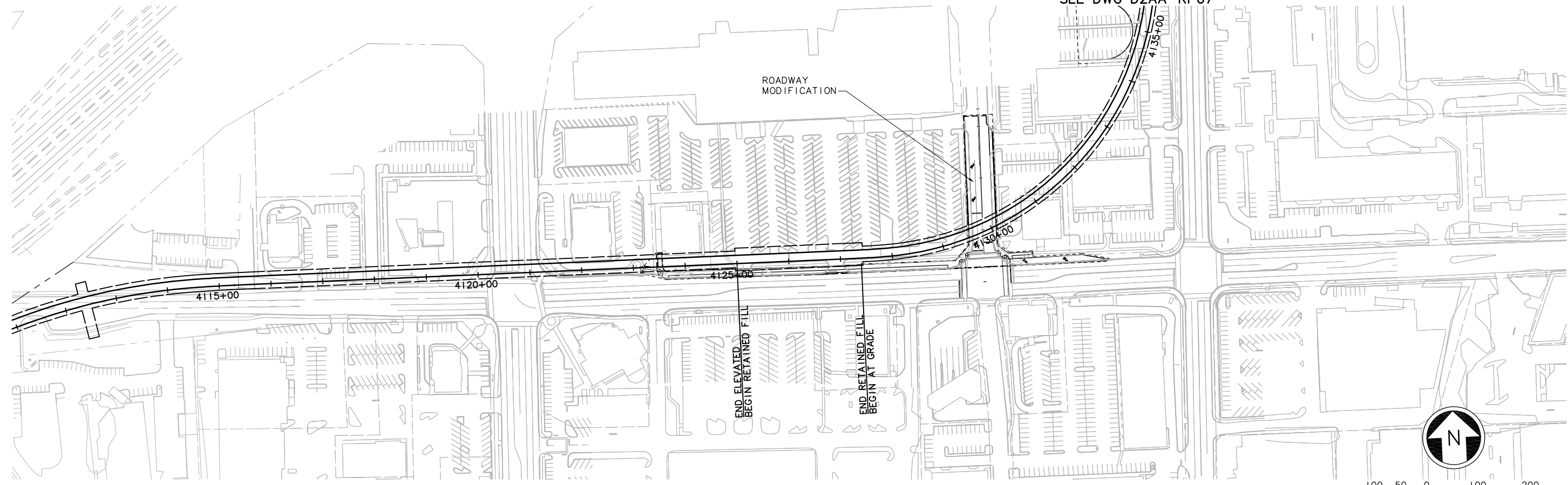

c:\work\sdeis\ELD_ID2AAKP06.dwg
 10/13/10 13:44 : bolimaf 0E6579

Designed By:					
Drawn By:					
Checked By:					
Approved By:					
No.	Date	Dsn.	Chk.	App.	Revisions

**FEIS
CONCEPTUAL**

Grijalva
ENGINEERING

Submitted: _____ Date: _____ Approved: _____ Date: _____

Scale: H: 1"=100'; V: 1"=25' Filename: ELD_ID2AAKP06.dwg Contract No.: _____ Date: 07/30/10	<p>LINK LIGHT RAIL PROJECT EAST CORRIDOR SEGMENT D – ALT D2A BETH STATION & NE 24TH DESIGN OPTION</p>	Drawing No.: D2AA-KP06 Sheet No.: D-31
--	---	---

DWG INFO:
 LTSCALE:
 1=1
 XREFs:
 -Attach:
 -Overlay:
 ELD_ID2AAKP07.dwg
 ELD_ID2AAKP07.dwg
 ELD_ID2AAKP07.dwg
 ELD_ID2AAKP07.dwg
 SUB-SDE IS
 ZC-2234H
 ZC-610010
 Key_Segment
 x1734rf
 x1737rf
 x1740rf
 x1743rf
 x2037rf
 x2040rf
 -Unresolved:
 ELD_ID2AAKP07.dwg
 ELD_ID2AAKP07.dwg

SEE DWG D2A-KP106

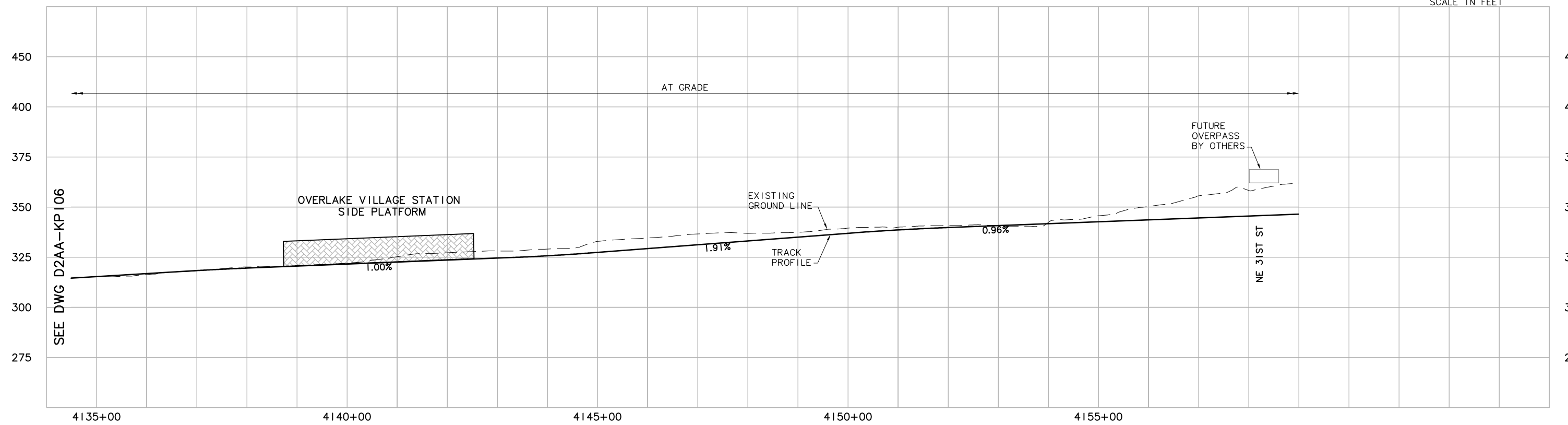
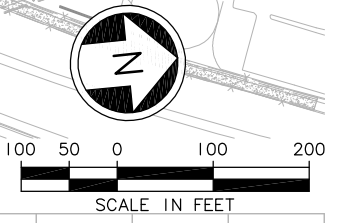
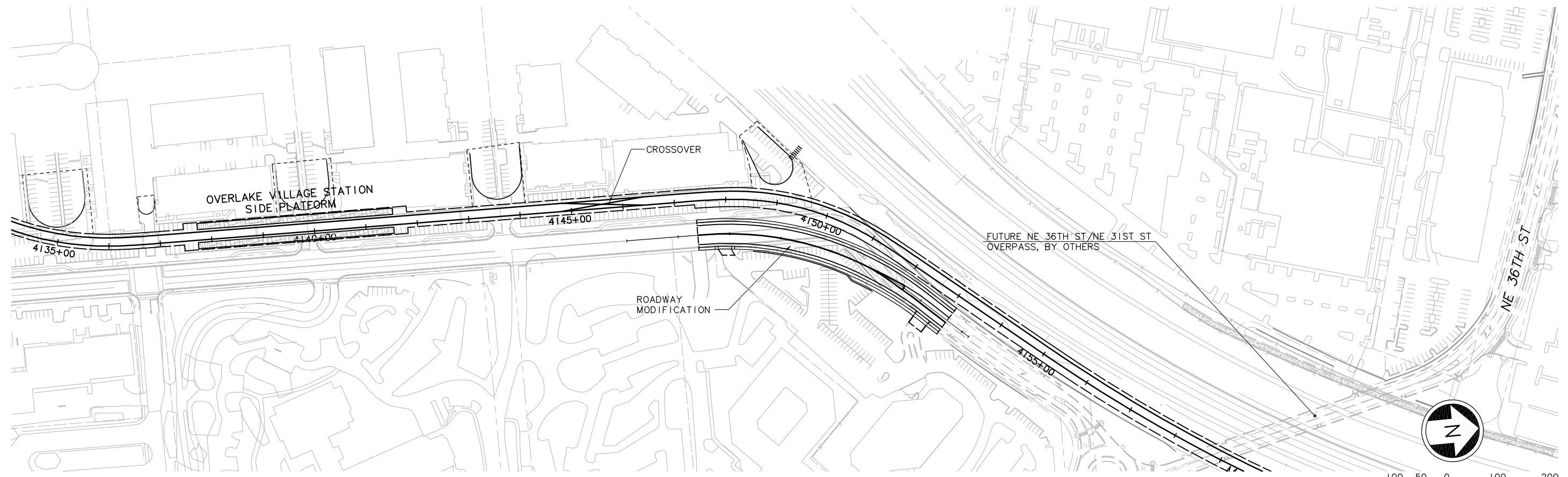

c:\work\sdeis\ELD_ID2AAKP07.dwg
 10/13/10 13:45 : bolimaf OE6579

<table border="1"> <tr><td>No.</td><td>Date</td><td>Dsn.</td><td>Chk.</td><td>App.</td><td>Revisions</td></tr> <tr><td> </td><td> </td><td> </td><td> </td><td> </td><td> </td></tr> </table>					No.	Date	Dsn.	Chk.	App.	Revisions							Designed By: Drawn By: Checked By: Approved By:	FEIS CONCEPTUAL CH2MHILL	Grijalva ENGINEERING BOLIMA DRAFTING & DESIGN INC.	SOUNDTRANSIT	Scale: H: 1"=100'; V: 1"=25' Filename: ELD_ID2AAKP07.dwg Contract No.: Date: 07/30/10	LINK LIGHT RAIL PROJECT EAST CORRIDOR SEGMENT D - ALT D2A OVERLAKE VILLAGE STATION & NE 24TH DESIGN OPTION	Drawing No.: D2AA-KP07 Sheet No.: D-32 Rev.:
No.	Date	Dsn.	Chk.	App.	Revisions																		

DWG INFO:
 LTSCALE: 1/1
 XREFs:
 -Attach:
 -Overlay:
 ELD_175_CM
 ELD_175_KA
 ELD_N19_AP
 ELD_N19_AS
 SUB-SDE1S
 ZG-2234H
 x1734en
 x1734ex
 x1734ef
 x1737ex
 x1737ef
 -Unresolved:

NOTES
 1. ALIGNMENT D2A

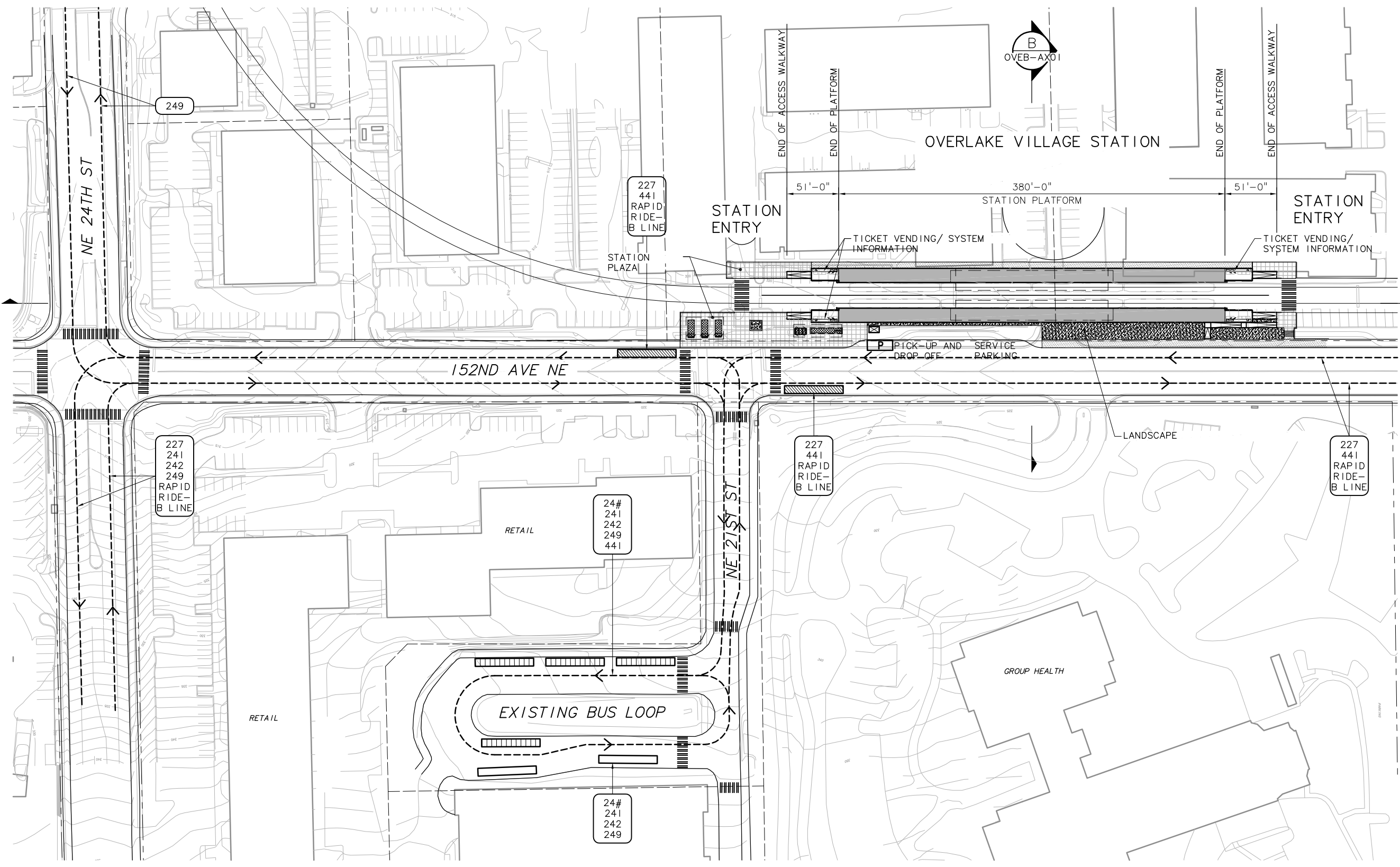

SYMBOLS KEY

- NEW BUS STOP
- EXISTING BUS STOP
- BUS LAYOVER
- PARATRANSIT SHELTER
- PARATRANSIT STOP
- BUS ROUTE
- 242 249
- BIKE PARKING: CLASS 1
- BIKE PARKING: CLASS 2
- CROSSWALK
- NEW LANDSCAPE
- NEW WALKS
- NEW PLAZA
- TRACK



STATION AREA PLAN
 SCALE: 1" = 50'

c:\work\sde1s\ELD_10VEBAS01.dwg
 10/08/10 09:46 : bolimaf OE6579

No.	Date	Dsn.	Chk.	App.	Revisions

Designed By:
 Drawn By:
 Checked By:
 Approved By:

FEIS
 CONCEPTUAL



IBI Group
 801 Second Avenue - Suite 1400
 Seattle WA 98104 1576 USA
 tel 206.521.9091
 fax 206.521.9085



Scale: 1" = 50'
 Filename: ELD_10VEBAS01.dwg
 Contract No.:
 Date: 07/30/10



LINK LIGHT RAIL PROJECT
 EAST CORRIDOR
 SEGMENT D - ALT D2A
 NE 24TH DESIGN OPTION
 OVERLAKE VILLAGE STATION
 STATION AREA PLAN

Drawing No.: OVEB-AS01
 Sheet No.:
 Rev.:
 D-33

DWG INFO:
 L1SCALE:
 1=1
 XREFS:
 -Attach:
 -Overlay:
 ELD_N19_AX
 SUB-SDE15
 ZG-2234H
 -Unresolved:

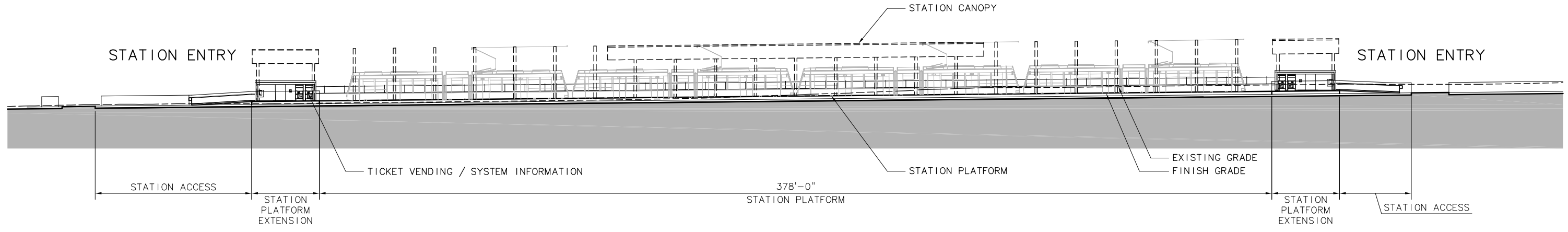

SITE SECTION A
 SCALE: 1" = 20'
 OVEB-AX01

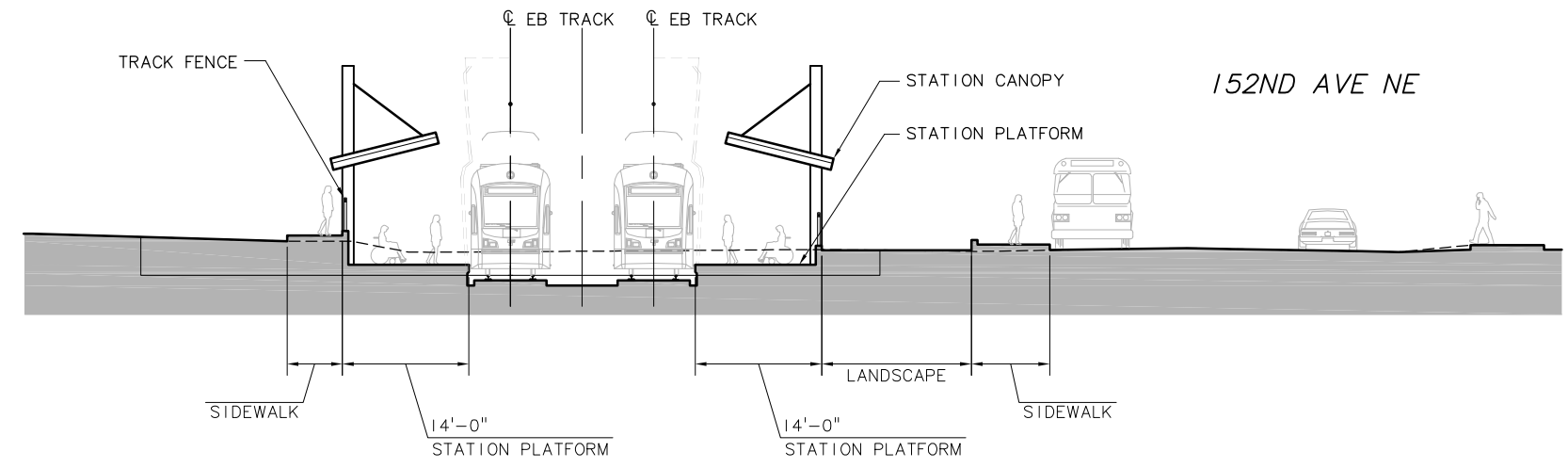

SITE SECTION B
 SCALE: 1" = 10'
 OVEB-AX01

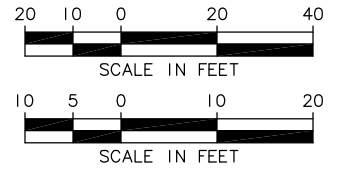

c:\work\sde15\ELD_10VEBAX01.dwg
 10/08/10 10:02 : bolimaf OE6579

No.	Date	Dsn.	Chk.	App.	Revisions

Designed By:
 Drawn By:
 Checked By:
 Approved By:

FEIS CONCEPTUAL

CH2MHILL

IBI GROUP

IBI Group
 801 Second Avenue - Suite 1400
 Seattle WA 98104 1576 USA
 tel 206.521.9091
 fax 206.521.9085

SOUNDTRANSIT

Submitted: _____ Date: _____ Approved: _____ Date: _____

Scale: AS NOTED
 Filename: ELD_10VEBAX01.dwg
 Contract No.: _____
 Date: 07/30/10

LINK LIGHT RAIL PROJECT
 EAST CORRIDOR
 SEGMENT D - ALT D2A
 NE 24TH DESIGN OPTION
 OVERLAKE VILLAGE STATION
 SITE SECTIONS

Drawing No.: OVEB-AX01
 Sheet No.: _____ Rev.: _____
D-34