

Brooklyn Station Construction Open House

November 16, 2011





Tonight's Agenda

- 6:00 pm – Open House
- 6:30 pm – Presentation
 - **Introduction**
 - Ron Endlich, North Link Deputy Project Director
 - Louise Little, Greater University Chamber of Commerce
 - **Brooklyn Station Construction**
 - Tracy Reed, Station Project Manager
 - **Next Steps**
 - **Questions and Answers**
- 7:45 pm – Return to Open House
- 8:30 pm – Close

Link Light Rail System

- 16 miles of light rail with 13 stations currently in service
- University Link under construction; opens 2016
- ST2 Plan with extensions to Lynnwood, Overlake, and Federal Way
- 54 mile system



North Link (University District to Northgate)

- 4.3-mile light rail extension
- Stations at Brooklyn, Roosevelt, and Northgate
- Completion: 2021
- 62,000 daily boardings added to system by 2030



Station Name

- “Brooklyn Station” has been the working title
- Sound Transit Board expected to select permanent station name in spring 2012
- Name must meet criteria:
 - Reflect nature of environment: neighborhoods, street names, landmarks, plus geographical locations
 - Be brief and easy to read and remember
 - Adhere to a 30-character limit
 - Commercial names should be avoided
 - Similar names or words used in existing station names should be avoided
- Collecting initial input on potential permanent names
 - Have heard strong interest for “U-District Station”

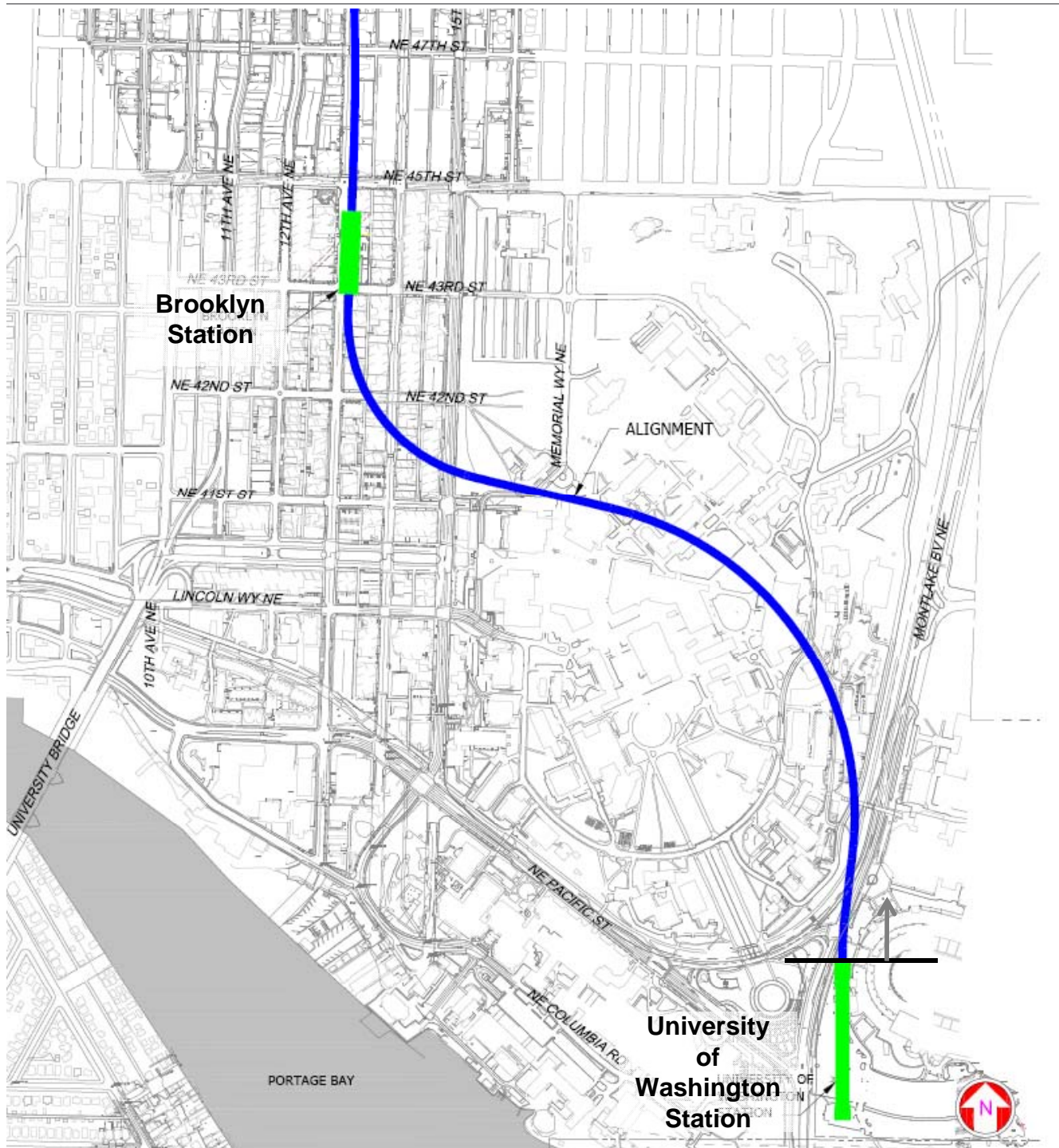

Tunnel Alignment

(From the University of Washington Station to the Brooklyn Station)

Brooklyn Station

Key Features:

- Station platform, 75-85 ft. underground
 - Elevators, escalators and stairs
 - Bicycle parking
 - 12,000 daily boardings (2030)
- Constrained construction site
- Staging use of Brooklyn Avenue and NE 43rd followed by restoration to city Green Street principles
- Designed to accommodate future building above station



STart

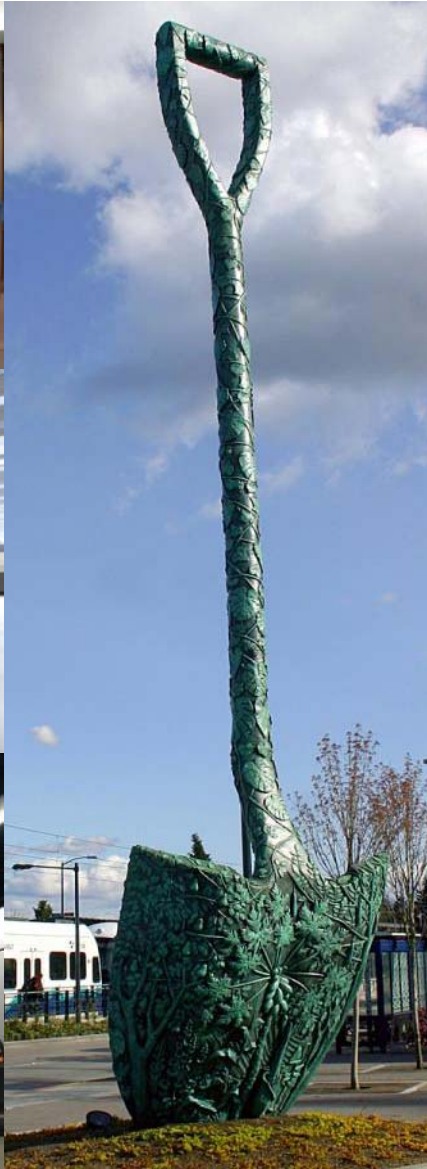
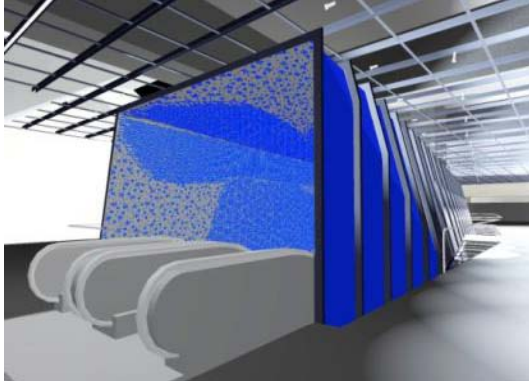

Brooklyn Station Schedule

DRAFT

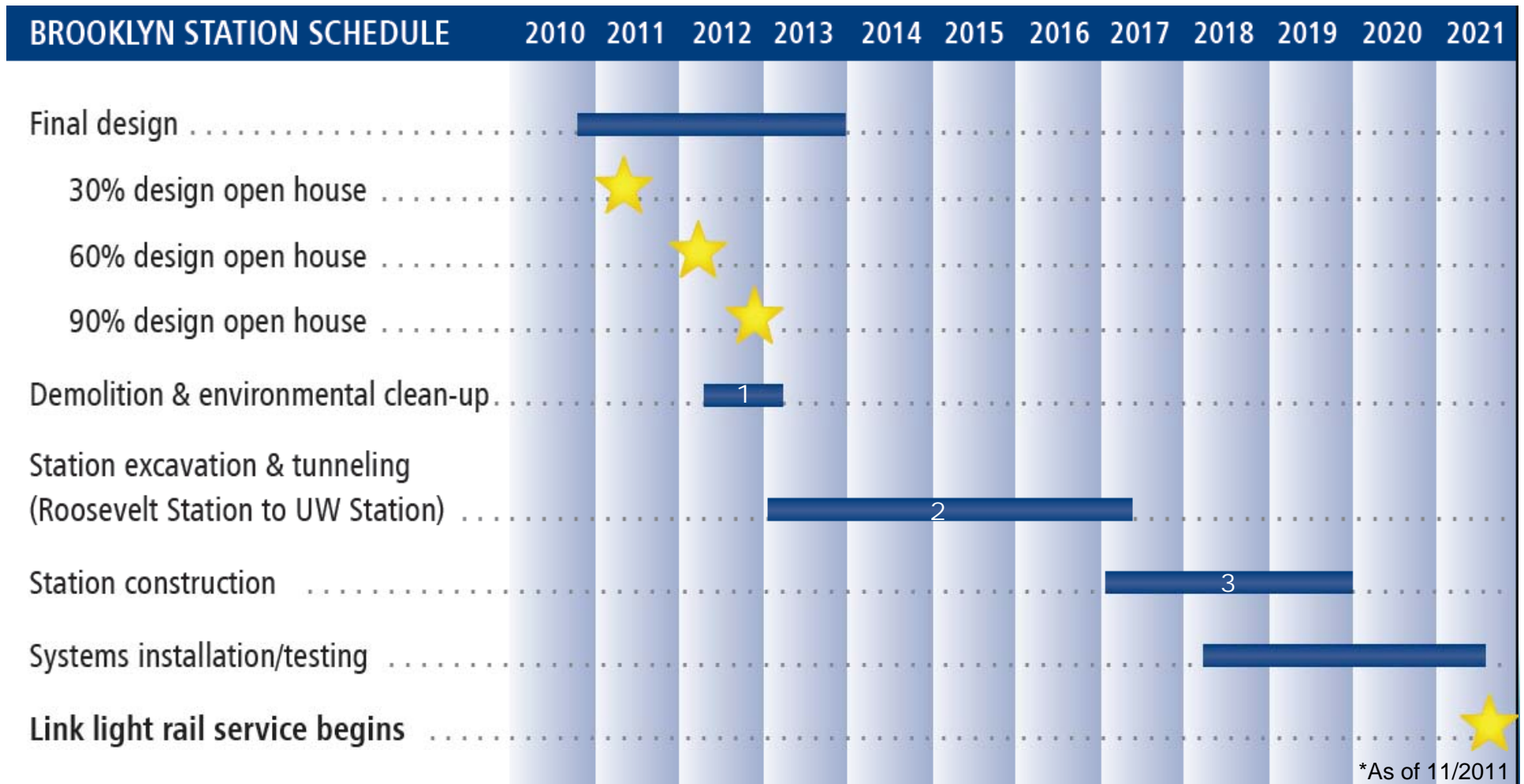

*As of 11/2011

ST Standard Construction Procedures



- Standard provisions written into contracts
 - Clean, secure perimeter
 - Wheel wash, idling limits
 - Restrict contractor parking in neighborhood
- Promote local business district
- 24-hour construction hotline (888-298-2395)

ST Sustainability Program



- Salvage materials before the demolition contract

Examples:

- Light and plumbing fixtures
- Interior doors and cabinets
- Plants

- Recycle during demolition and construction

- Minimum of 75% of materials disposed

Utility Relocation: Pre-construction



- Private Utility Relocation
 - PSE gas line relocation (12th Avenue between NE 45th and NE 43rd St.)
 - Comcast cable relocation (Brooklyn Avenue between NE 45th and NE 43rd St.)

DURATION: MID 2012 - EARLY 2013

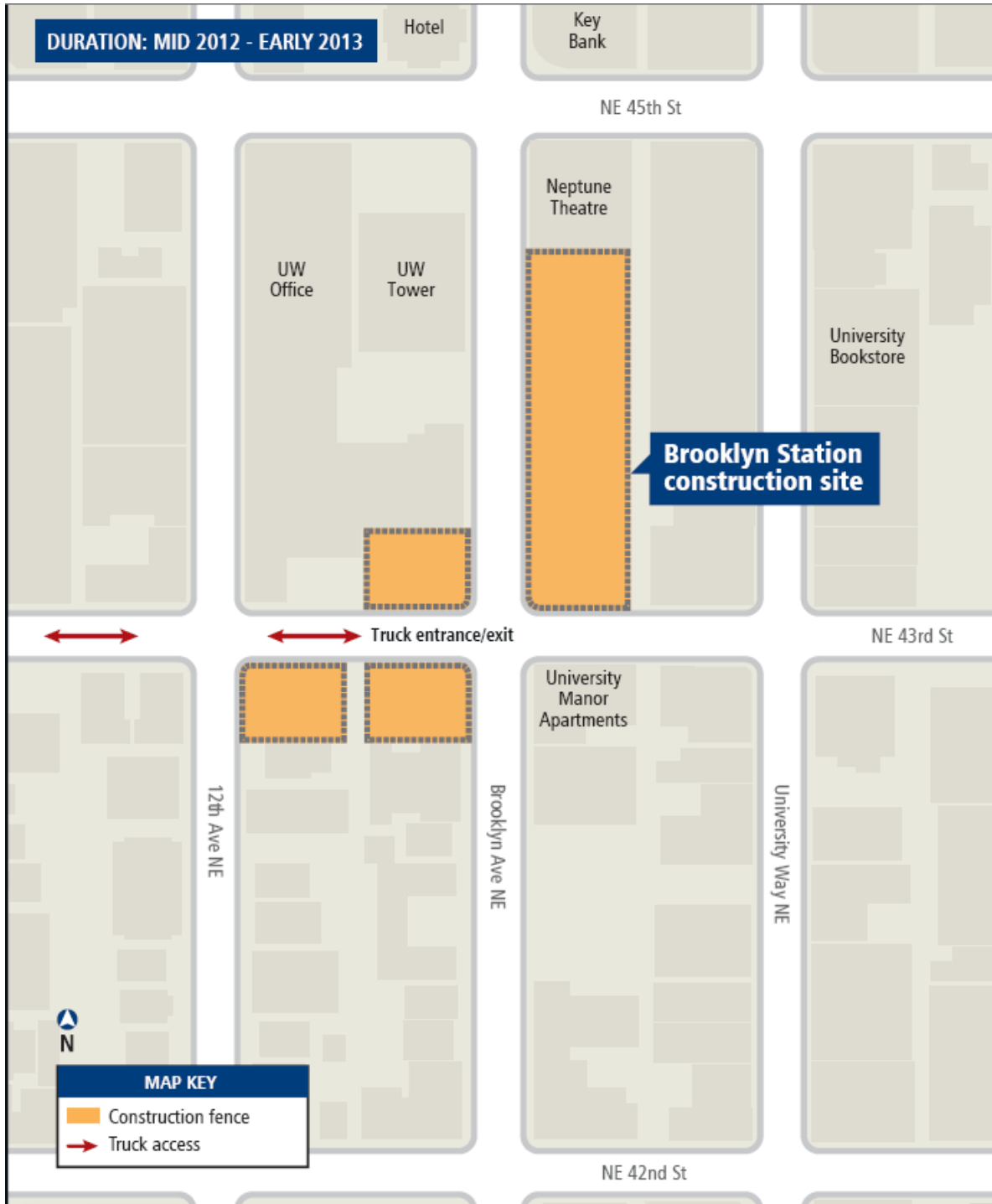

MAP KEY

- Construction fence
- Truck access

1. Site Demolition Contract

Mid 2012 – Early 2013

1. Site Demolition Contract

Mid 2012 – Early 2013

Truck Haul Routes



1. Dust Control



- Watering during demo
- Covered loads
- Street sweeping
- Wheel washes





1. and 2. Vegetation Removal

- Trees and shrubs around the:
 - Demolition contract sites
 - University Manor apartments
- Street trees along Brooklyn Avenue NE between NE 45th and NE 43rd



DURATION: 2013 - 2017



2. Station Excavation and Tunneling Contract 2013 - 2017

- **Excavation of station**
- **Temporary support**
- **Tunnel construction**
 - TBM launched from Roosevelt at NE 65th St.
 - inspection and ventilation support during drive to UW Station

2. Street Closure - Sidewalk Access



NE 45th / Brooklyn Ave

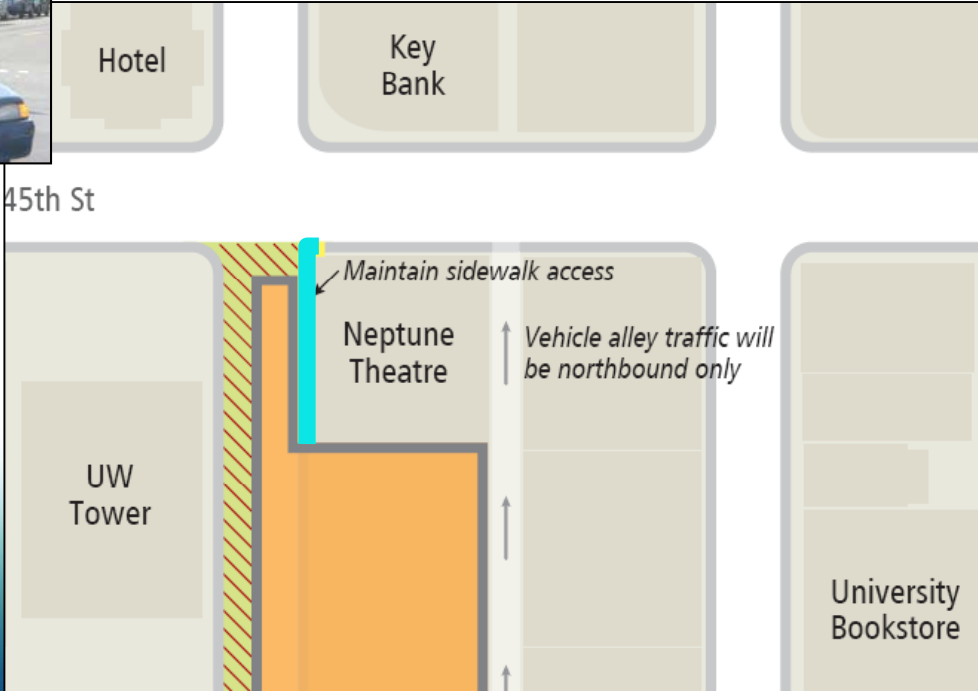

2. Street Closure - Sidewalk Access



NE 43rd / Brooklyn Ave

2. Typical Construction Activities



2. Noise Mitigation



- Solid plywood construction screening wall (8'-16' tall)
- Stationary equipment (compressors, generators) enclosed in noise reducing material
- Trucks – no tonal alarms during the nighttime hours
- Nighttime Monitoring

2. Noise Variance



- ST will seek Major Public Project Construction Noise Variance from City of Seattle
- Noise variance establishes noise limits for contractor work between 10pm - 7am weekdays, 10pm - 9am weekends, holidays
- Daytime construction activities will comply with City's construction noise limits
- More noise information at next construction open house

2. Exterior Construction Wall Lighting



- Construction lighting
 - inside construction walls
 - fixtures shrouded, directing light downward
- Security lighting
 - exterior lighting on construction walls
 - Balance illumination for security while minimizing stray lighting

2. Station Excavation and Tunneling Contract

2013 - 2017

Truck Haul Routes



2. Tunneling and Excavation Animation



DURATION: 2017-2019



3. Station Construction Contract 2017-2019

- Station entrances
- Permanent structures
- Street restoration

Next Steps

- Meet the Artists – Early 2012
- Plant salvage event – Early 2012
- Brooklyn construction open house – Early 2012
- Station 60% design open house – Spring 2012
- Station naming

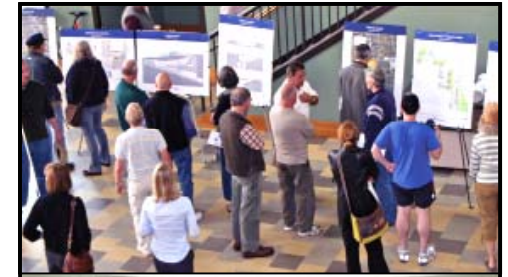

Questions?



Get Involved

in North Link Final Design

Learn About Your Neighborhood Station

At Final Design Open Houses you can:

- Learn about your station's design and look, including amenities such as bicycle facilities and pedestrian and bus connections
- Preview your station's artwork
- Learn about redevelopment opportunities adjacent to the station

Stay Informed

- Request a briefing for your organization by contacting Wilbert Santos, Community Outreach Coordinator, at (206) 370-5516 or northlink@soundtransit.org
- Visit Sound Transit's Web site at www.soundtransit.org/northlink
- Sign up for e-mail alerts at www.soundtransit.org
- Click on "subscribe to E-mail alerts"

