

Access improvements timeline

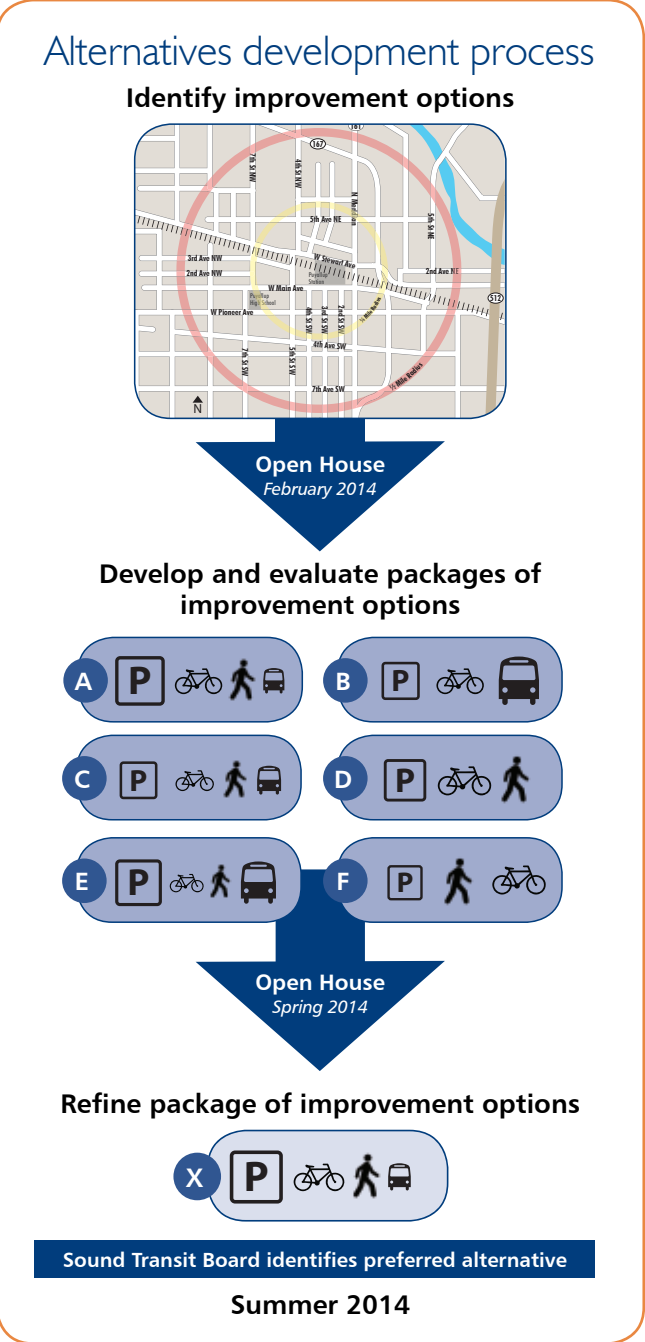

Improving access to Puyallup Station

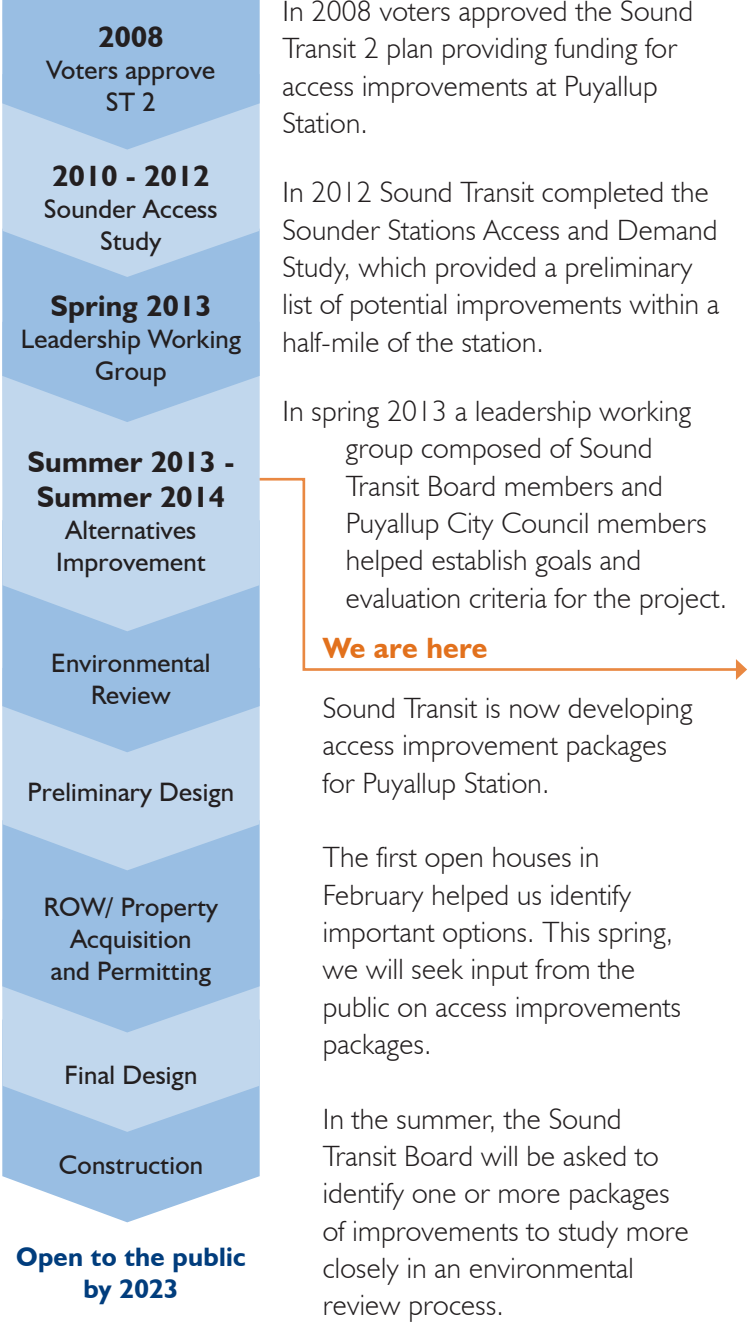

**About the Puyallup Station Access Improvements project**

In the 2008 Sound Transit 2 ballot measure, voters approved funding to improve access at Sounder stations. The Puyallup Station Access Improvement Project is evaluating potential capital investments to improve access to Puyallup Station for pedestrians, bicyclists and drivers. Sound Transit is planning to construct all improvements by 2023.

Nearly 1,000 people each day ride a Sounder train or ST Express bus from Puyallup Station. Ten round-trip Sounder trains stop at Puyallup Station each weekday. Sound Transit plans to provide 13 roundtrips by 2017, and predicts about a 70 percent increase in ridership by 2035.

As Sounder ridership and service increases, easy and reliable access to the station will become even more important. Sounder parking spaces are usually full early in the morning and riders heading to and from Puyallup Station experience congested traffic.

**Your chance to be involved**

Take our online questionnaire: [soundtransit.org/PuyallupImprovements](http://soundtransit.org/PuyallupImprovements)

Sign up for email project updates: [soundtransit.org/subscribe](http://soundtransit.org/subscribe)

For more information, contact Ryan Bianchi at 206-398-5070 or [ryan.bianchi@soundtransit.org](mailto:ryan.bianchi@soundtransit.org)

IN THIS ISSUE

Project goals

Proposed pedestrian, bike, bus/traffic and parking improvements

Evaluation results

Where we are on the project schedule

**Improvement options**

Working with input from Sounder riders and other community stakeholders, Sound Transit has developed six different pedestrian, bike, bus/traffic and parking access improvement packages. This issue of the project newsletter primarily includes proposed multi-modal improvement packages, evaluation results and next steps.

For more information about Sound Transit projects or services, visit [soundtransit.org](http://soundtransit.org) or call 1-800-201-4900/ TTY Relay: 711. For information in alternative formats, call 1-800-201-4900/ TTY Relay: 711 or email [accessibility@soundtransit.org](mailto:accessibility@soundtransit.org)

Si desea conocer mayores detalles sobre el proyecto de mejoras del acceso a la estación Puyallup por favor llame al telefono 1-800-823-9230 durante las horas normales de oficina.

Project purpose

Sound Transit plans to improve access for Sounder train riders to Puyallup Station, focusing on pedestrians, bikes and personal vehicles through:

- Focusing on pedestrian and parking garage improvements within a quarter-mile of the station
- Focusing on parking lot, vehicle access and bicycle improvements within a half-mile of the station
- Completing the project by 2023

Total budget: \$55 million (2014 dollars)

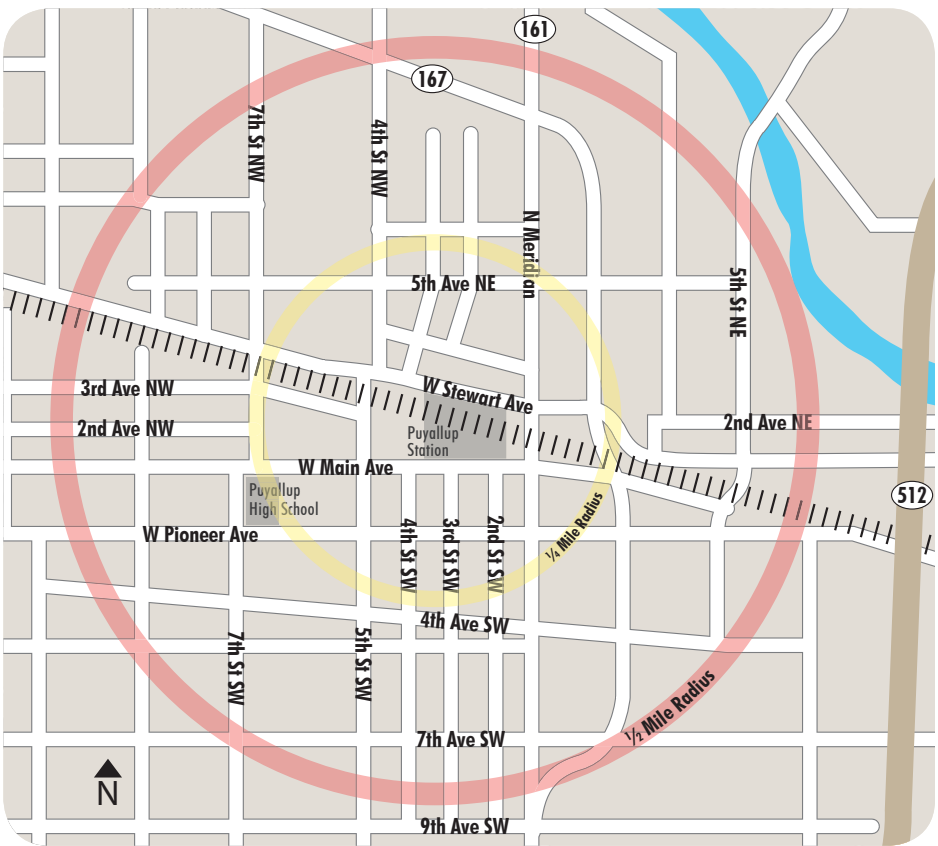

Project goals and evaluation criteria

Sound Transit worked with city staff, community leaders and stakeholders to develop project goals and evaluation criteria.

These goals provide a framework for developing access improvements. The evaluation criteria will be used to help assess the effectiveness of proposed improvements.

DRAFT GOALS	EVALUATION CRITERIA
Provide improved access to Sounder riders	<ul style="list-style-type: none"><li>■ Provides capacity for existing and future riders</li><li>■ Provides safe, multi-modal access and reliable travel times to the Sounder station area for riders</li></ul>
Benefit the local community	<ul style="list-style-type: none"><li>■ Supports community character, vision, plans and policies for the station area, including historic downtown</li><li>■ Supports access to parking for downtown businesses and residences within the station area</li><li>■ Minimizes additional congestion and impacts to neighborhood traffic within the station area</li></ul>
Support Sound Transit's regional commitments	<ul style="list-style-type: none"><li>■ Is cost-effective and financially sustainable</li><li>■ Supports plans and policies from Sound Transit and regional policies</li><li>■ Builds on the access improvements identified in the Sounder Stations Access and Demand Study</li></ul>
Maintain a healthy environment	<ul style="list-style-type: none"><li>■ Minimizes potential adverse impacts to the natural and built environment</li></ul>

What options are being considered?

See inside insert for specific locations of pedestrian, bike and bus/traffic improvements under consideration.



Potential bus improvements

Current bus service to the station is provided by Pierce Transit routes 400, 402, 409 and 495. Sound Transit will evaluate improvements, such as transit signal priority, that could improve bus access to the station.



Pedestrian and bicycle improvements

Sound Transit is studying improvements that would make it easier for pedestrians and cyclists to access the station. Improvements could include new or improved crosswalks, bike lanes and pedestrian pathways.



Potential congestion improvements

Sound Transit is exploring options with the City of Puyallup to reduce transit rider-related congestion near the station, including:

- Tools to manage traffic flow, including coordination of new and/or existing traffic signals
- Focused capacity improvements to existing roadways and/or intersections

Potential parking improvements

As ridership grows, parking demand increases. Sound Transit estimates up to 600 additional parking spaces will be needed to keep up with demand at Puyallup Station. Sound Transit is evaluating both surface and garage parking options.

See inside insert for specific locations of parking improvements under consideration.

Potential types of parking improvements

**Surface lot**

- One or more surface lots
- Leased and/or purchased
- \$6,500 per space to build

and/or

**Parking garage**

- Minimum size of 120 feet by 220 feet
- Up to 4-1/2 stories (parking on the roof of a 4-story building)
- \$30,000 per space to build

Evaluation results

Based on the project goals, the evaluation criteria below were used to help assess the effectiveness of proposed improvements in six different packages. All packages currently support Sound Transit regional commitments and build on the access improvements identified in the Sounder Stations Access and Demand Study.

Goal	Evaluation Criteria	Package A	Package B	Package C	Package D	Package E	Package F
		All Surface with Shaw Road B, WITH unfunded bus service + Red Lot	All Surface - Gold Lot, Red Lot, Eagles WITH unfunded bus service	Eagles Garage (no surface parking)	Transit Center Garage (no surface parking)	Transit Center Garage + Red Lot	Small Eagles Garage + Small Cornforth/Campbell Garage
Provide improved access to Sounder riders	Travel time and reliability						
	Comfort, security and convenience						
Benefit the local community*	Neighborhood compatibility: <ul style="list-style-type: none"><li>Traffic</li><li>Neighborhood parking</li><li>Community character</li></ul>						
	Supports City's plans for the station area						
Maintain a healthy environment	Property, historic, parks, and natural resources						
Support Sound Transit's regional commitments							
Cost	Cost (2014 dollars)	\$45 M	\$39 M	\$50 M	\$50 M	\$39 M	\$52 M

Lower performing

Higher performing

\*Results based on impacts/benefits to the station area

Moving Towards a Preferred Package

Based on input received over the last year from community stakeholders, a set of pedestrian, bike, bus/traffic and parking improvements have been developed to support the project goals.

What pedestrian, bike and bus/traffic improvements are being considered?

- All packages would include the following improvements:
- Pedestrian/bike bridge over railroad crossing at station

■ Station area traffic signal improvements

■ Station area intersection, sidewalk and lighting improvements for pedestrians

■ Bike route improvements on W Stewart Ave, W Main Ave, 7th Ave SW, 5th Street SW/4th Street NW

■ Added bike storage at station

■ Total investments: approximately \$11 M

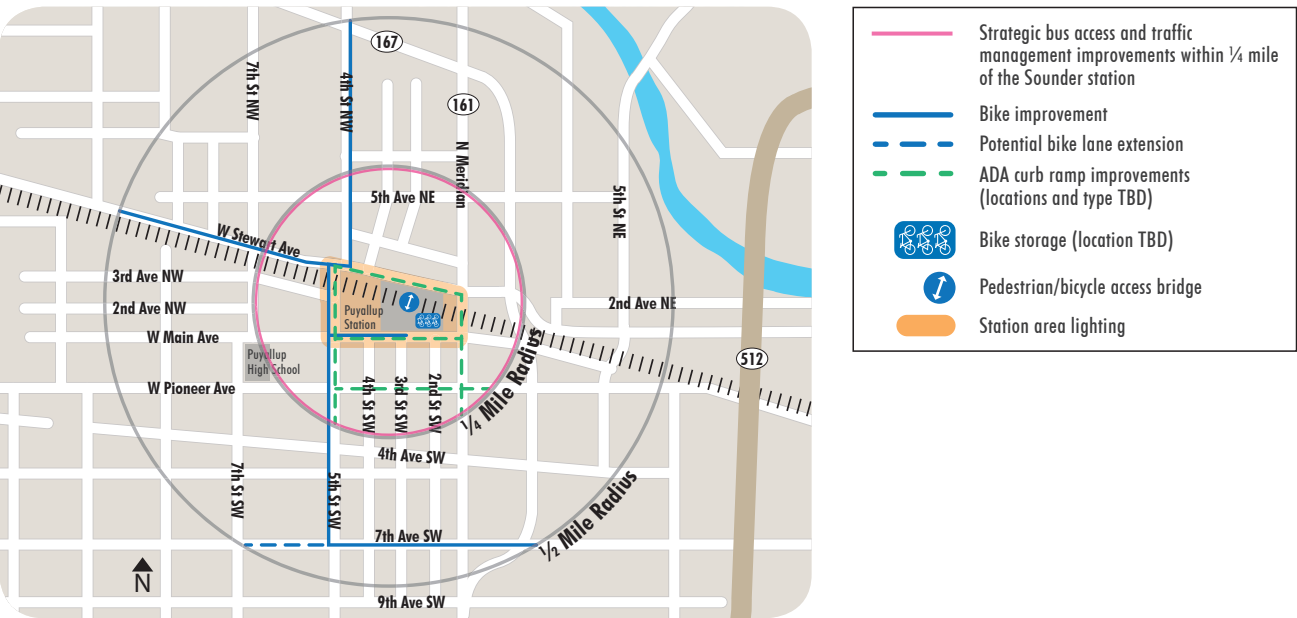

What parking options are being considered?

The six access improvement packages differ by parking type and location. Every package includes pedestrian, bike and bus/traffic management investments.

- Package A

  - Shaw Road surface lot: 400 spaces
  - Red lot lease expansion: Additional 200 spaces (no additional bus service)
  - New access street to Shaw Road lot
  - Bus service from Shaw Road lot (unfunded and service provider not identified)

Package D

  - Transit Center garage (4-1/2 stories): total 750 spaces
- Package B

  - Gold lot lease: 320 spaces
  - Red lot lease expansion: Additional 200 spaces (no additional bus service)
  - Eagles surface lot: Add 80 spaces for a total of 148 spaces
  - Bus shuttle from Gold lot (service provider not identified)
  - Pedestrian crossing improvements at 5th Street NW

Package E

  - Transit Center garage (4-1/2 stories): total 460 spaces
  - Red lot lease expansion: Additional 250 spaces (no additional bus service)
- Package C

  - Eagles garage (3-1/2 stories): 600 spaces
  - Additional pedestrian bridge across 5th Street NW

Package F

  - Cornforth/Campbell garage (3-1/2 stories): 300 spaces
  - Eagles garage (3-1/2 stories): 300 spaces
  - Additional pedestrian bridge across 5th Street NW



# What parking options are being considered?



**Package A** All Surface with Shaw Road B, WITH unfunded bus service + Red Lot

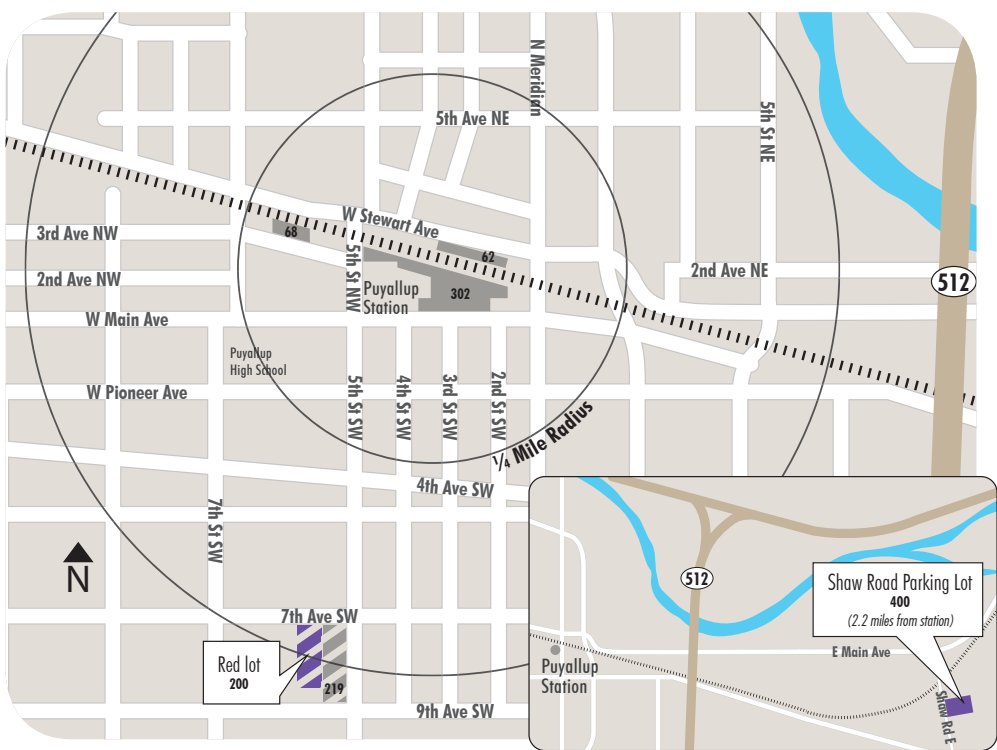

**Package B** All Surface - Gold Lot, Red Lot, Eagles WITH unfunded bus service

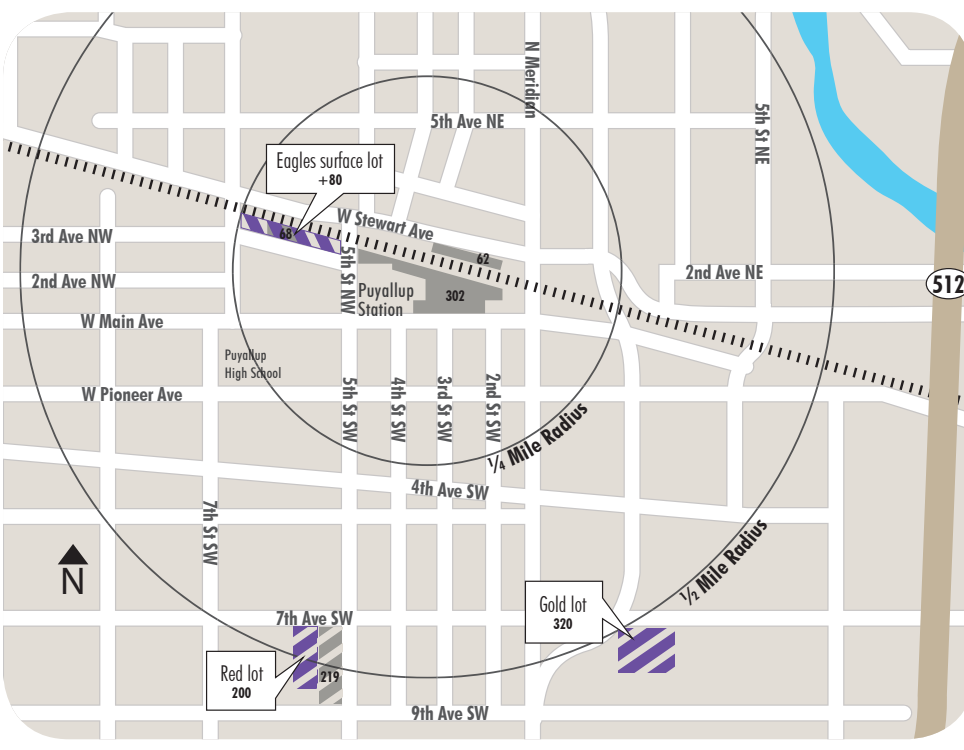

**Package C** Eagles Garage (no surface parking)

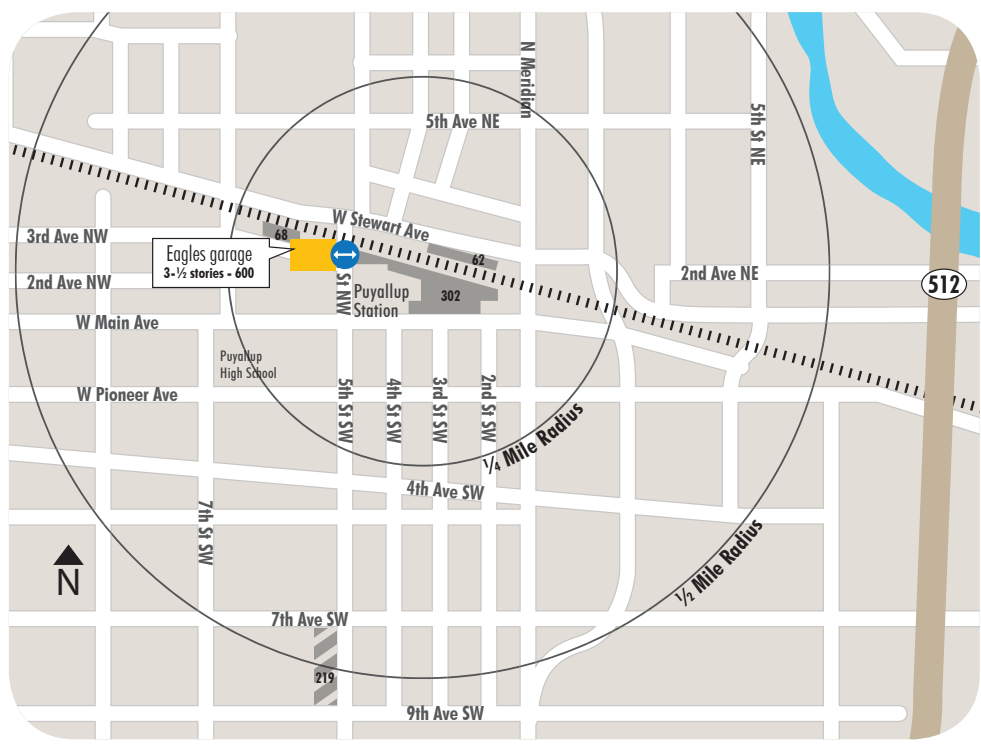

**Package D** Transit Center Garage (no surface parking)

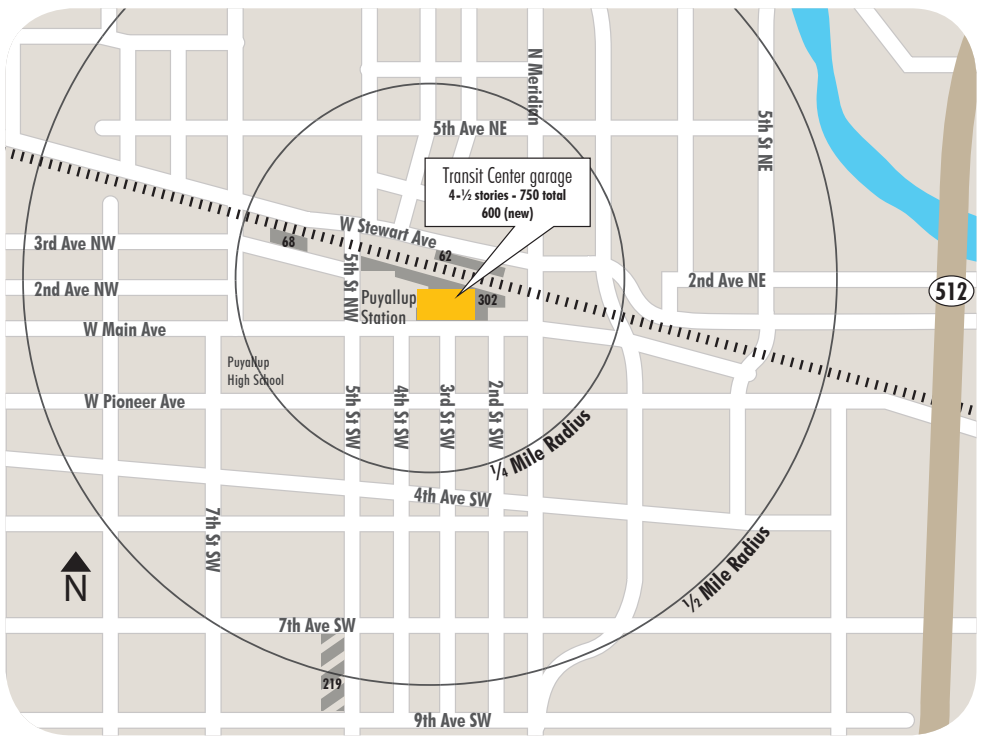

**Package E** Transit Center Garage + Red Lot

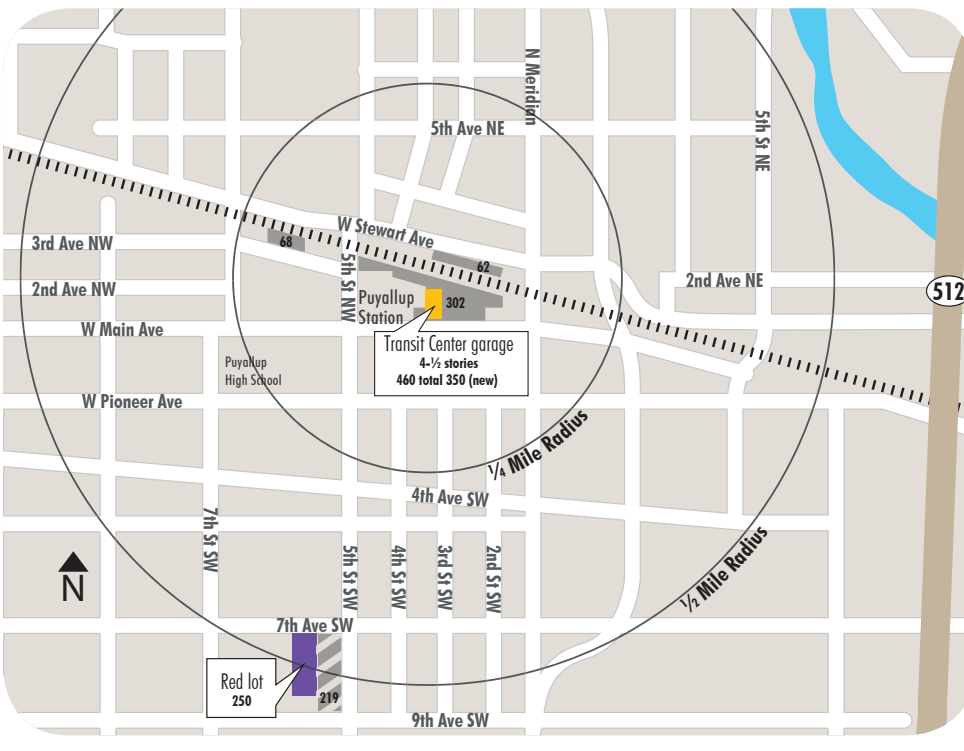

**Package F** Small Eagles Garage + Small Cornforth/Campbell Garage

