

Lynnwood Link Extension

Moving forward together

WELCOME
/BIENVENIDO
/ДОБРО ПОЖАЛОВАТЬ
/欢迎
/환영



OVERVIEW

The Lynnwood Link Extension is a key part of Sound Transit's mass transit system expansion approved by voters. Targeted for operation in 2024, four new stations and 8.5 miles of light rail will connect north Seattle, Shoreline, Mountlake Terrace and Lynnwood with the entire region.

Schedule



How long will my trip from Lynnwood take?

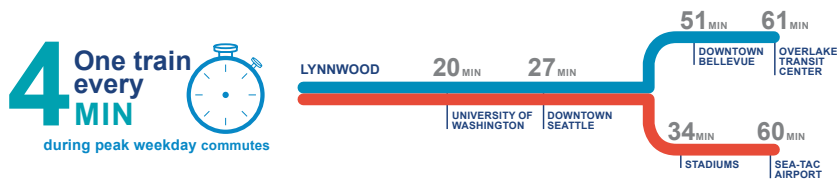

EACH LINK CAR CAN HOLD...

- 4 bicycles
- 4 wheelchairs
- 200 riders
- Multiple suitcases

Transit's sustainability helps ensure a tomorrow that is better than today

At Sound Transit, sustainability is about making long-term investments and choices that keep the region's environment, communities and economy healthy. The agency encourages sustainability by providing affordable, environmentally friendly travel options that connect people to where they live, work and play.



PROJECT AREA MAP

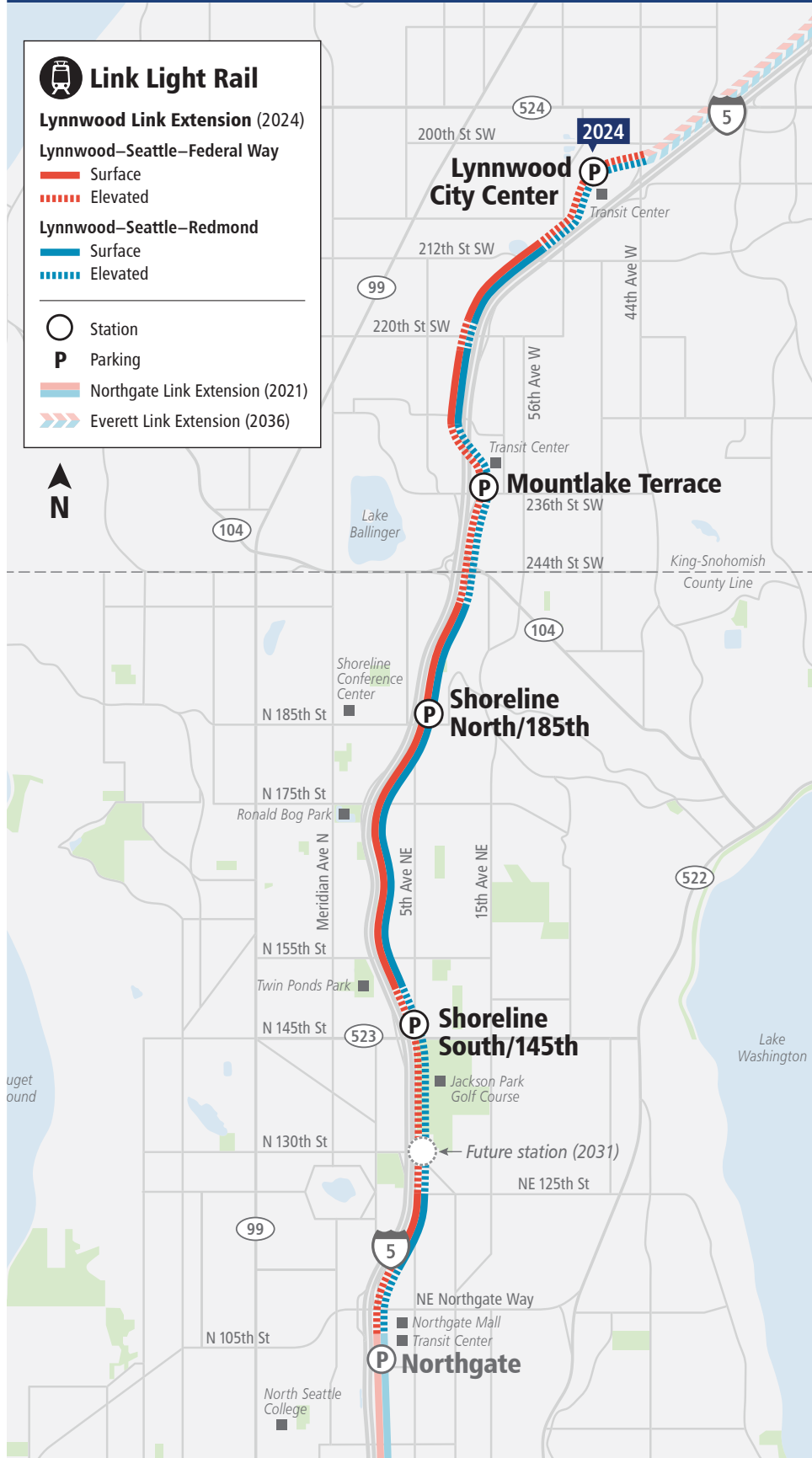

SYSTEM EXPANSION

Sound Transit system expansion is:

- Building a 116-mile network extending regional light rail from Tacoma to Everett, and from densely developed Seattle neighborhoods to Redmond and Issaquah, and extending Tacoma Link.
- Establishing Bus Rapid Transit to the north, east and south of Lake Washington.
- Expanding Sounder south line capacity and service, adding two new stations.
- Improving access and expanding parking at Sounder stations.



TREE REMOVAL AND REPLACEMENT

Starting in early 2019, Sound Transit will begin removing trees in areas where track, guideway or other transit infrastructure will be located in order to protect safe and uninterrupted light rail service. Trees could potentially fall onto tracks or disrupt power service.

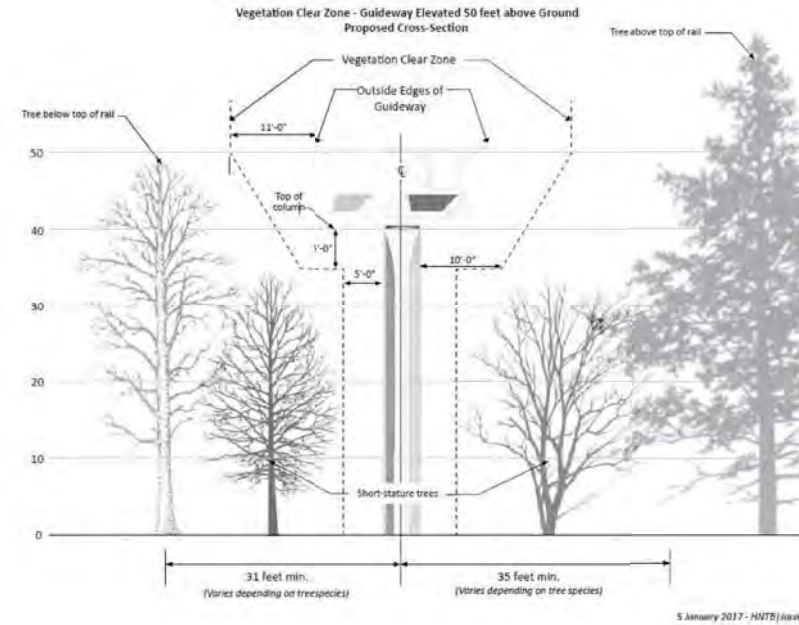

Sound Transit is committed to replacing trees removed during construction based on replacement requirements in each jurisdiction. Where feasible, agency crews will replant short trees under elevated guideways as depicted in the graphic above.

Crews will plant additional replacement trees around the project corridor. The table below shows the estimated number of trees slated for removal and the number the agency will plant as replacements.

Jurisdiction	Number of trees to be removed (est.)	Proposed plantings (est.)
Seattle	180	900
Shoreline	550	2,800
Mountlake Terrace	270	950
Lynnwood	350	1,200
WSDOT	3,950	14,550

MITIGATING NOISE

Construction of the guideway requires the removal of some existing Interstate-5 noise walls along the corridor; those will be replaced as needed. Crews will also place new walls along the guideway at select locations to mitigate noise from light rail operations and at stations to enhance the patron experience by mitigating noise from I-5.

Temporary Noise Walls

- Temporary removal of existing traffic noise walls during project construction will be required to make room for work activities and equipment mobilization.
- Crews will replace removed I-5 noise walls with new in-kind walls before the end of project construction.
- In the interim, the use of temporary noise barriers, where feasible, will provide partial traffic noise mitigation.
- Specifics regarding locations and duration of temporary noise barriers locations will be available after the development of a detailed construction plan.

Examples of Sound Curtains

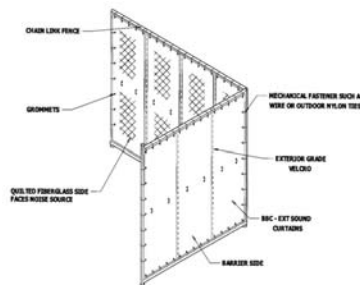

CONSTRUCTION



Summer 2018



Selective demolition work

Sound Transit has acquired several properties along the corridor. These properties are needed for construction and transit operation, and have been brought to Sound Transit's attention by their neighbors as potential areas of nuisance now that they are empty. Starting June 2018, we will begin demolishing existing structures and clearing debris.



Fieldwork

This spring, crews have been drilling in the project corridor to locate utilities and evaluate underground soil conditions for future systems that support light rail operation. This fieldwork is nearly complete and helps to pave the way for construction.

Early 2019



Third-party utility relocations

Private utility companies, such as electrical, cable and telecoms, will be moving their infrastructure in advance of construction work in the area. Contact your utility company if you have any questions about service interruptions and planned work.



Sound Transit-led utility relocation

Sound Transit will install and relocate utilities in order to remove infrastructure that may be in the way of upcoming construction, as well as better align service to the future guideway and stations.



Clearing and grading of vegetation

In advance of construction work, Sound Transit contractors will remove vegetation to allow space for construction work, equipment and materials staging, or access to construction areas.

Mid-2019



Active construction begins

In fall 2018, look for specific information about areas of work, construction sequencing and potential impacts. Major construction activities are scheduled to begin in mid-2019. At this time, crews will move large equipment into place, fence in work areas, create detours around active construction sites.

DISCOVER WHAT'S IN STORE FOR LYNNWOOD

A new light rail line means more than building trains and rails. It also means restoring or creating new pedestrian and bicycle connections, as well as other improvements throughout the corridor. Below are a sample of these improvements in this area.

LEED certification for Lynnwood City Center Station

Sound Transit registered the Lynnwood light rail station for LEED certification in March 2018. Registration is the first of many steps required for certification. Logging and reviewing of project information throughout design and construction may result in enough LEED points for a Silver rating.

Trail upgrades

Sound Transit will upgrade the Scriber Creek Trail to a multiuse path for bikes and pedestrians, and move it to a more upland location to help protect the trail from frequent flooding. We will also align the multiuse path to connect to the Interurban Trail at the ramp to the bridge over 44th Avenue West.

Lynnwood roadway improvements

As part of traffic mitigation in and around the Lynnwood City Center Station, the project will implement the following roadway improvements:

- New east-west 202nd Street
- Right in/right out from garage onto 44th Avenue West
- 46th Avenue West is no longer only for high-occupancy vehicles
- Widening of 200th Street Southwest, with improved intersections at 44th Avenue West, 46th Avenue West and 48th Avenue West
- Garage access road on 48th Avenue West extension around the south end of the site



LYNNWOOD STATION AERIAL VIEW



LYNNWOOD STATION SITE PLAN



LYNNWOOD STATION FLOORPLAN

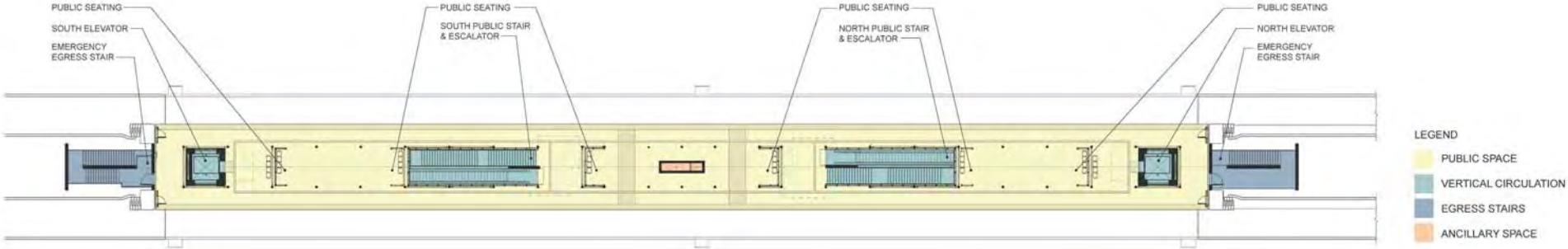

LYNNWOOD STATION



View of north lobby, pedestrian gathering area and art



View from southwest parking/paratransit drop off looking west

LYNNWOOD STATION



View looking northeast from existing I-5 HOV off-ramp



View of north lobby and pedestrian connection from parking garage

LYNNWOOD STATION



View of south lobby looking northeast



View of platform

PARKING GARAGE



View of parking garage looking east



View of parking garage looking south

PARKING GARAGE



View of parking garage vehicle entrance



Four samples of wall treatment for the parking garages

ROADWAY MODIFICATIONS

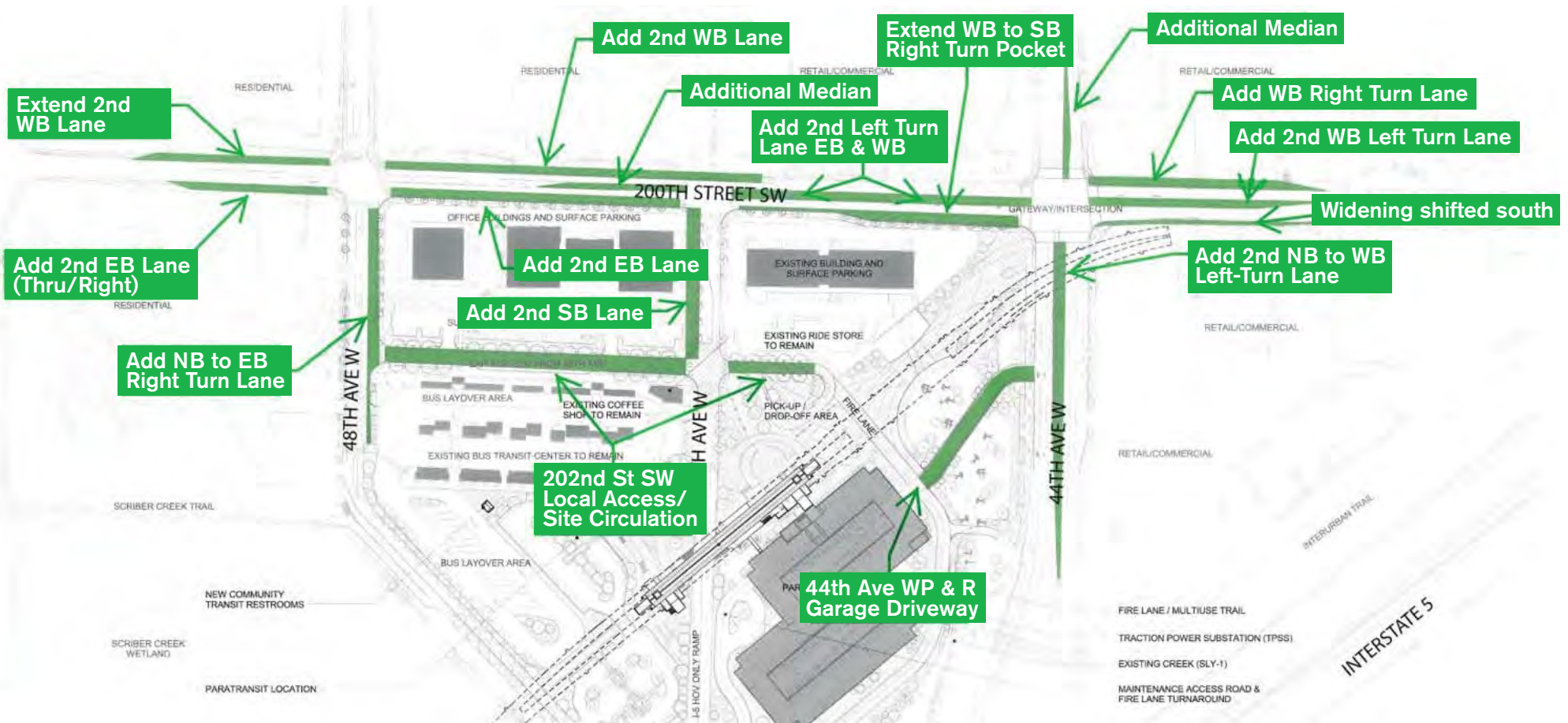

NORTH ENTRANCE ARTWORK

CLAUDIA FITCH, *CITY HUMMINGBIRD*

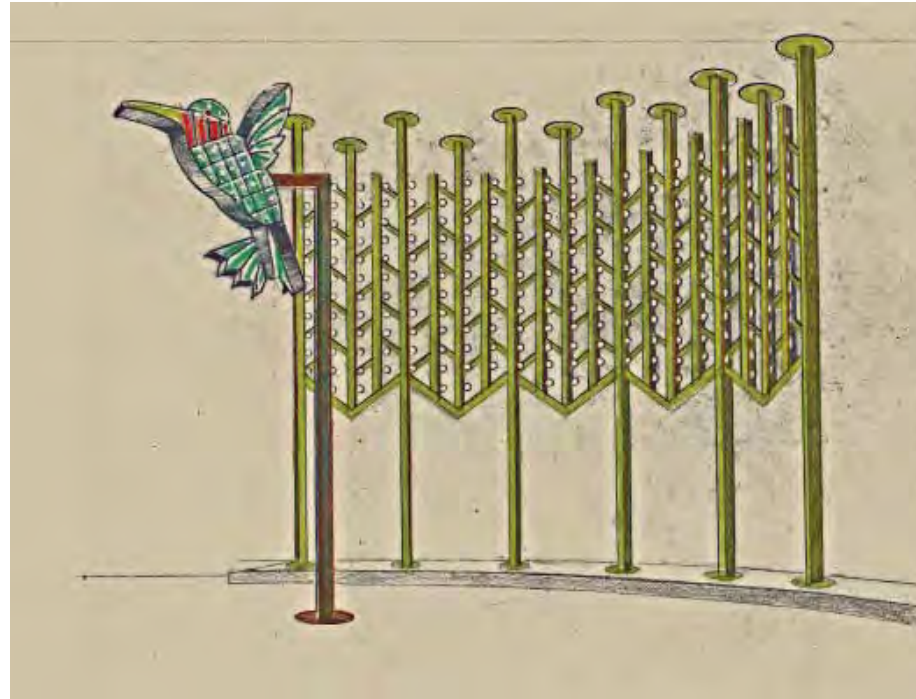

Artist Claudia Fitch describes her artwork for the Lynnwood Station, *City Hummingbird*, by writing “the sculpture will be a neon hummingbird, whose head is 30 feet in the air. On the western edge of the station plaza, I’m installing a curtain-like backdrop of richly patterned plant motifs, creating a grand station entry, animated with color and color and light.”

Fitch’s sculpture is intended to reflect both the natural and domestic qualities of Lynnwood and celebrates the rich history of neon signage that once lined SR 99.

City Hummingbird complements the pair of sculptures Fitch created for the existing Lynnwood Transit Center, titled *Shift*. Those sculptures are monumental forms reminiscent of table lamps during the era when Lynnwood was served by the Interurban trolley.

Claudia Fitch “creates art inspired by icons familiar in art history and the American vernacular, with the intention of linking a contemporary site with its over-arching cultural and social narratives.”



NORTH ENTRANCE ARTWORK

CLAUDIA FITCH, *SHIFT* (ARTWORK RELOCATION) AND TEMPORARY ARTWORK LIGHTBOX LOCATIONS

