



Lynnwood Link Extension

Shoreline & Seattle Open House

Presentation Overview

- Introductions
- Project description and schedule
- Construction preview
- Station design & updates
- Permits
- Open house guide



Current Service and Approved Projects

Near term Link extensions:

- University of Washington – Northgate (2021)
- Northgate – Lynnwood (2024)
- Downtown Seattle – Overlake (2023)
- Angle Lake – Federal Way (2024)
- Tacoma Theater District – S 19th

Additional extensions shown were passed in Sound Transit 3.





Lynnwood Link Extension

- 8.5 mile extension - Northgate to Lynnwood City Center
- 4 stations:
 - **Shoreline South/145th** – elevated
 - **Shoreline North/185th** – at grade
 - **Mountlake Terrace** – elevated
 - **Lynnwood City Center** – elevated

Project Schedule



Construction Preview

Summer 2018:

- Selective demolition
- Fieldwork

Construction anticipated in early 2019

- Early 2019
 - Utility relocations
 - Clearing and grading
- Mid-2019:
 - Active construction begins

Service begins 2024



[illegible]

Shoreline South/145th



Aerial View

Shoreline South/145th

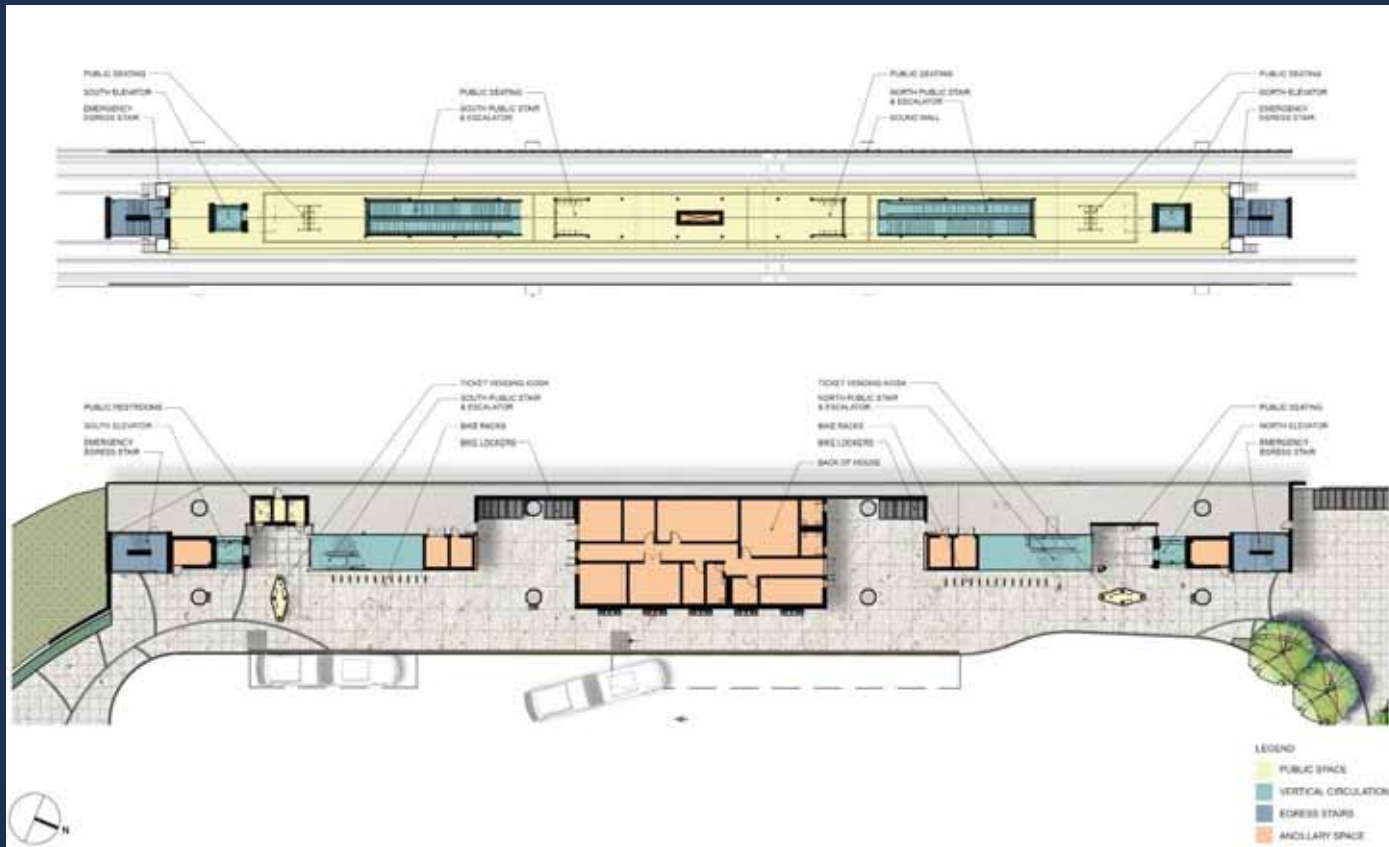

Floor Plan

Shoreline South/145th



View looking West from the South Pedestrian Plaza

Shoreline South/145th



North Entry View

Shoreline South/145th



South Entry View

Shoreline South/145th



Platform View

Shoreline South/145th



Parking garage

Station Artist: Buster Simpson

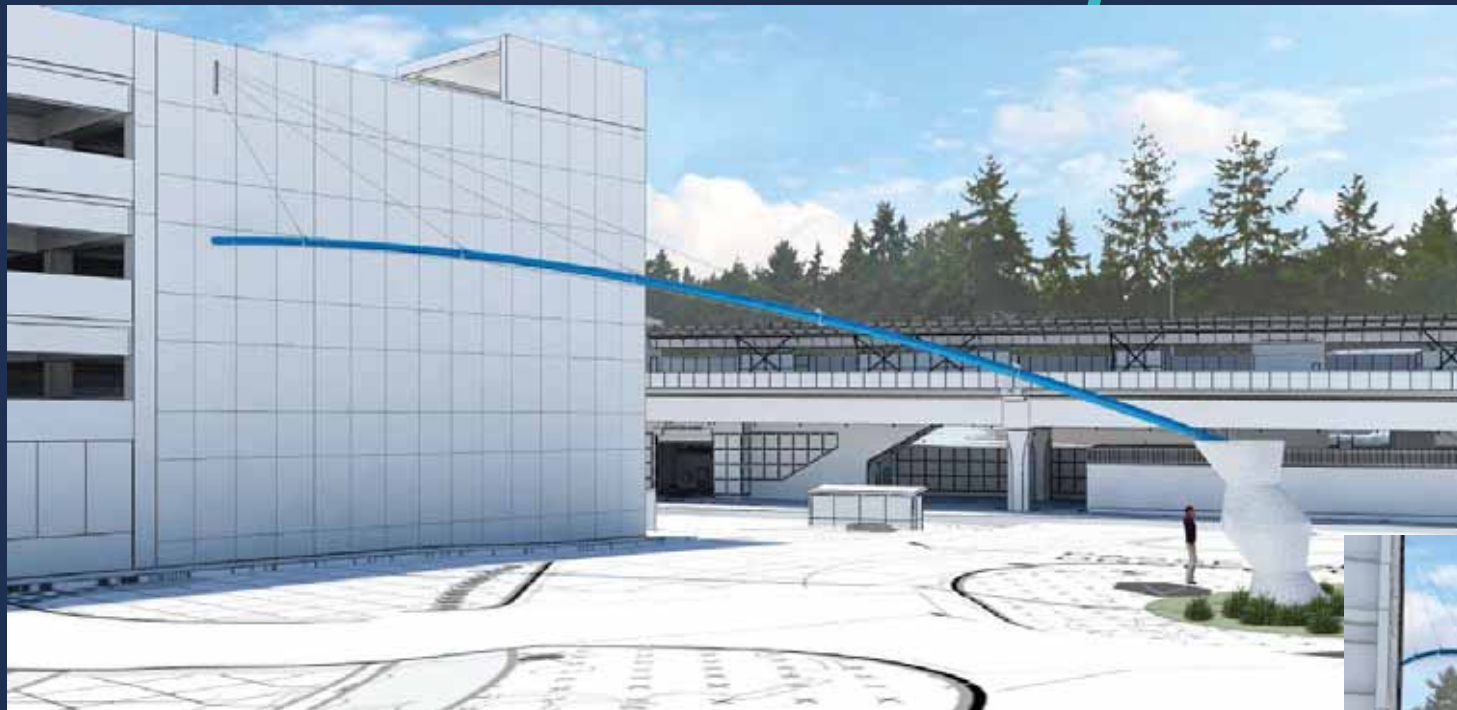

Shoreline North/185th



Vicinity Map and Site Plan

Shoreline North/185th



Aerial View

Shoreline North/185th

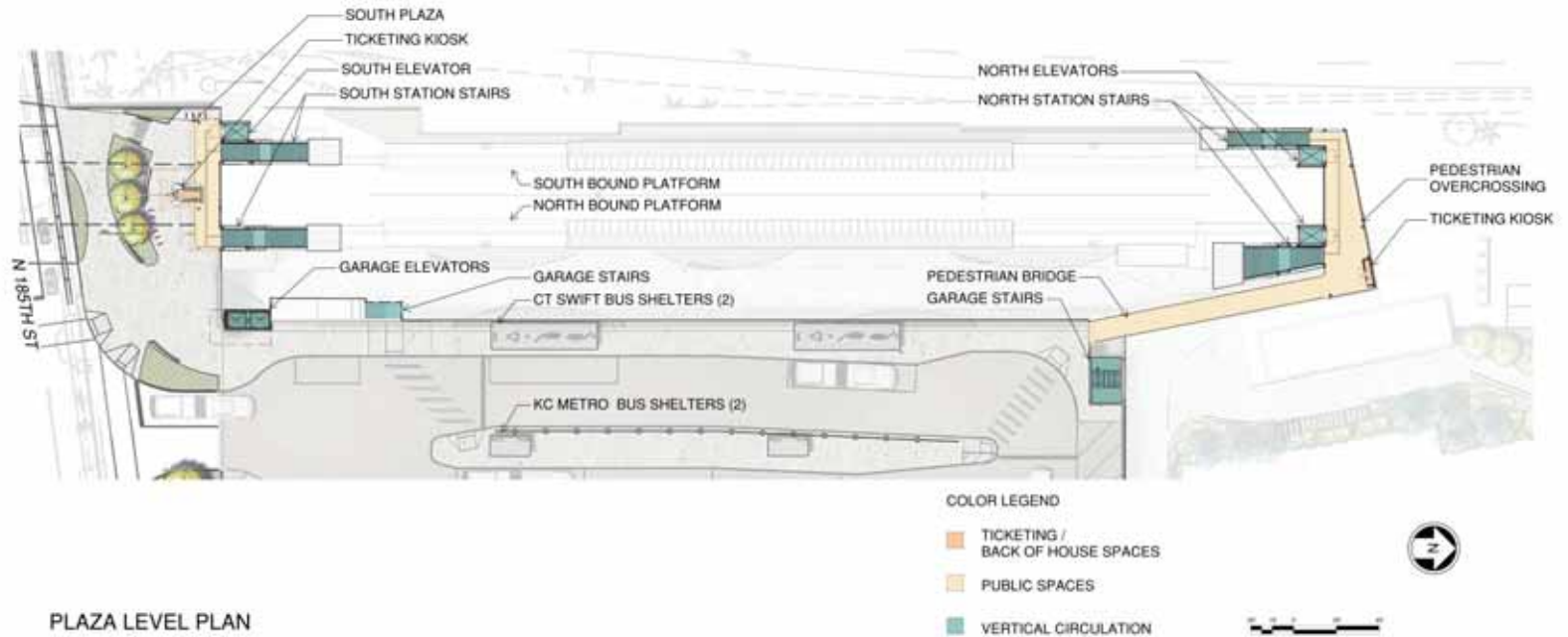

Plaza Level Plan

Shoreline North/185th

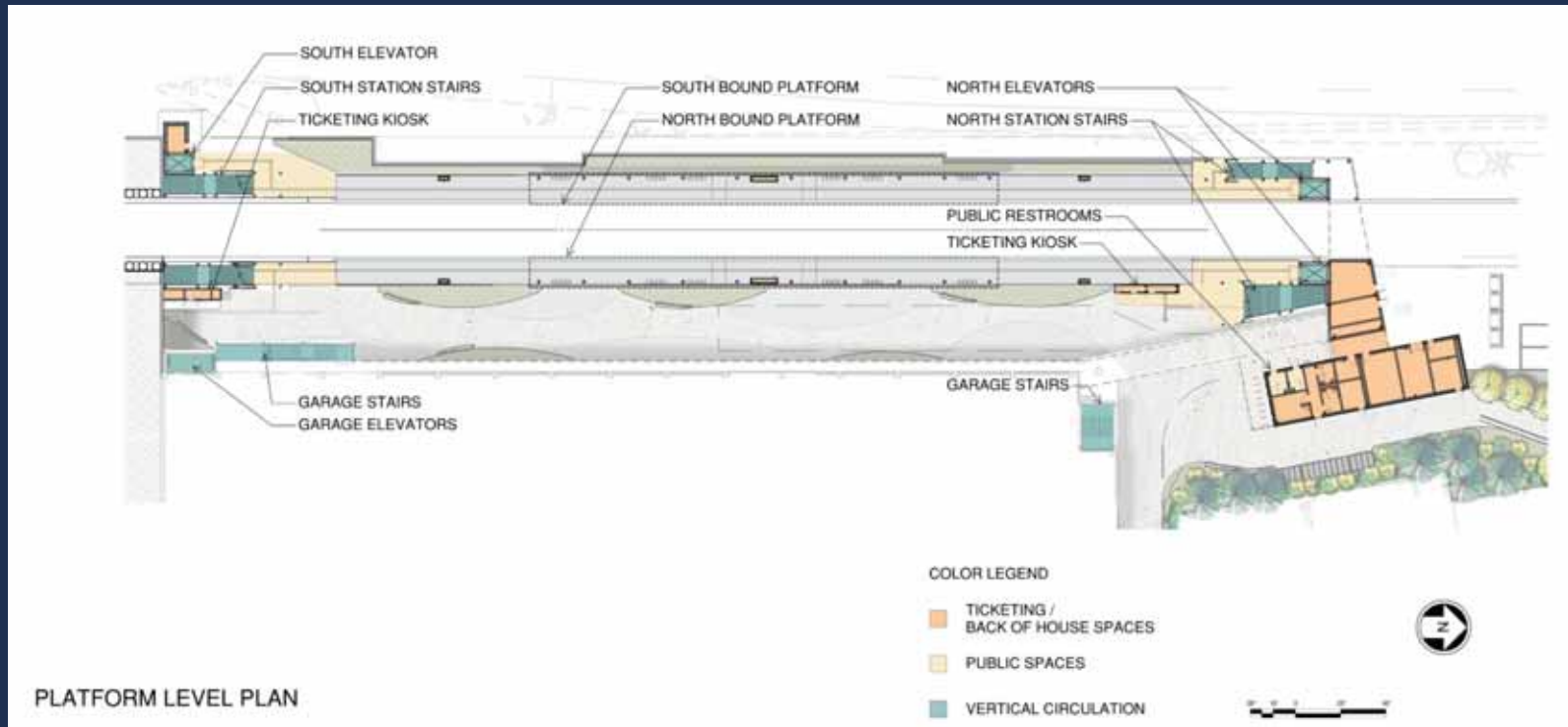

Platform Level Plan

Shoreline North/185th



South Entry View

Shoreline North/185th



North Entry View

Shoreline North/185th



Pedestrian bridge

Shoreline North/185th



Platform View

Station Artist: Mary Lucking



Also tonight: Part of City of Shoreline Special Use Permit application

Intent of Permit:

- Tonight's meeting satisfies requirement for application to City of Shoreline
- Permit will place conditions on project to ensure compatibility with adjacent land uses
- SUP addresses critical areas and administrative code modifications required for the project

Process:

- Formal application submittal August 2018
- 21-day Public Comment Period starts with City's Notice of Application
- Final decision is made by the City's Hearing Examiner

Critical areas

Wetlands, Streams, and Buffers

- Most wetlands between NE 151st St to NE 155th St
- Filling 0.35 ac of wetlands and 0.68 ac of buffers
 - Mitigating at Ronald Bog Park
- Vegetation impacts to McAleer Creek buffer to be restored on-site in I-5/SR 104 Interchange loop

Critical areas (continued)

Landslide Hazard Areas

- Very high-risk landslide areas as defined by City
 - North and south of Ridgcrest Park – NE 159th to NE 172nd
 - North of North City Elementary – NE 189th to NE 205th St
- Removing vegetation and excavating cut/fill slopes
- Design strategies include tiebacks and retaining walls

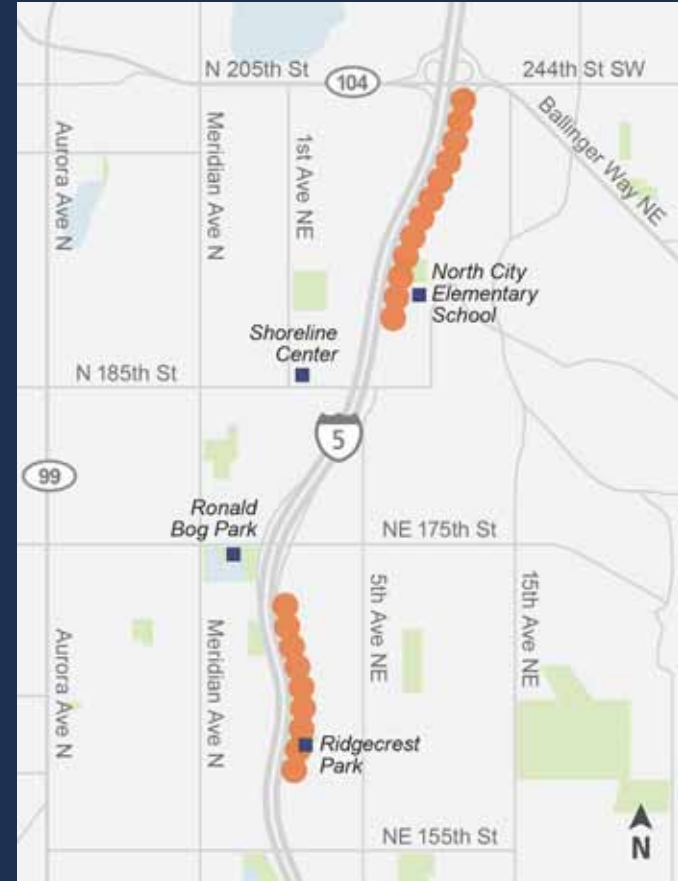

List of other anticipated permits

- Critical Area Special Use Permits for Ronald Bog Mitigation Site and McAleer Creek
- Building Permits
- Demolition Permits
- Site Development Permits
- Right-of-Way Use Permits
- Floodplain Development Permits

Comments and information

- Comment sheets and sticky notes
- Comments and Sound Transit's responses documented in a Neighborhood Meeting Summary
- Sign up to receive more information on the SUP
- Contact for City of Shoreline:

Jennifer Wells

City of Shoreline - ST Senior Planner

Phone: (206) 801-2528

Email: jwells@shorelinewa.gov

Open House guide



Lynnwood Open House: 7/25/2018
Lynnwood Convention Center

Online Open House:
LynnwoodLink.Participate.Online



Thanks!
soundtransit.org/LLE

